

# VMC Parks and Wayfinding Master Plan Refined Scenario

VMC Sub-Committee  
June 8, 2021

# Master Plan Goals

1

ASSESS THE PARKS AND OPEN SPACE PROPOSED FOR THE VMC.

2

IDENTIFY PUBLIC REALM STRATEGIES THAT RESPOND TO THE INCREASED DENSITY IN THE VMC.

3

DEFINE THE CHARACTER, PROGRAM, AND DESIGN OF THE PARKS AND OPEN SPACE PROPOSED FOR THE VMC.

4

CREATE A PHASING AND IMPLEMENTATION PLAN FOR THE PARKS AND OPEN SPACE PROPOSED FOR THE VMC.

# Master Plan Study Area



# Master Plan Process

WE ARE  
HERE

## 1 ASSESSMENT

JUNE '20-NOV '20

### TASKS

Parkland Provision Analysis & Benchmarking  
Facilities Provision Analysis  
Current Parks Qualitative Analysis  
5km Parks Inventory  
Tree Canopy Analysis

### CONSULTATION

Online Survey  
VMC Subcommittee

### DELIVERABLE

Assessment Report

## 2 PLANNING

NOV '20-JUNE '21

### TASKS

Design Strategies  
Additional Parkland Options  
Parks & Open Space Planning  
Circulation Planning

### CONSULTATION

Focus Groups

VMC Subcommittee

DRP

### DELIVERABLE

Draft Master Plan

## 3 IMPLEMENTATION

JUNE '21-NOV '21

### TASKS

Final Master Plan  
Design Recommendations  
Phasing  
Costing

### CONSULTATION

Online Comment Period  
VMC Subcommittee

### DELIVERABLE

Final Master Plan and Implementation Report





# VMC VIRTUAL FOCUS GROUPS

MAY 6, 2021

## Consultation

### Assessment Phase

- Online Survey
- Stakeholder meetings

### Master Plan Phase

- Online Focus Groups
- Design Review Panel

### Implementation

- Online Comment Period

## Assessment Phase

1

DEVELOPMENT TRENDS SUGGEST THE VMC WILL BECOME ONE OF THE MOST DENSE AREAS IN NORTH AMERICA.

2

IT IS CRITICAL TO PROVIDE ADDITIONAL PARKLAND IN OR NEAR THE VMC.

3

PROVIDING REQUIRED RECREATIONAL FACILITIES DEMANDS CAREFUL PLANNING.

4

CONNECTING THE VMC TO OPEN SPACE SOUTH OF HIGHWAY 407 IS IMPORTANT.

5

DEVELOPMENT OF PARKS AND OPEN SPACES MUST CONTINUE TO REFLECT PLANNING GOALS.



# Design Strategies

## 1 PARK PROVISION

- PROVIDE MORE PARKLAND
- PRIORITIZE AREAS ADJACENT TO BLACK CREEK AND ENVIRONMENTAL OPEN SPACE
- SCHEDULE PARKS WITH DEVELOPMENT

## 2 PARK CHARACTER

- EMPHASIZE NATURAL FEATURES
- MAKE URBAN PARKS SPECIAL
- MAKE NEIGHBOURHOOD PARKS CONVENIENT AND USEFUL

## 3 FACILITIES

- REFLECT URBAN CHARACTER OF VMC
- HIERARCHY OF FREQUENCY AND IMPORTANCE OF USE
- COORDINATE DESIGN OF PARKS AND SCHOOL YARDS
- PRIORITIZE FLEXIBLE, NATURAL SPACE

## 4 OTHER OPEN SPACES

- PROVIDE MORE ENVIRONMENTAL OPEN SPACE
- USE POPS, MEWS AND FLEX STREETS TO SUPPLEMENT PARKS

## 5 CONNECTIVITY

- OPTIMIZE PARK USE THROUGH CONNECTIVITY
- EXPAND “THE LOOP” CONCEPT FROM EARLIER PLANNING DOCUMENTS
- USE PARKS AND OPEN SPACES TO ENHANCE PEDESTRIAN AND CYCLING CONNECTIVITY
- ENSURE ROADS ARE NOT BARRIERS
- CONNECT ACROSS HIGHWAY 407

# Master Plan

The Master Plan encompasses several types of public open space:

## 1 PARKS

Land that allows for the full range of typical park uses.

## 2 ENVIRONMENTAL OPEN SPACE

Land used for environmental purposes, especially stormwater management, that can also support trails and passive recreation.

## 3 PUBLIC SQUARES

Plazas or promenades that are predominantly paved for urban uses.

## 4 POPS & MEWS

Privately-owned and maintained land open to the public that supplements parks and squares.

## 5 SCHOOL YARDS

Land owned by school boards that may contain facilities available for public use.





# Urban Parks



North Urban Park - Concept Looking West



South Urban Park - Concept Showing East Block



# Urban Parks - North Urban Park

Design by Claude Cormier Associates

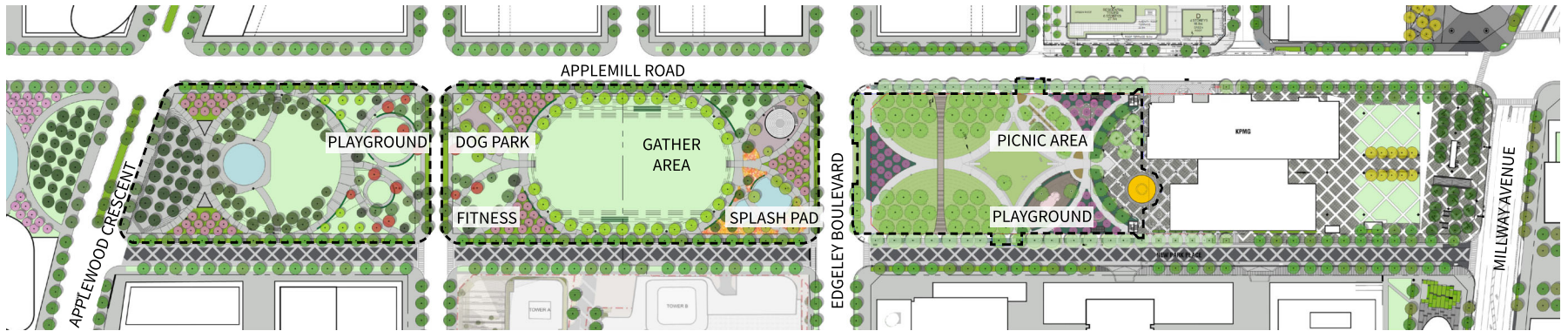



# Urban Parks - South Urban Park

Concept by City of Vaughan

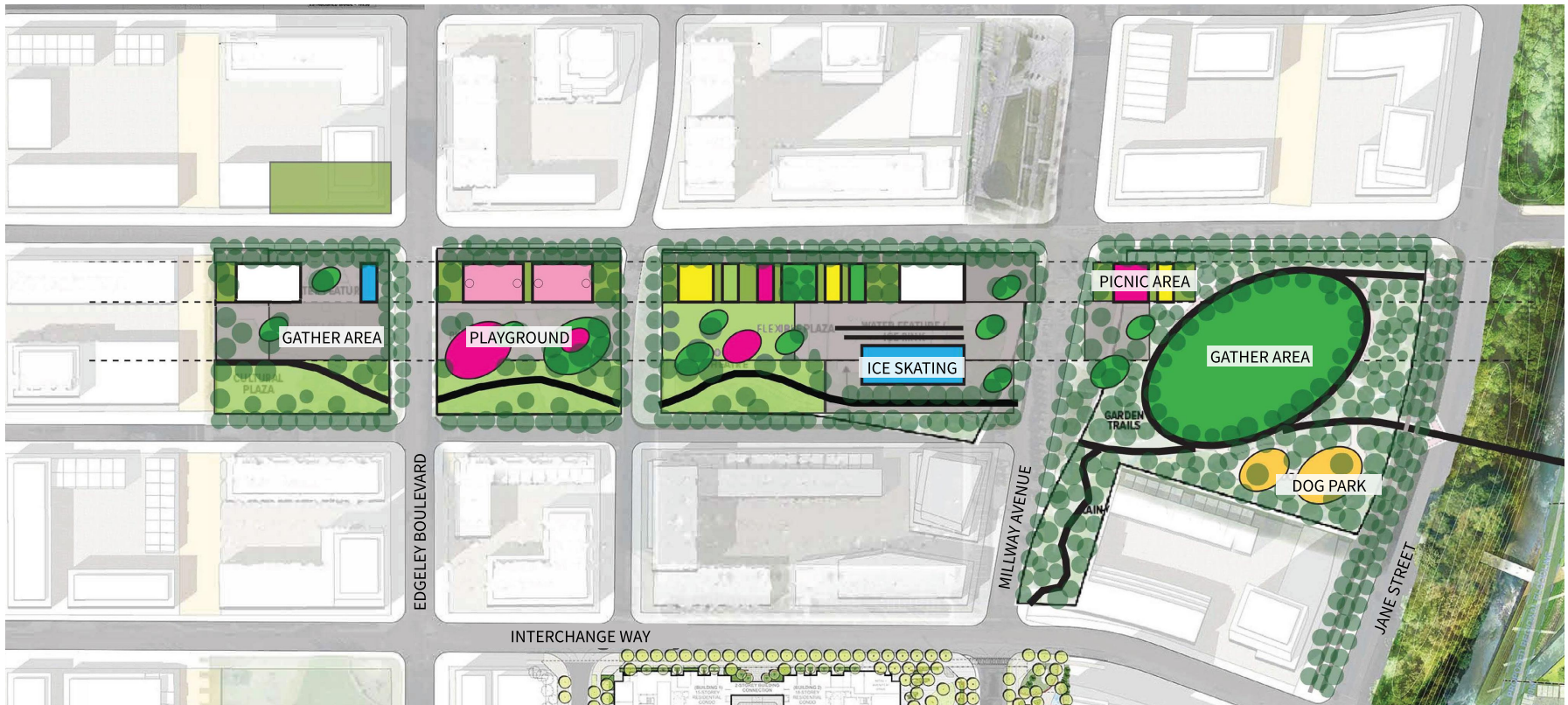

# Urban Parks - What Did We Ask?

?

How should the program of South Urban Park differ from North Urban Park?

1. More spaces designed for markets, arts and cultural events.
2. More urban sports facilities (basketball, volleyball, skate park, adult exercise).
3. Not different - I like the emphasis on leisure and flexible park spaces in North Urban Park.





## Urban Parks - What Did We Hear?

How should the program of South Urban Park differ from North Urban Park?

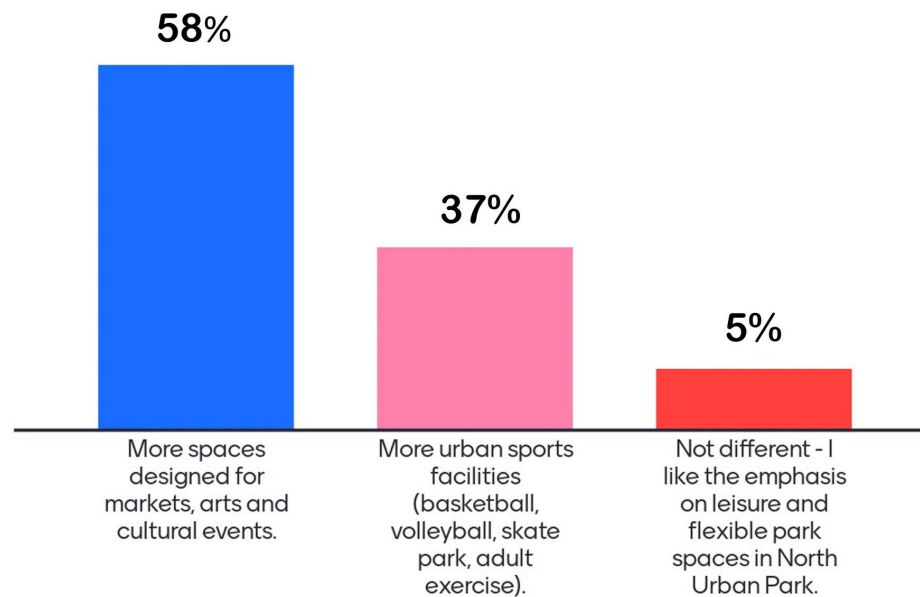

# Neighbourhood Parks

- Neighbourhood Parks typically provide:
  - Facilities: playgrounds, splash pads, sports fields and courts, dog runs, gathering and event areas, community gardens.
  - Green Features: lawns, trees, and naturalized areas.
- Required facilities in VMC may exceed available space in Neighbourhood Parks, requiring prioritization between facilities and green features.



# Neighbourhood Parks - What Did We Ask?

?

What would you prioritize in Neighbourhood Parks:

1. Maximize Facilities
2. Maximize Green Features

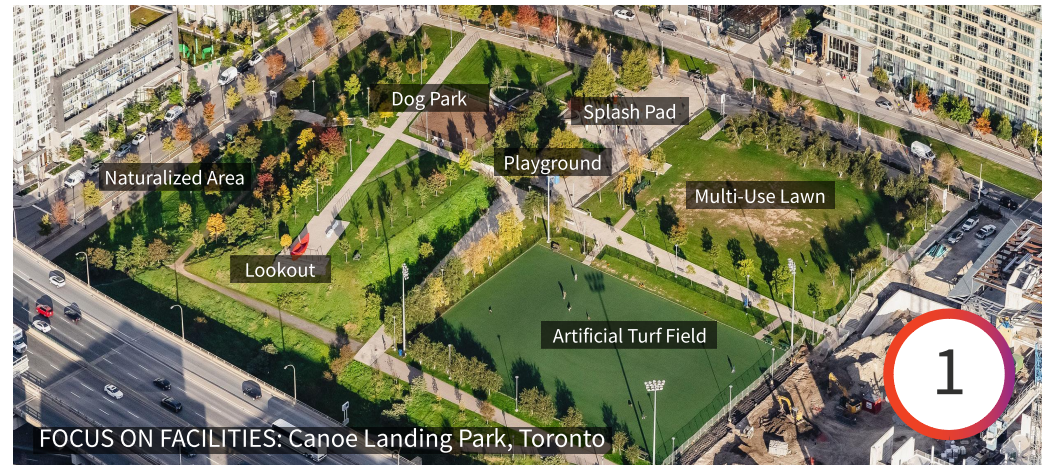

## Neighbourhood Parks - What Did We Hear?

What would you prioritize in neighbourhood parks?

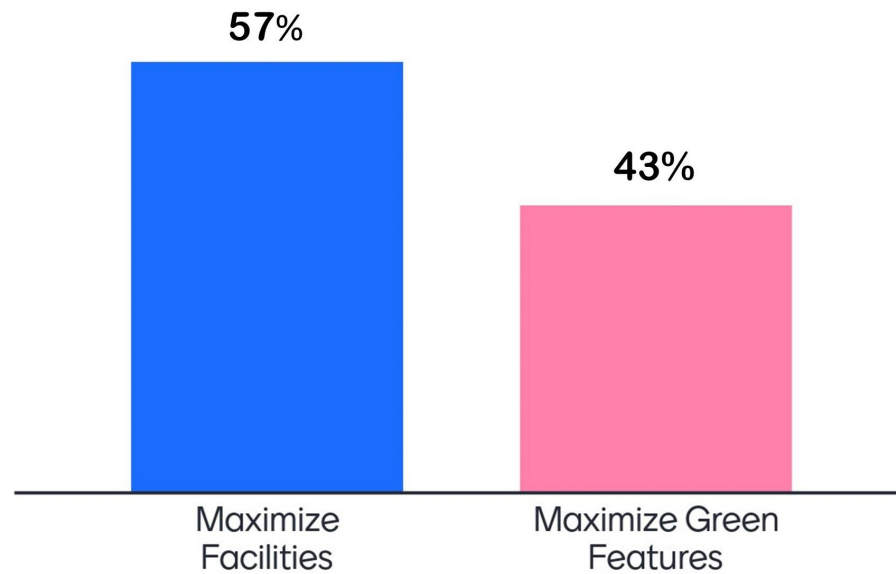



# Parks South of VMC

- Lands south of VMC could provide enough active parkland to locate several large sports and recreation facilities.
- Some of the lands south of VMC may become unavailable if a bus rapid transit project, planned for beyond 2040, moves forward.
- Park design in Black Creek Pioneer Village North Lands based on meetings with TRCA.

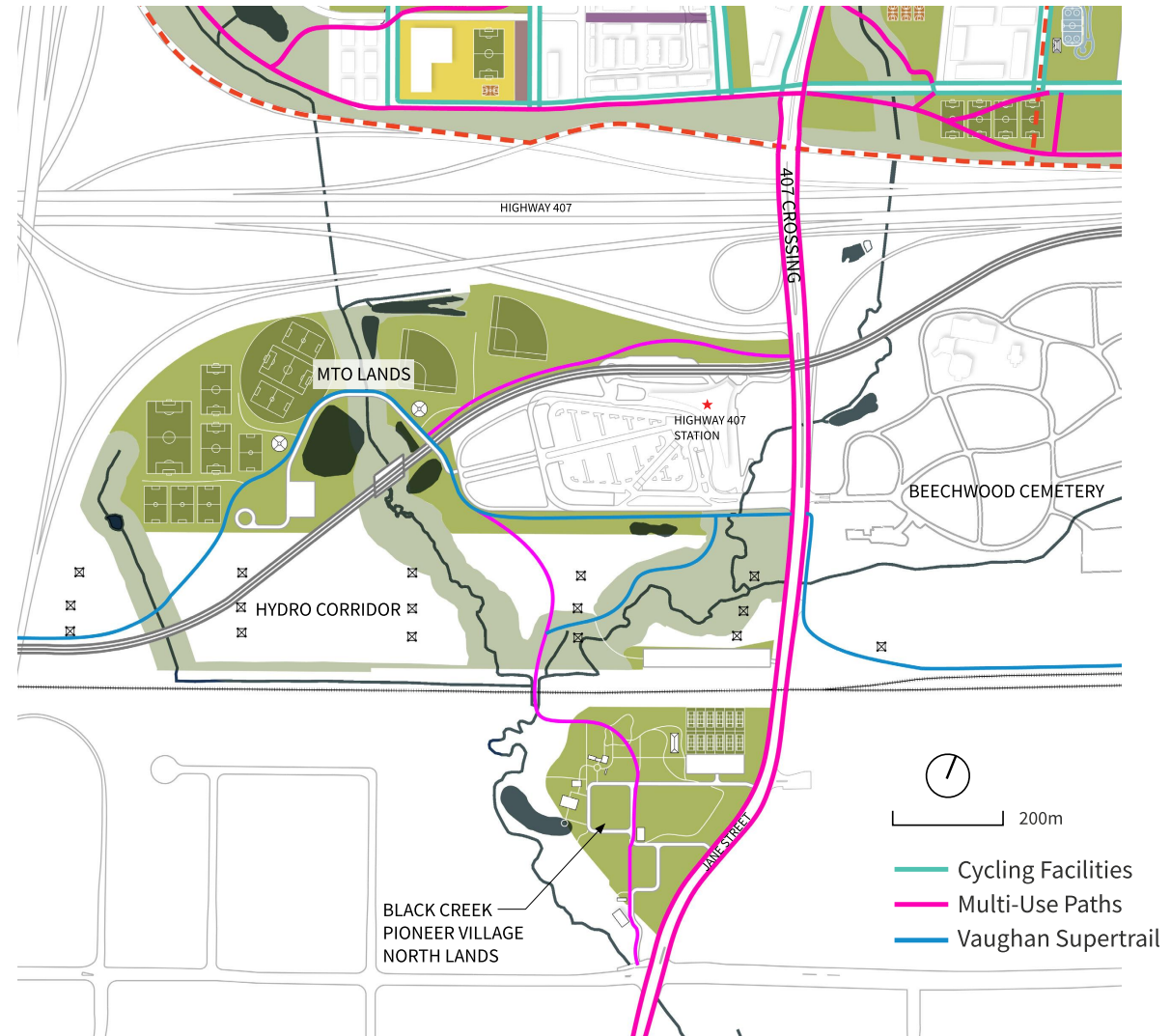

# Parks North of VMC

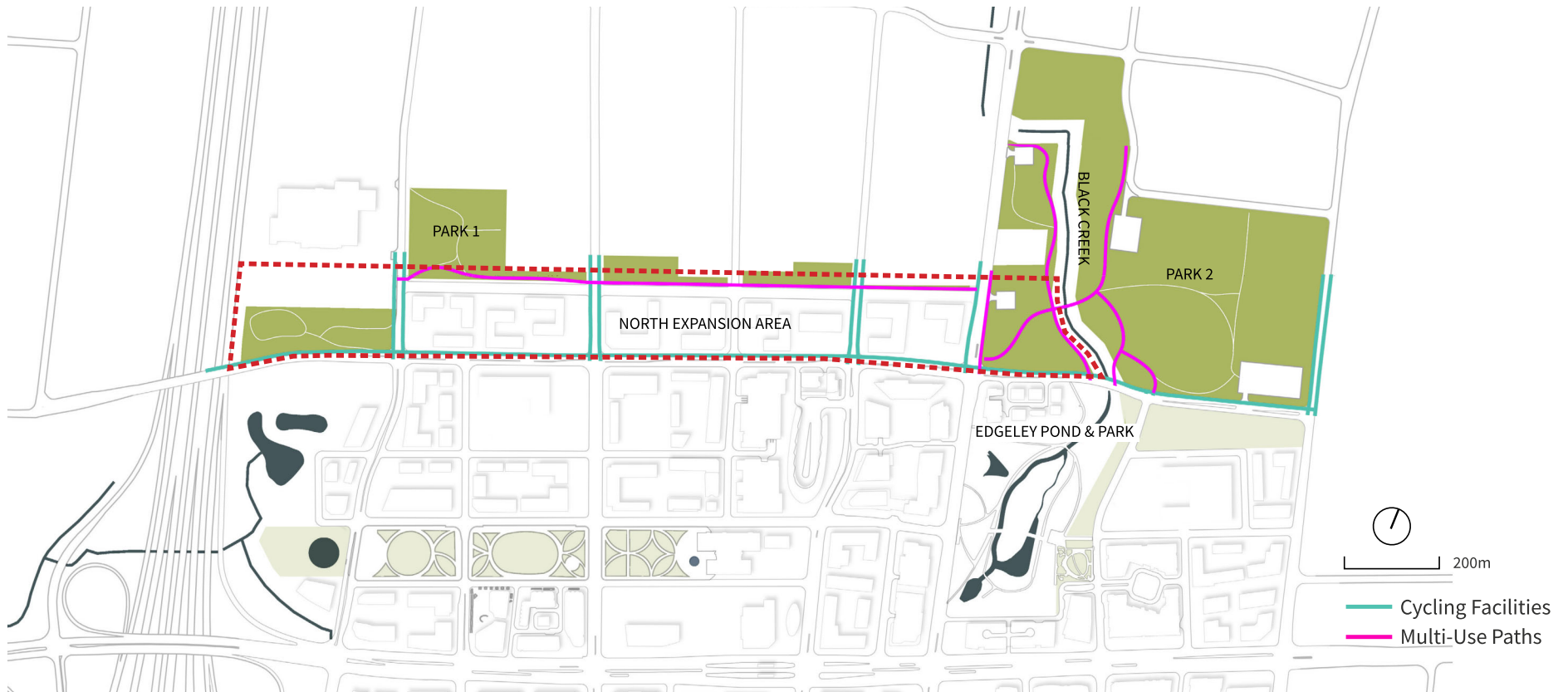

# Parks Near VMC - What Did We Ask?

?

A southern park is likely to have greater space and more facilities but be more difficult to travel to by walking or cycling.

A northern park is likely to have less space and fewer facilities but be easier to travel to by walking or cycling.

In establishing parks nearby the VMC, would you prioritize:

1. Size of park and number of facilities?
2. Convenient access by walking or cycling?



## Parks Near VMC - What Did We Hear?

In establishing parks nearby the VMC, what would you prioritize?

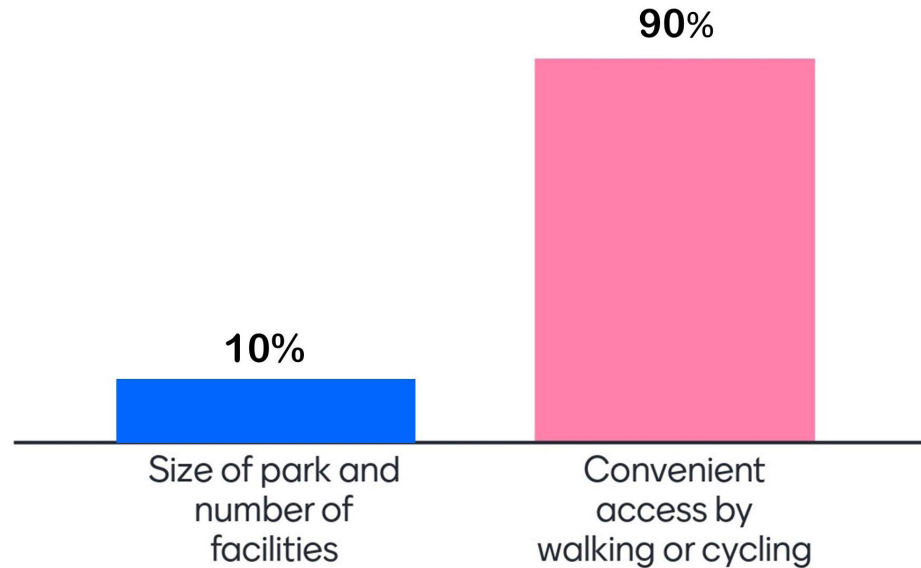



# Environmental Open Space - Black Creek East



Edgeley Pond and Park



Black Creek Revitalization Area - Concept

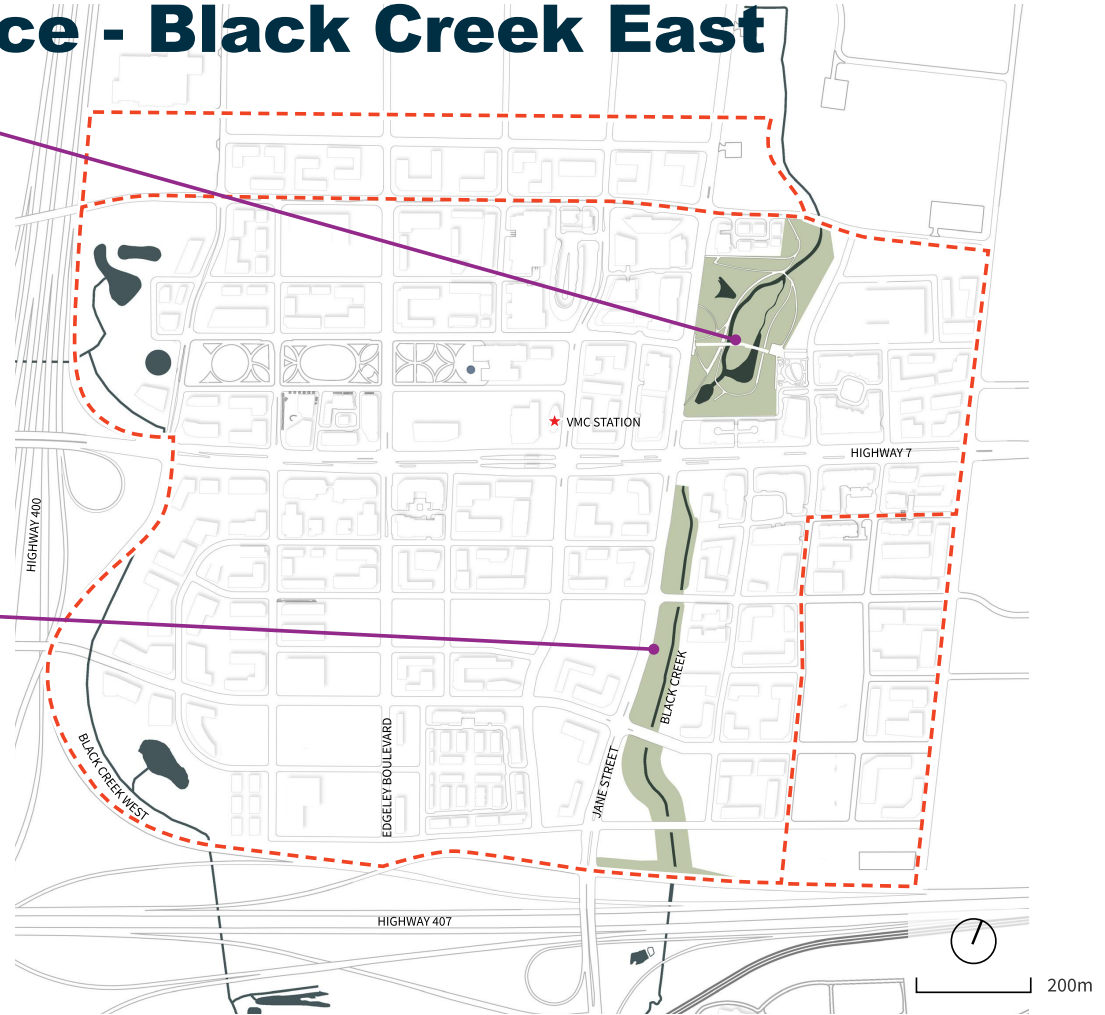

# Environmental Open Space - Black Creek West



Northwest Environmental Open Space



Southwest Environmental Open Space

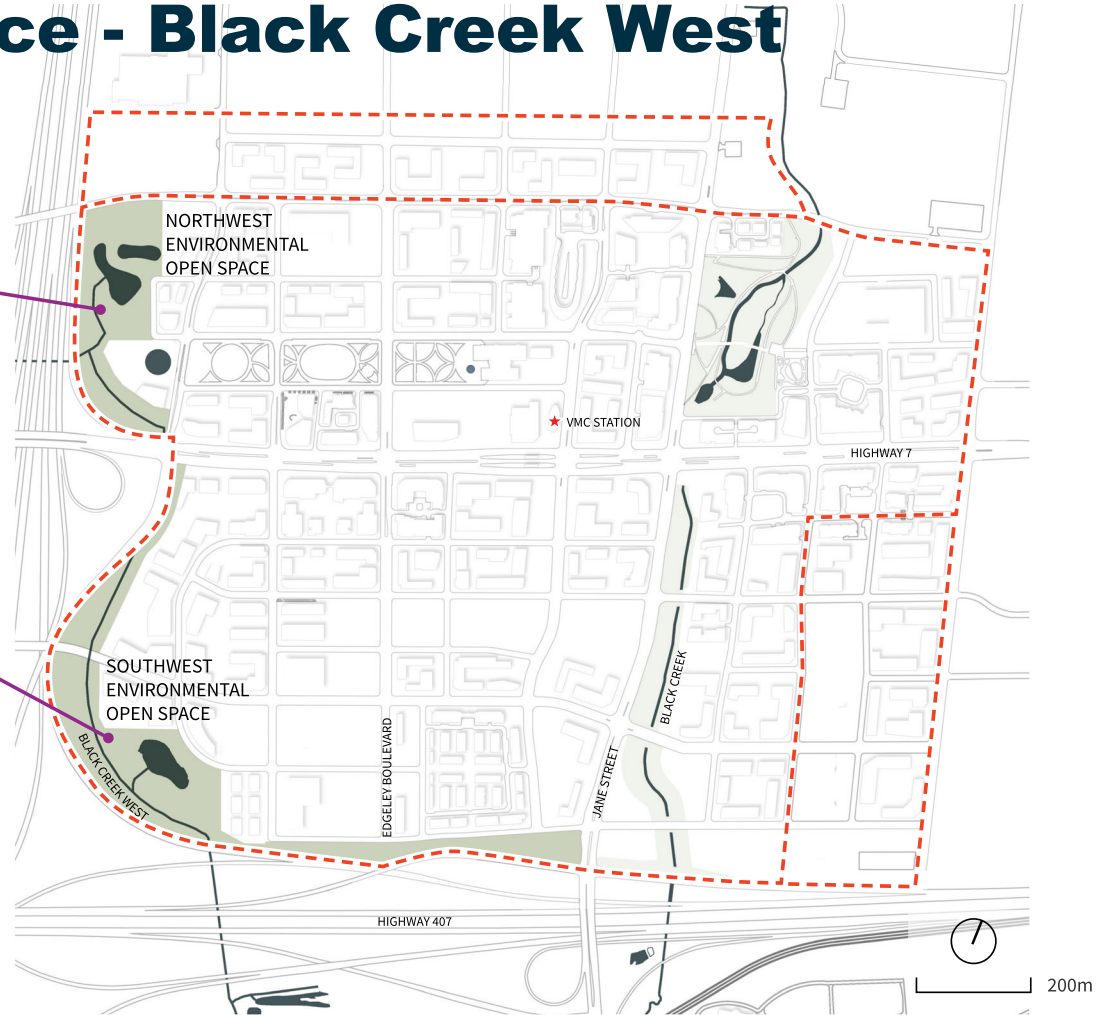



# Public Squares & Promenades

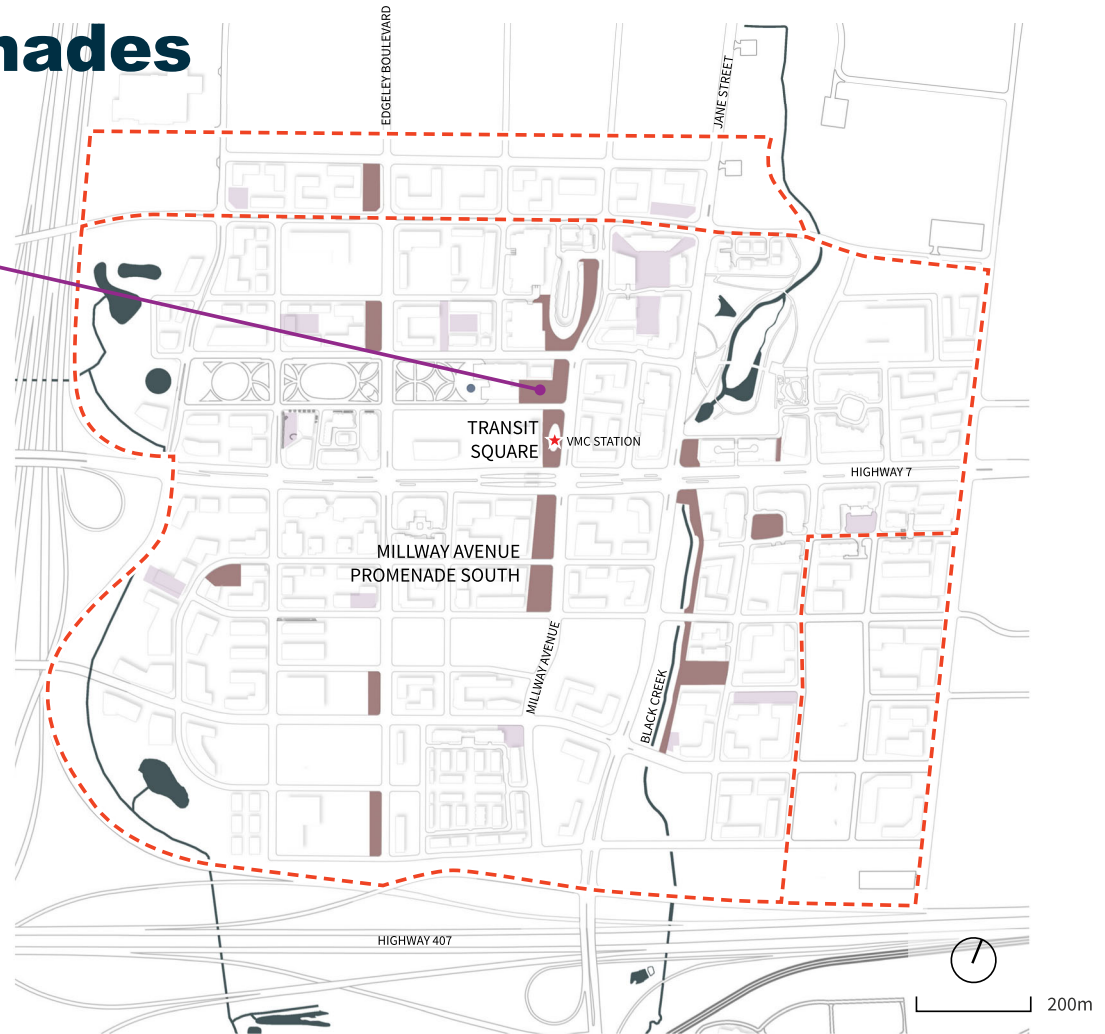
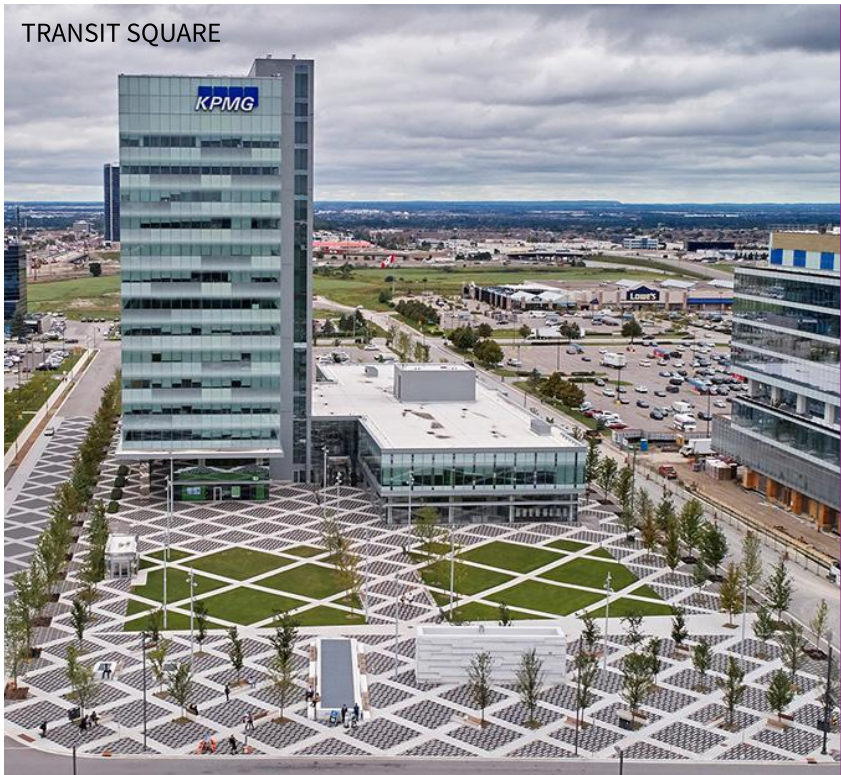

# Millway Promenade





# Public Squares & Promenades - What Did We Ask?

?

South of Highway 7, would you prefer to see Millway Promenade designed as:

1. An urban promenade, like the original concept.
2. A linear green park.

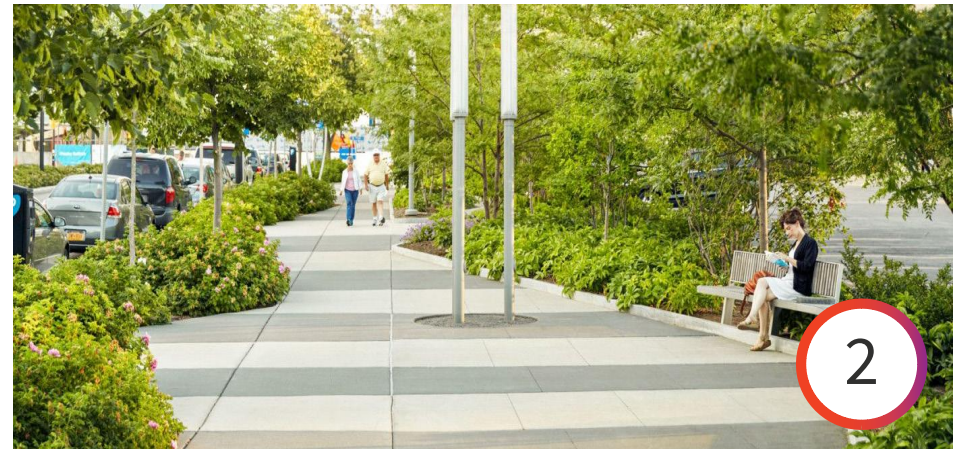

## Public Squares & Promenades - What Did We Hear?

South of Highway 7, how would you prefer Millway to be designed?

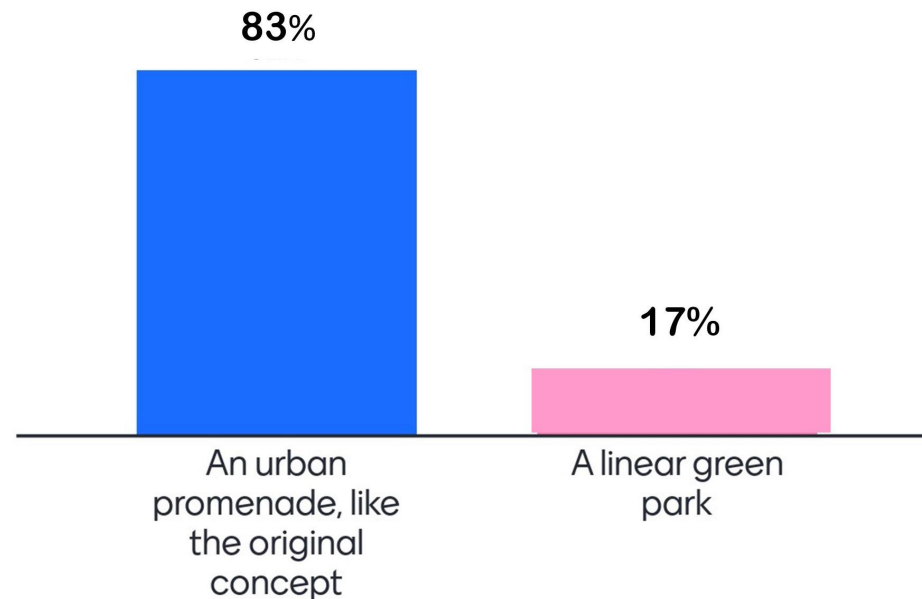

# POPS and Mews





# School Yards





# Facilities - Location

- Picnic Pavilion
- BBQ Picnic Area
- Allotment Garden
- Agricultural Demonstration Garden
- Playground
- Natural Playground
- Splash Pad
- Gathering Area
- Outdoor classroom/amphitheatre
- Skating Trail
- Outdoor Swimming
- Tennis
- Volleyball
- Basketball
- Fitness Equipment
- Dog Park
- Baseball Diamond
- Soccer Pitch
- Cricket Pitch
- Hockey/Skating Rink
- Skateboard Park



# Facilities - Location

- Permit Pavilion
- BBQ Picnic Area
- Allotment Garden
- Agricultural Demonstration Garden



# Facilities - Location

- Playground
- Natural Playground
- Splash Pad





# Facilities - Location

- Gathering Area
- Outdoor classroom/amphitheatre



# Facilities - Location

- Skating Trail
- Outdoor Swimming
- Tennis
- Volleyball
- Basketball
- Fitness Equipment
- Dog Park

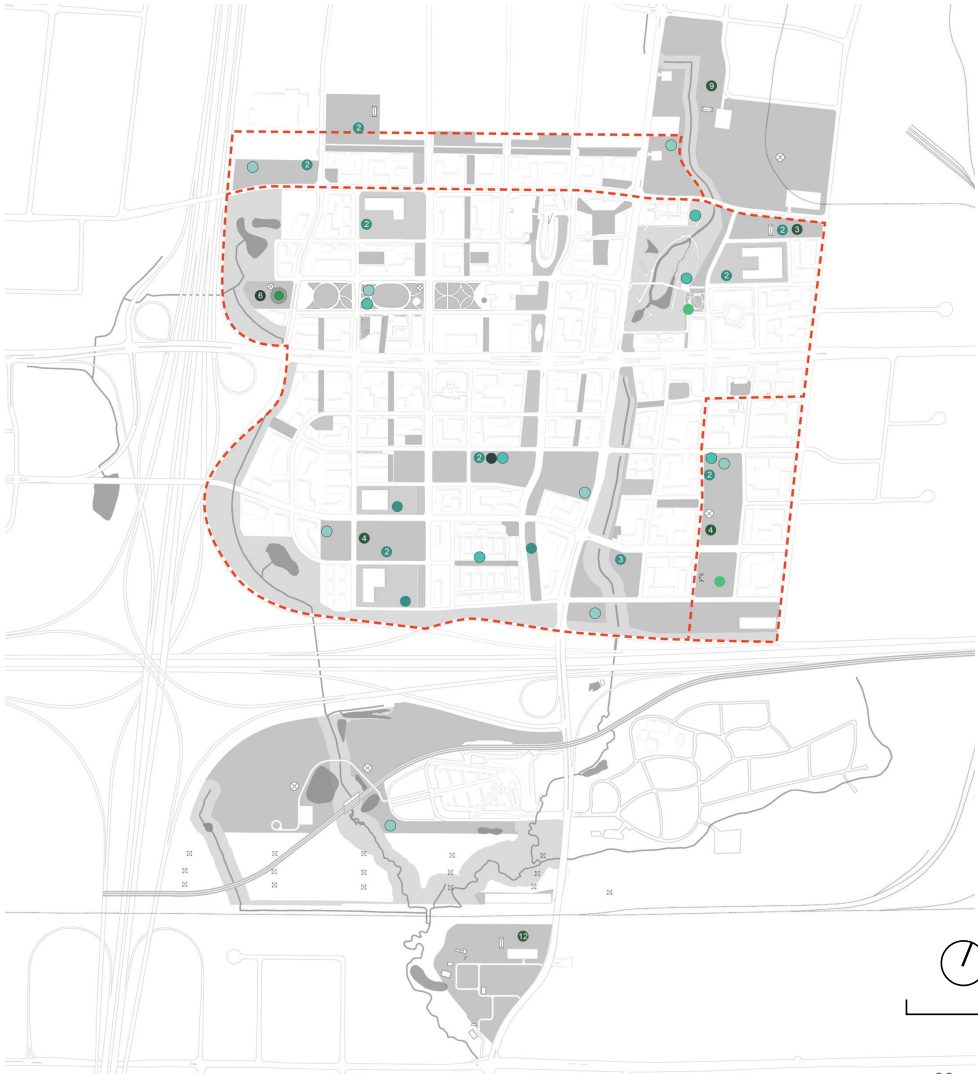

# Facilities - Location

- Baseball Diamond
- Soccer Pitch
- Cricket Pitch
- Hockey/Skating Rink
- Skateboard Park

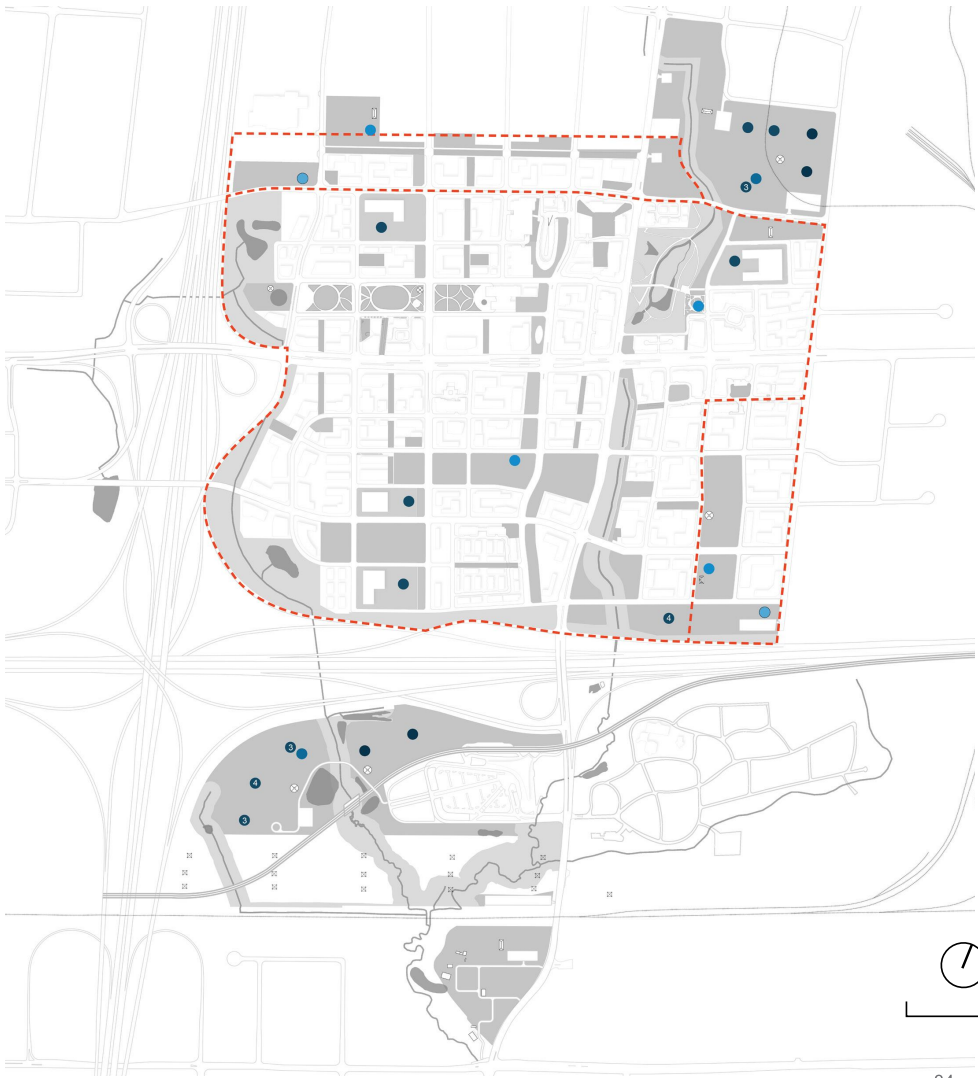



# Facilities - Location

- Picnic Pavilion
- BBQ Picnic Area
- Allotment Garden
- Agricultural Demonstration Garden
- Playground
- Natural Playground
- Splash Pad
- Gathering Area
- Outdoor classroom/amphitheatre
- Skating Trail
- Outdoor Swimming
- Tennis
- Volleyball
- Basketball
- Fitness Equipment
- Dog Park
- Baseball Diamond
- Soccer Pitch
- Cricket Pitch
- Hockey/Skating Rink
- Skateboard Park



# Facilities - Provision

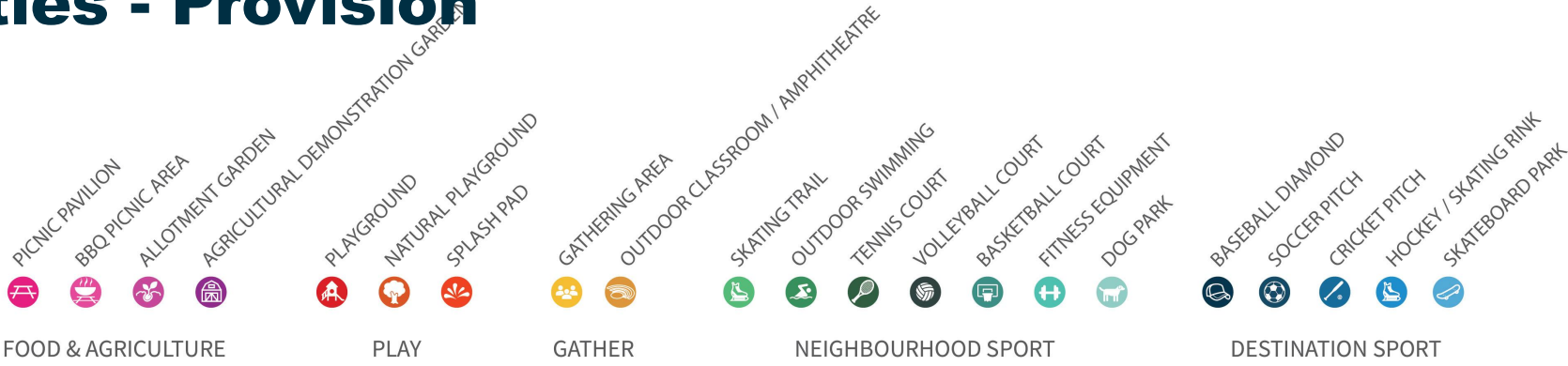

# Facilities - Provision

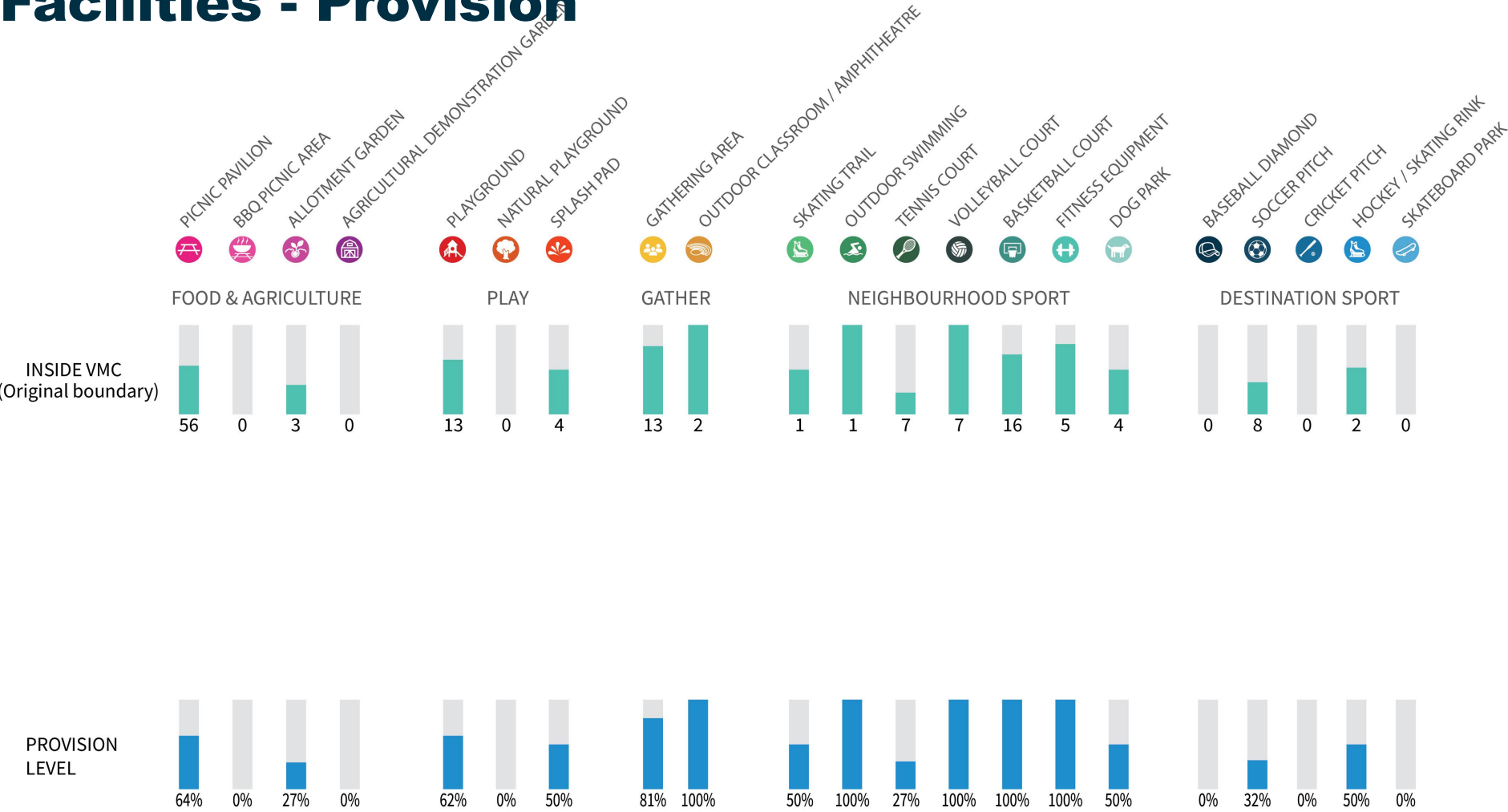

# Facilities - Provision

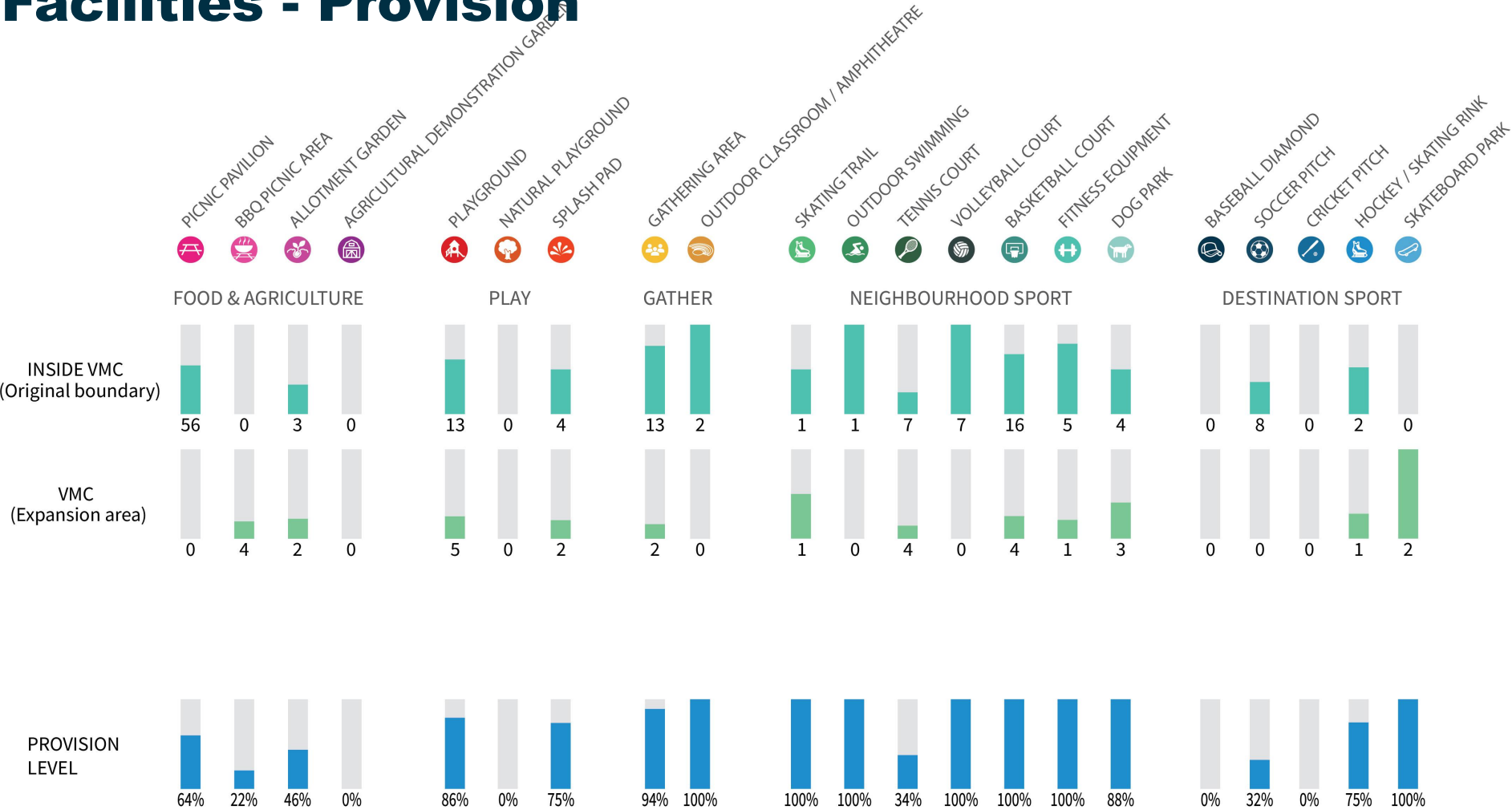



# Facilities - Provision

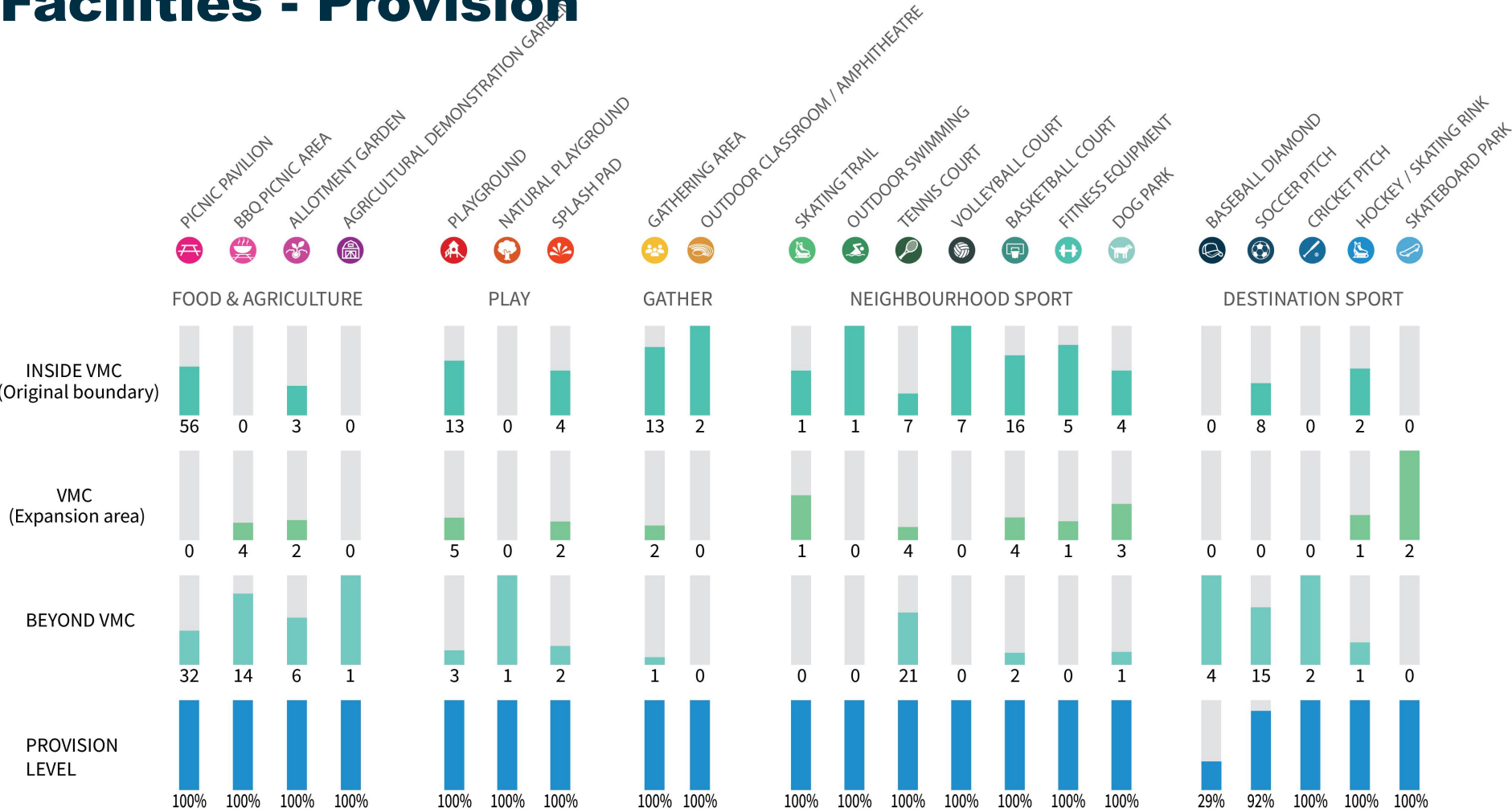

# Circulation

- Cycling Facilities
- Multi-Use Paths
- Mews (pedestrian)
- Mews (vehicular)



# Circulation - The LOOP(s)

— An Urban LOOP, a 4-km path which features the two Urban Parks and Millway Avenue Promenade.

— An Open Space LOOP, a 6-km path which connects all of the VMC's Environmental Open Space.

- B Bridge
- T Tunnel
- U Underpass

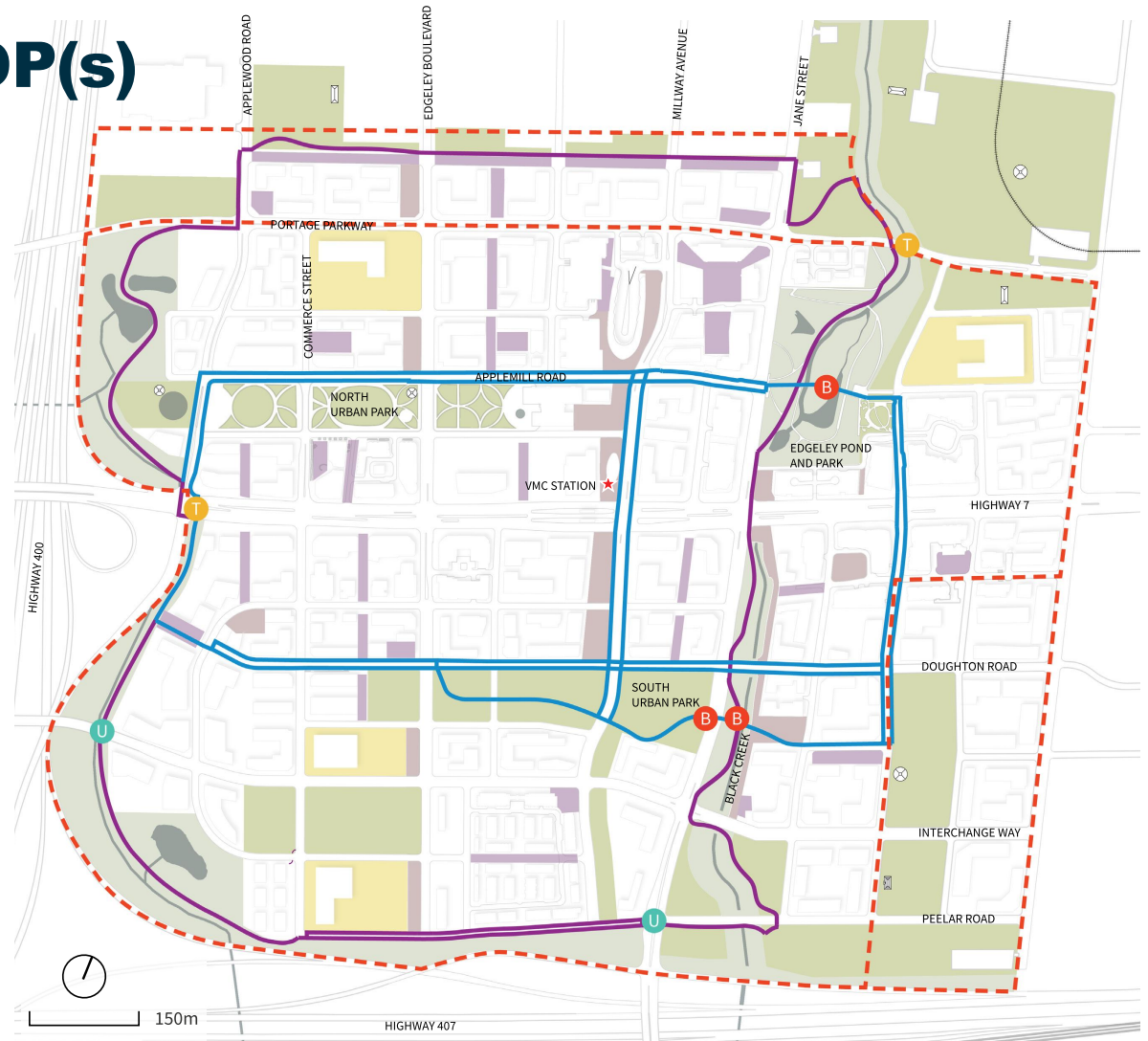



# Circulation - Connecting from VMC

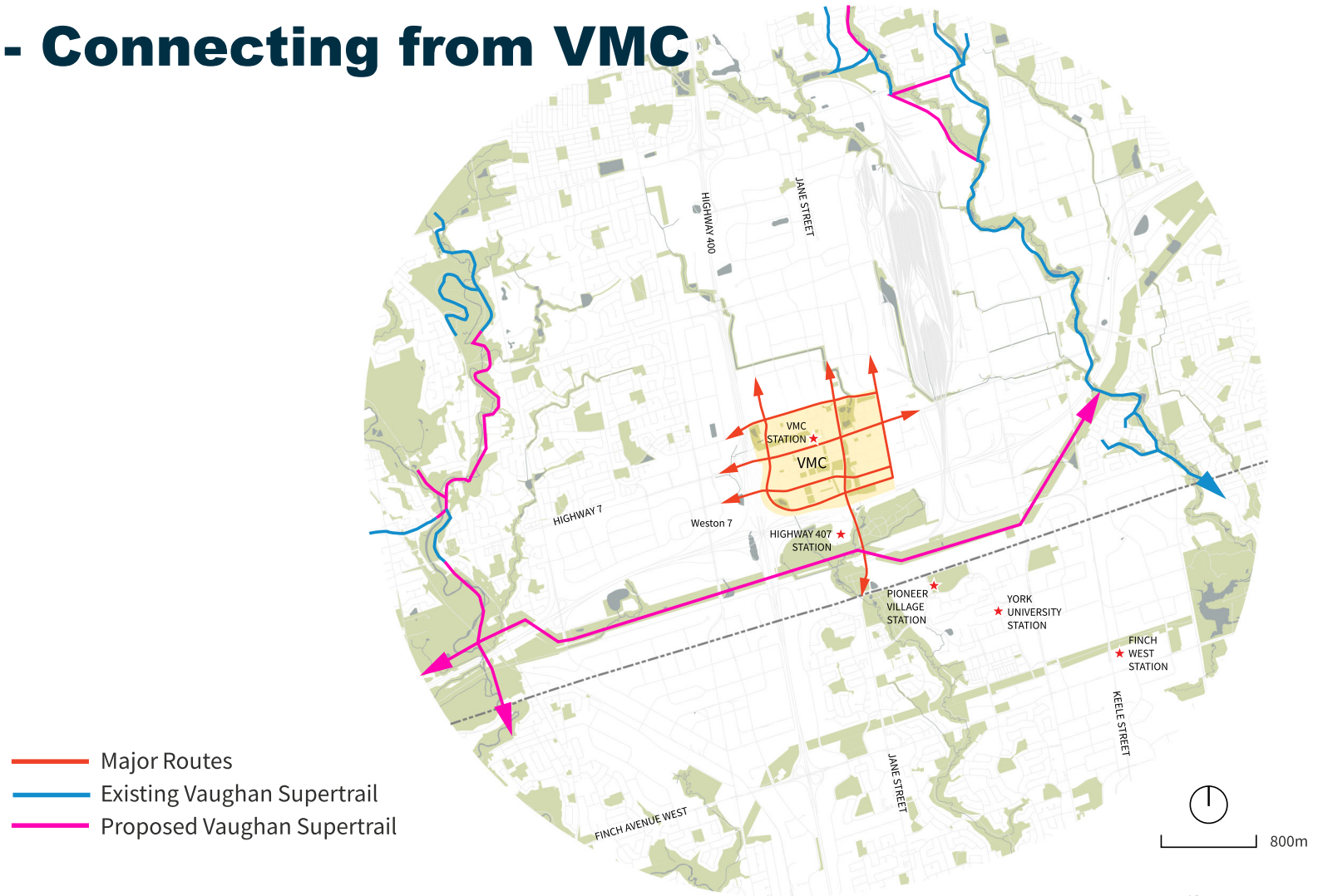

# Connecting from VMC

The Master Plan will recommend a safe, convenient connection for pedestrians and cyclists over Highway 407, not only to access potential parks, but to connect the VMC to the planned Vaughan Supertrail and the many open spaces in the Humber River, Black Creek and West Don River greenways.



- Existing Trail
- - - Proposed Trail
- 1 MTO Lands
- 2 Black Creek Pioneer Village North Lands
- 3 Beechwood Cemetery



# Connecting from VMC

- The Jane Street Bridge is not currently designed for pedestrians or cyclists.
- Options for a crossing include:
  - A typical bike lane and sidewalk beside the road.
  - A completely separated pedestrian and bicycle crossing.

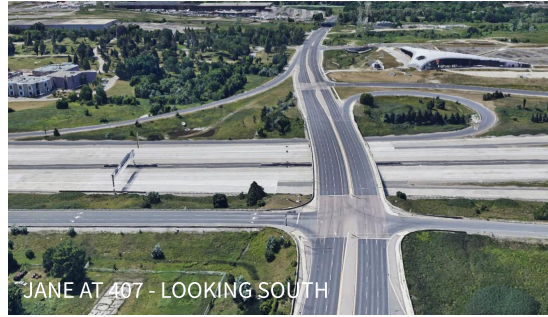

JANE AT 407 - LOOKING SOUTH



JANE AT 407 - LOOKING SOUTH



BIKE LANE & SIDEWALK



SEPARATED BIKE & PEDESTRIAN CROSSING



# Circulation - What Did We Ask?

?

Will the comfort and safety of a crossing over Highway 407 affect whether you will walk or cycle to parks and open space south of VMC?

1. Yes, the more comfortable I feel, the more likely I am to walk or cycle across 407 to go to parks.
2. No, I am more likely to drive or take transit to any park south of VMC.
3. No, I don't see myself going to a park south of VMC.

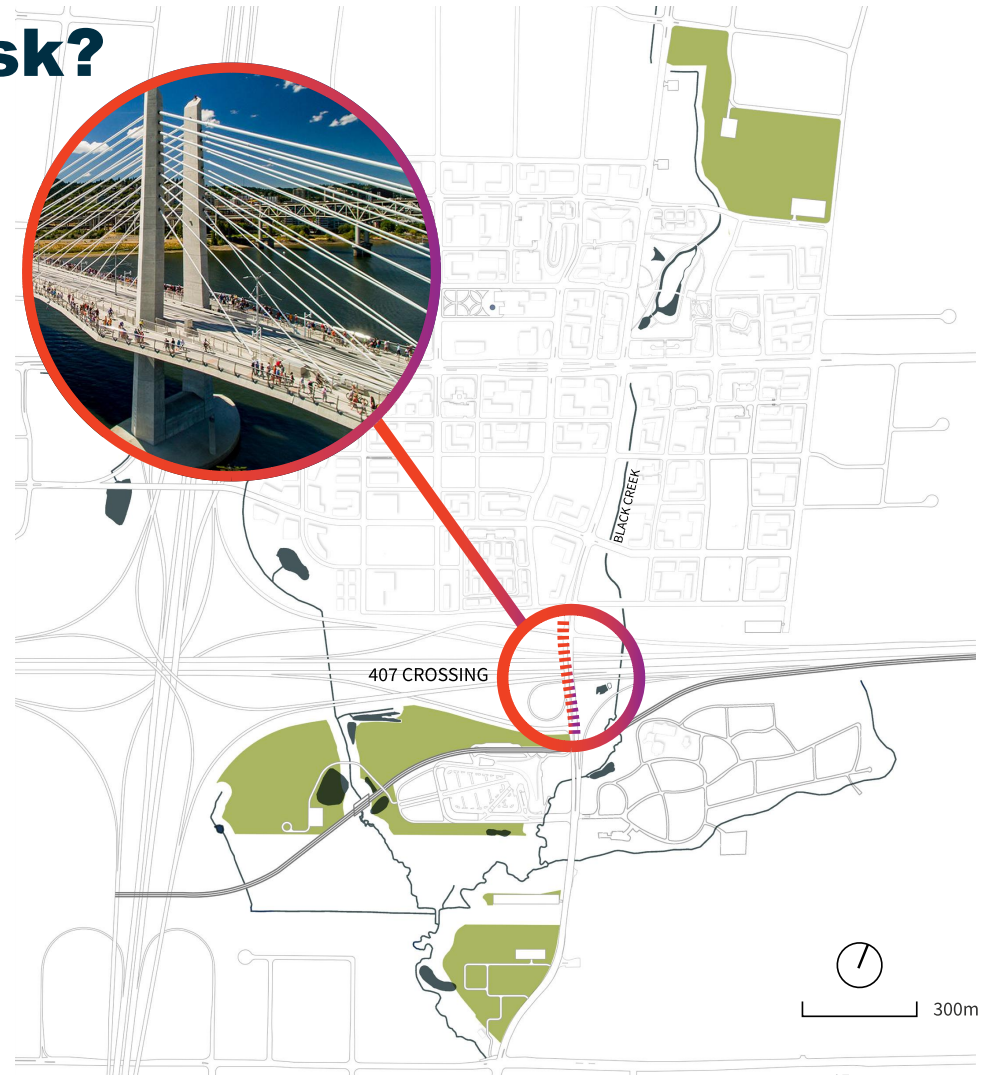

## Circulation - What Did We Hear?

Will the comfort and safety of a crossing over Highway 407 affect whether you will walk or cycle to parks and open space south of VMC?

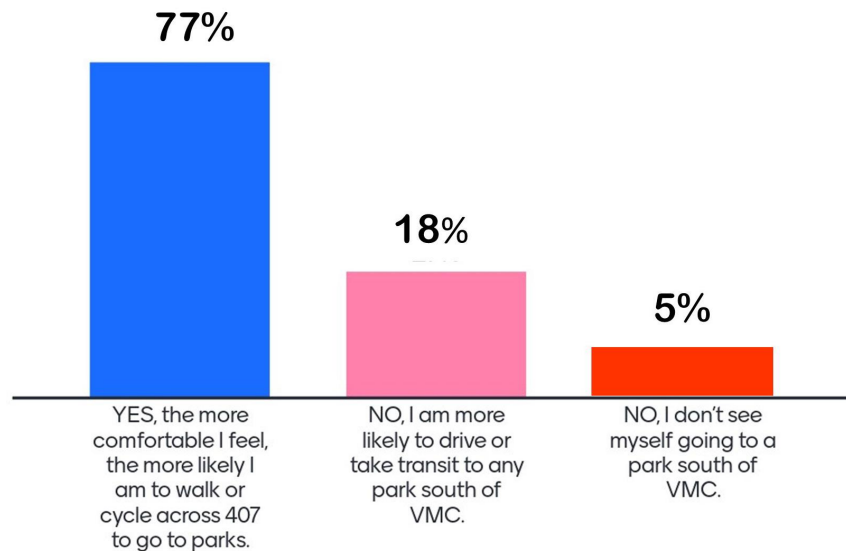

## Master Plan vs. Assessment

1

DEVELOPMENT TRENDS SUGGEST THE VMC WILL BECOME ONE OF THE MOST DENSE AREAS IN NORTH AMERICA.

2

IT IS CRITICAL TO PROVIDE ADDITIONAL PARKLAND IN OR NEAR THE VMC.

3

PROVIDING REQUIRED RECREATIONAL FACILITIES DEMANDS CAREFUL PLANNING.

4

CONNECTING THE VMC TO OPEN SPACE SOUTH OF HIGHWAY 407 IS IMPORTANT.

5

DEVELOPMENT OF PARKS AND OPEN SPACES MUST CONTINUE TO REFLECT PLANNING GOALS.





# Master Plan vs. Assessment

1 DEVELOPMENT TRENDS SUGGEST THE VMC WILL BECOME ONE OF THE MOST DENSE AREAS IN NORTH AMERICA.

- Master Plan focused on evaluating impact on public realm of increased density and strategies for ensuring that original Council goals respecting complete communities can be realized.



# Master Plan vs. Assessment

2 IT IS CRITICAL TO PROVIDE  
ADDITIONAL PARKLAND IN OR  
NEAR THE VMC.

## Active Parkland

- Assessment Report identified **0.4 hectares/1000 residents** as provision level to meet original SP minimum target and establish VMC as Growth Centre leader.
- Based on current development trend projection of 128,000 residents, the projected Master Plan provides active parkland as follows:
  - 22 ha or **0.17 ha/1000 residents** in original VMC area.
  - 13 ha in expanded VMC area, for a total of 35 ha or **0.27 ha/1000 residents**.
  - 40 ha in North and South adjacent parks, for a total of 75 ha or **0.58 ha/1000 residents**.



# Master Plan vs. Assessment

2 IT IS CRITICAL TO PROVIDE  
ADDITIONAL PARKLAND IN OR  
NEAR THE VMC.

## Active Parkland

- If current development trends are permitted to continue:
  - A minimum of 13 hectare of active parkland is required in Expansion Areas.
  - A minimum of 40 hectares of active parkland is required in areas adjacent to the VMC to provide adequate parkland and facilities.
- Slowing development trends in the VMC might reduce or delay the need to acquire additional parkland adjacent the VMC, and place less pressure on parkland within VMC.

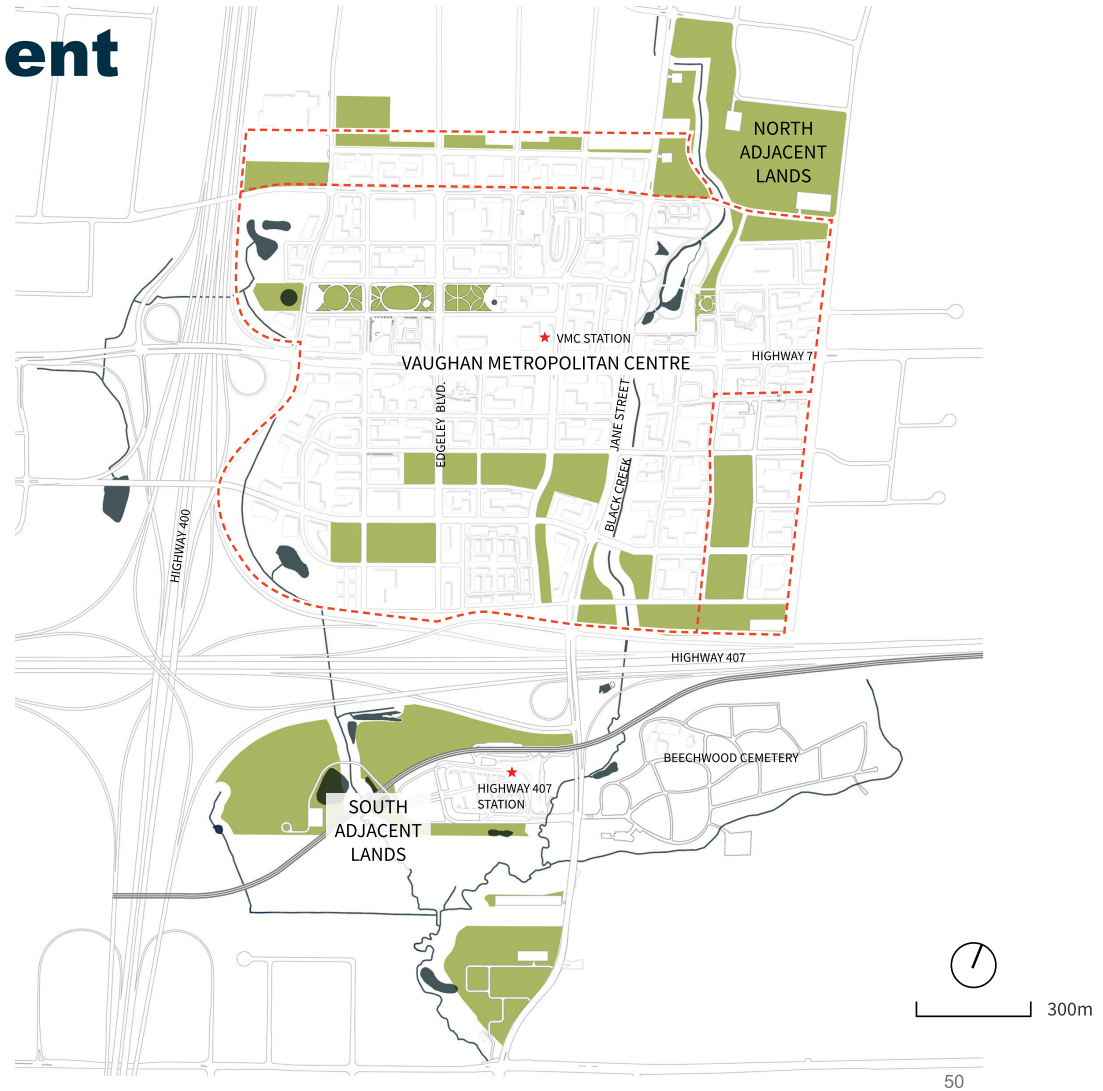

# Master Plan vs. Assessment

## 3 PROVIDING REQUIRED RECREATIONAL FACILITIES DEMANDS CAREFUL PLANNING.

### Facilities Provision

- Master Plan provides for key 'urban living' facilities with expanded VMC area.
- Addition of significant active parkland adjacent the VMC is required to allow for the majority of larger sports facilities to be provided.
- Full provision of all required facilities will likely require a wider district approach taking into account other intensification areas.
- Slowing development trends in the VMC might reduce or delay the need to acquire parkland for facilities adjacent the VMC.

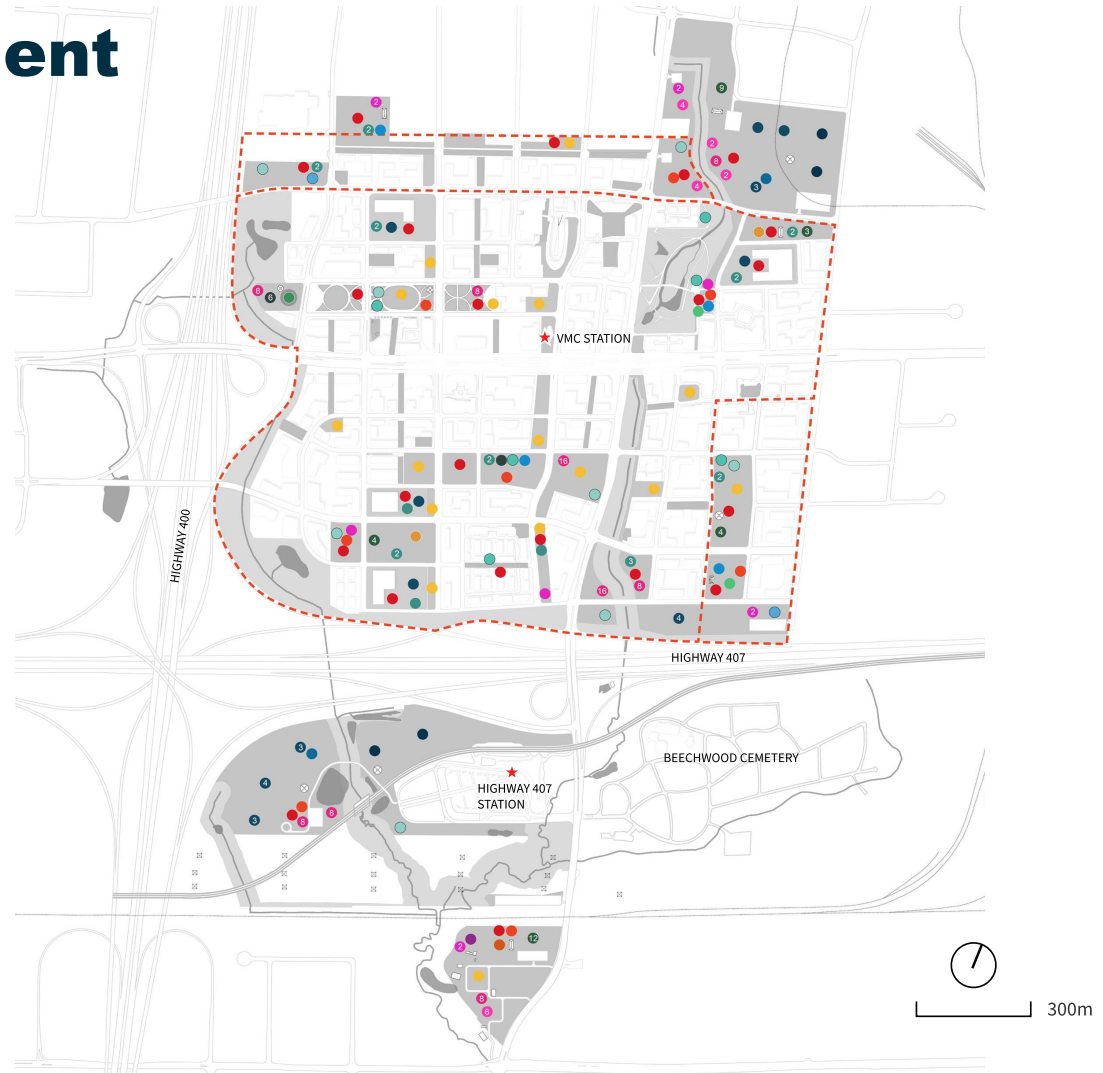



# Master Plan vs. Assessment

**4** CONNECTING THE VMC TO OPEN SPACE SOUTH OF HIGHWAY 407 IS IMPORTANT.

## Connection Across 407

- Identify significant opportunities for parks and open space south of the VMC.
- Recommend a dedicated pedestrian and cycling connection across Highway 407 as a key strategy to expand VMC public realm.

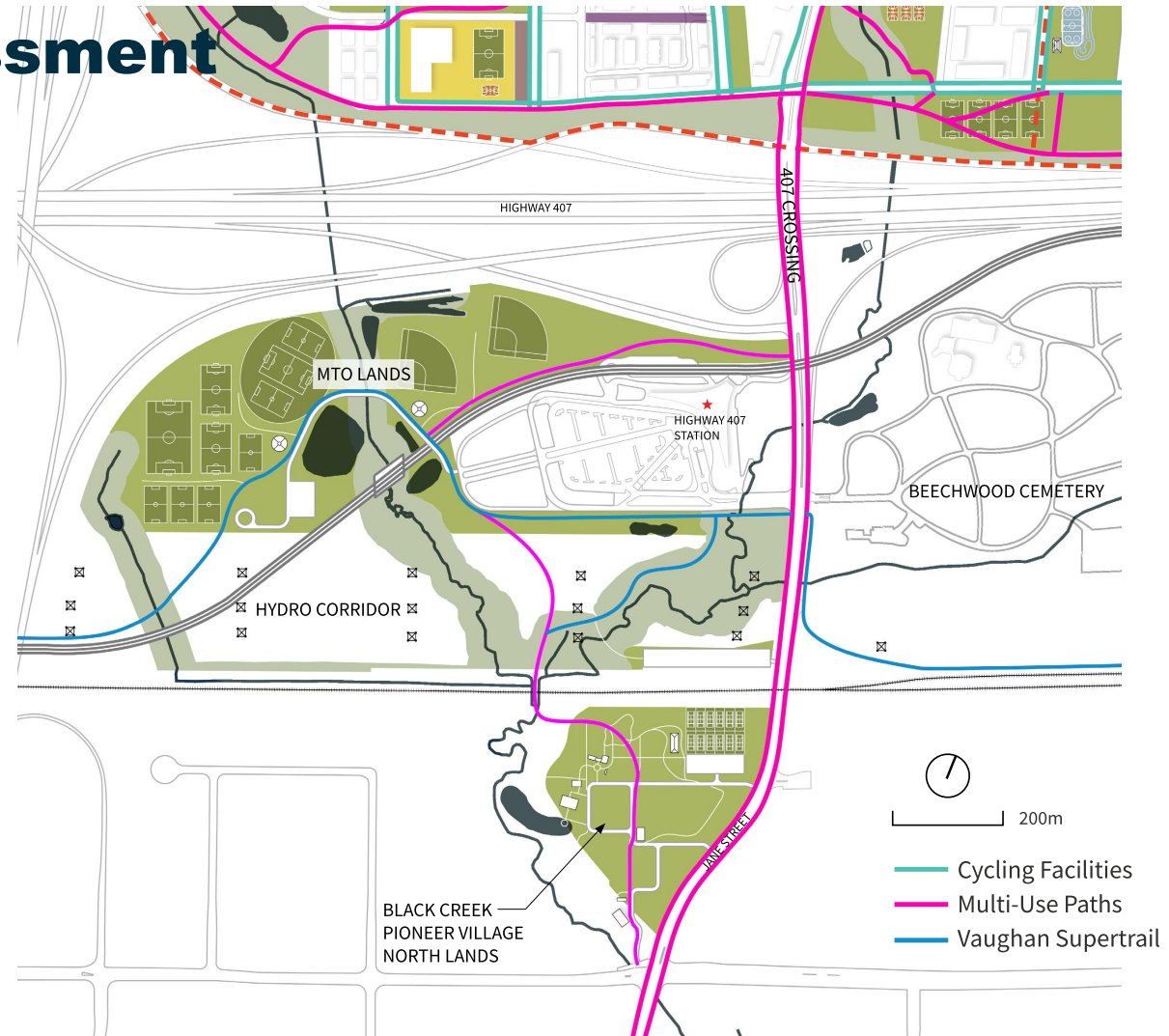

# Master Plan vs. Assessment

5 DEVELOPMENT OF PARKS AND  
OPEN SPACES MUST CONTINUE  
TO REFLECT PLANNING GOALS.

## VMC Secondary Plan

- “To overcome the VMC’s industrial and highway setting, the Secondary Plan proposes naturalized open spaces, parks and streetscapes that will establish an attractive setting for development. It calls for the creation of complete neighbourhoods within the VMC to support vitality in the future downtown core.”
- Council had a clear vision for a walkable, green, vibrant and beautiful downtown - need to preserve this vision.

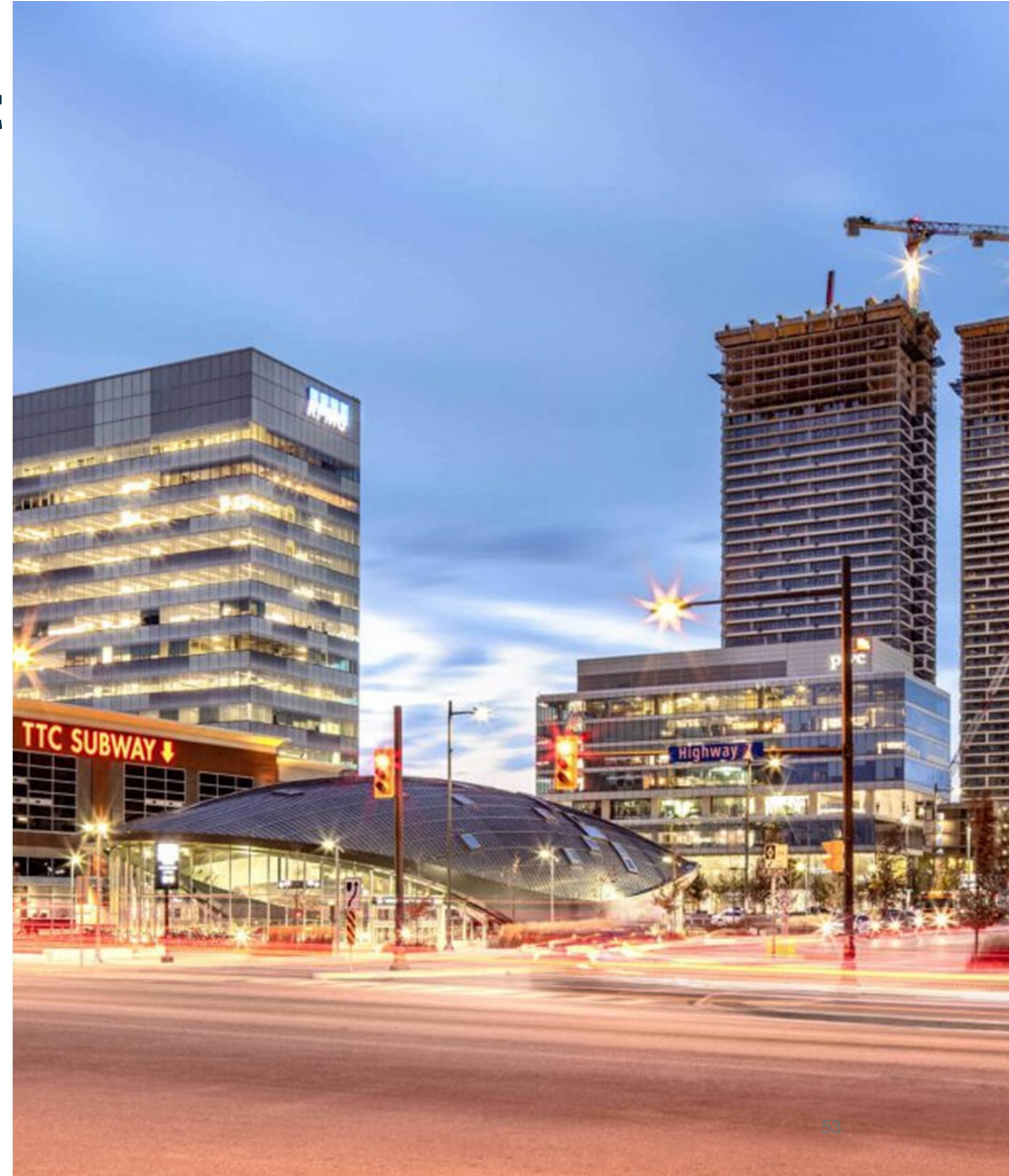

# Master Plan vs. Assessment

5

DEVELOPMENT OF PARKS AND  
OPEN SPACES MUST CONTINUE  
TO REFLECT PLANNING GOALS.

When it comes to the transformation underway in the VMC, what has you most excited?

## Key Themes from Public

- Safe, convenient, accessible pedestrian and cycling connections to public space are essential.
- New urban parks should balance green space and facilities to allow both individuals and communities to flourish in an urban environment.
- Certain spaces, like Millway Promenade and South Urban Park, should support the urban uses that create vitality in a downtown.



# Master Plan - Next Steps

- Major focus of Implementation Phase will be to provide recommendations to ensure that parks and open spaces open on a timeline that is in step with development.
- Signage and wayfinding component will be developed.
- Master Plan will be going to the DRP in November.

