

(ROAD ALLOWANCE BETWEEN CONCESSIONS 4 AND 5)
(BY BY-LAW R-670-80-126, INST. No. R2E1405)

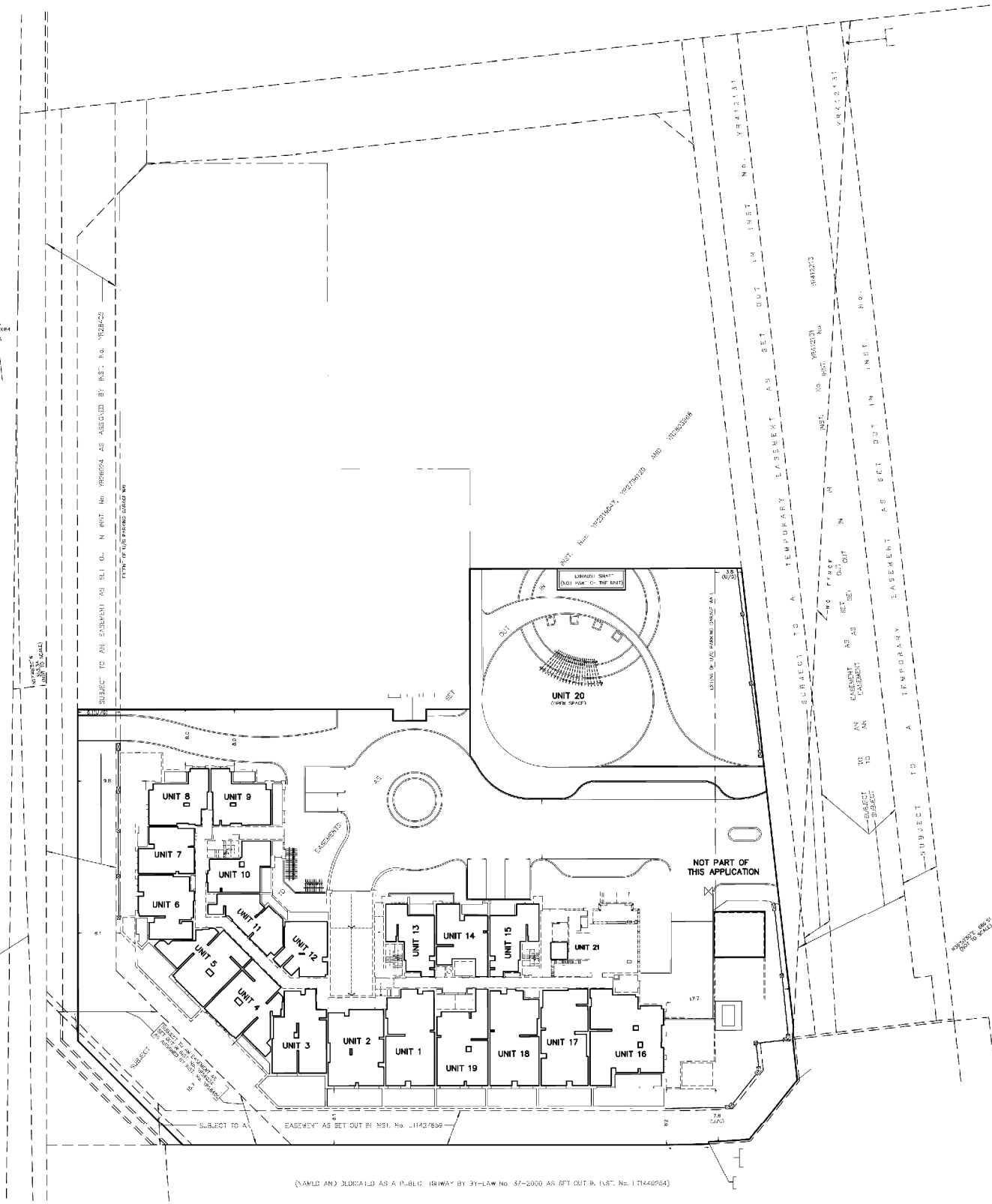

RESIDENTIAL UNITS 1 TO 19, INCLUSIVE
OPEN SPACE UNIT 20
CENTRAL ALARM AND CONTROL FACILITY UNIT 21
ON LEVEL 1

Not to Scale

Draft Plan of Condominium (Standard)

File: 19CDM-20V005 - Level 1

LOCATION: Part of Lot 15, Concession 4
9075 and 9085 Jane Street

APPLICANT:
Tesmar Holdings Inc.



Attachment

FILES: 19CDM-20V005 and
19CDM-20V006

RELATED FILES: OP.05.020,
Z.07.029 and DA.14.037

DATE: June 1, 2021

5