

**Yonge Steeles Corridor Secondary Plan
Schedule 2 (South)
Land Use, Height and Density**

C7.
Communication
CW(2) – April 14, 2026
Item No. 15



- Secondary Plan Boundary
- High-Rise Residential
- Low-Rise Residential
- High-Rise Mixed Use
- Mid-Rise Mixed Use
- Mid-Rise Residential
- Infrastructure and Utilities
- Park
- Proposed Park
- D: # Density
- H: # Height
- D: # Density is a Minimum Target
- D: # Zoning Approved Density and Height
H: #



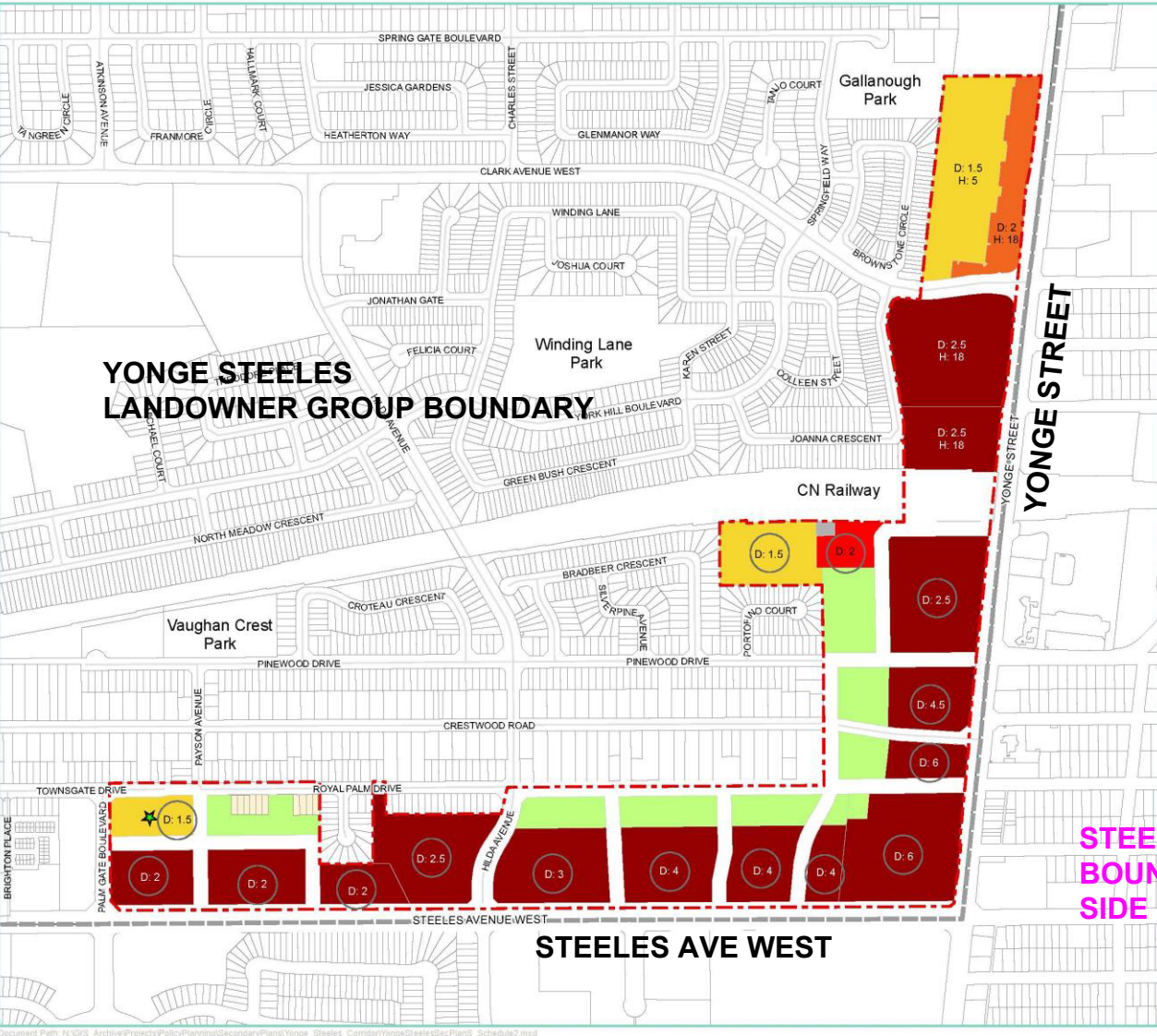

**YONGE STEELES
 LANDOWNER GROUP BOUNDARY**

YONGE STREET

STEELES AVE WEST

**STEELES SUBWAY STATION MTA
 BOUNDARY ON CITY OF VAUGHAN
 SIDE OF YONGE**

- Secondary Plan Boundary
- High-Rise Residential
- Low-Rise Residential
- High-Rise Mixed Use
- Mid-Rise Mixed Use
- Mid-Rise Residential
- Infrastructure and Utilities
- Park
- Proposed Park
- D: # Density
- H: # Height
- D: # Density is a Minimum Target
- D: # Zoning Approved Density and Height



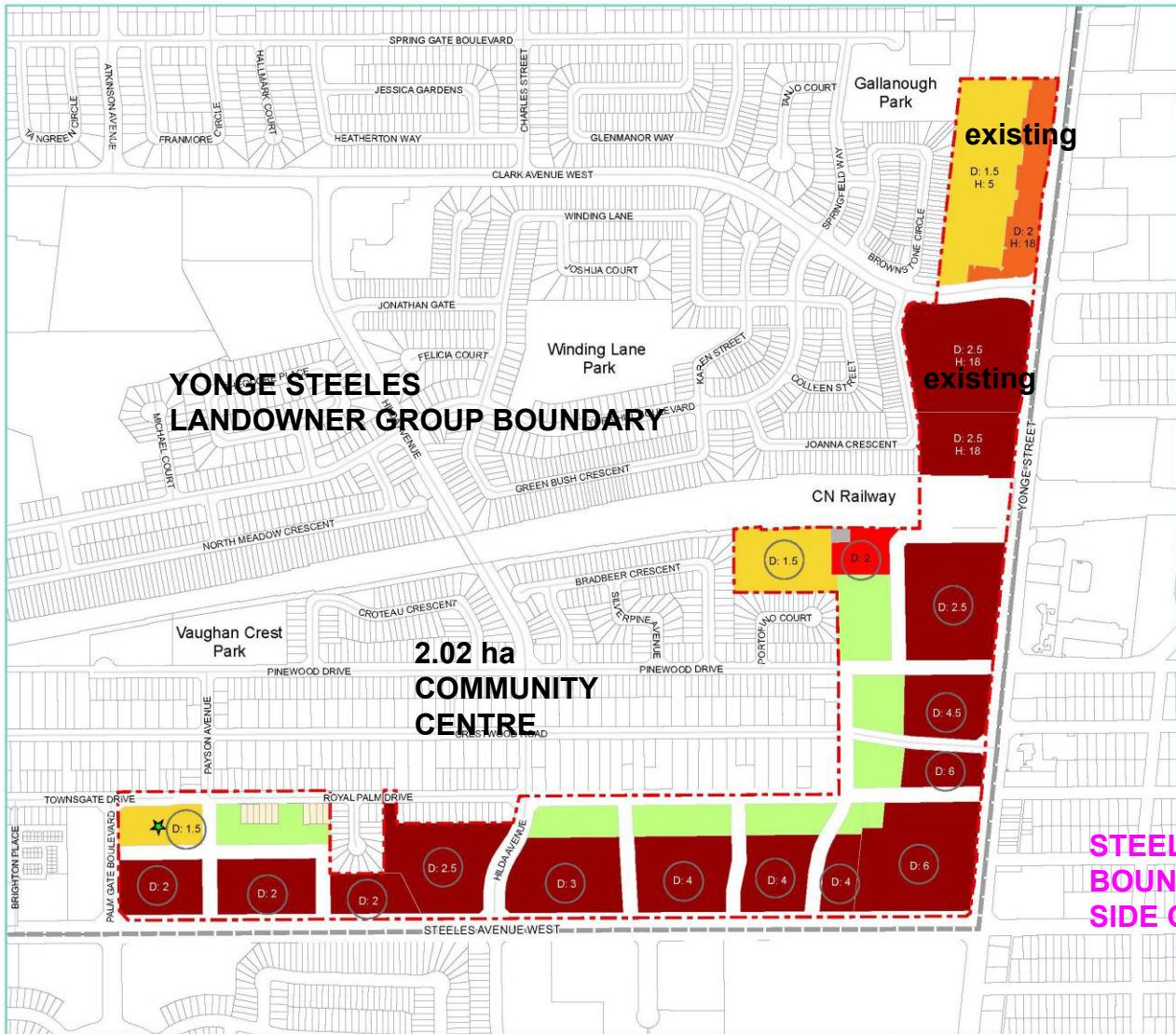

- Secondary Plan Boundary
- High-Rise Residential
- Low-Rise Residential
- High-Rise Mixed Use
- Mid-Rise Mixed Use
- Mid-Rise Residential
- Infrastructure and Utilities
- Park
- Proposed Park
- D: # Density
- H: # Height
- D: # Density is a Minimum Target
- D: # Zoning Approved Density and Height

STEELES SUBWAY STATION MTA BOUNDARY ON CITY OF VAUGHAN SIDE OF YONGE





FIGURE 5
ILLUSTRATED
DEVELOPMENT PLAN

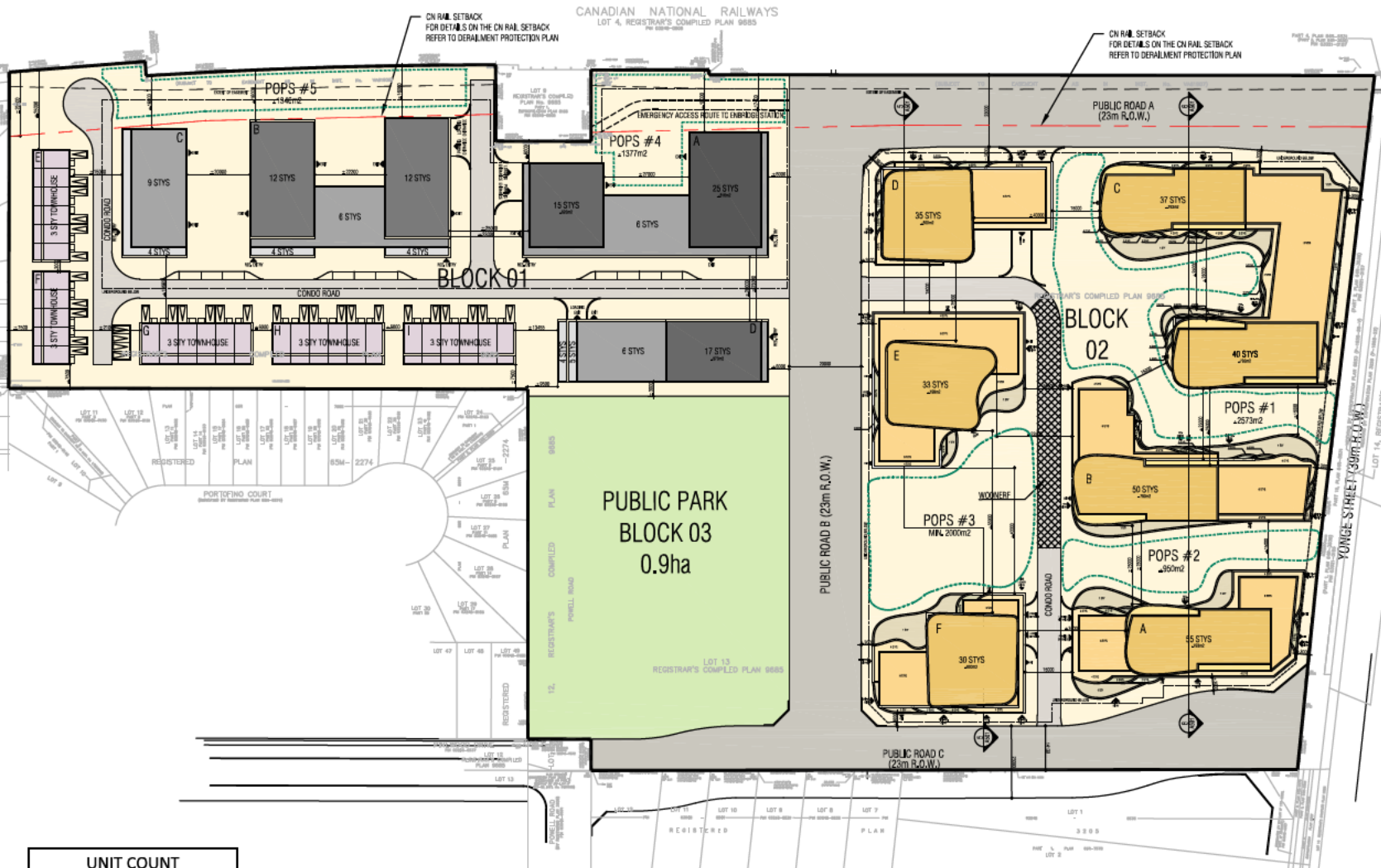

Gatzlas Planning +
Development Consultants Inc.



SCALE | 1:2000
0 20m 40m

DATE | 2023/10/12 PROJECT | 21-169

AUTOCOMPLEX
YONGE & STEELES



FIGURE 5
ILLUSTRATED
DEVELOPMENT PLAN

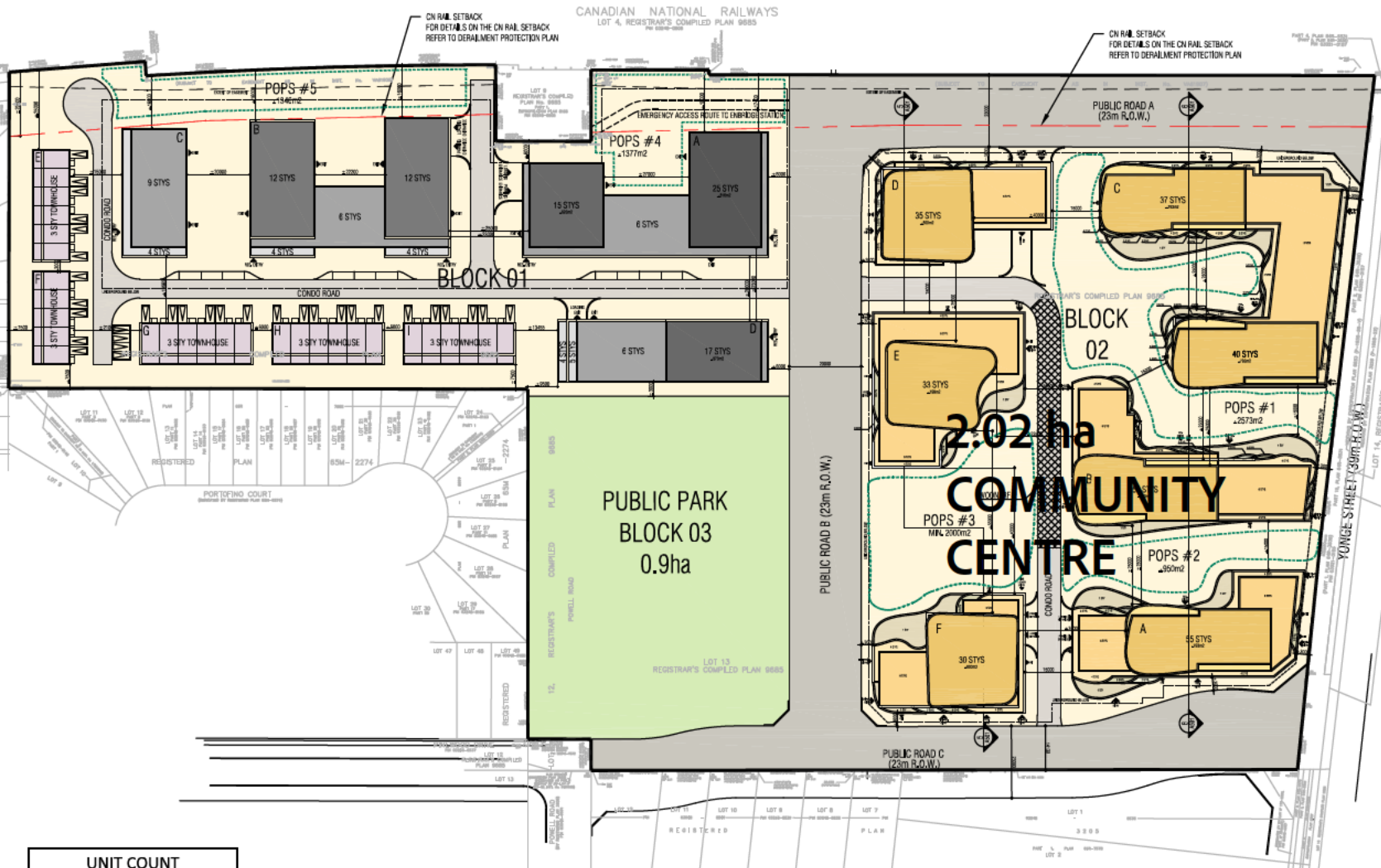

UNIT COUNT	
BLOCK #1:	1137 UNITS
BLOCK #2:	3803 UNITS
TOTAL:	4940 UNITS

Gatzlas Planning +
Development Consultants Inc.



SCALE | 1:2000
0 20m 40m

DATE | 2023/10/12 PROJECT | 21-169

AUTOCOMPLEX
YONGE & STEELES

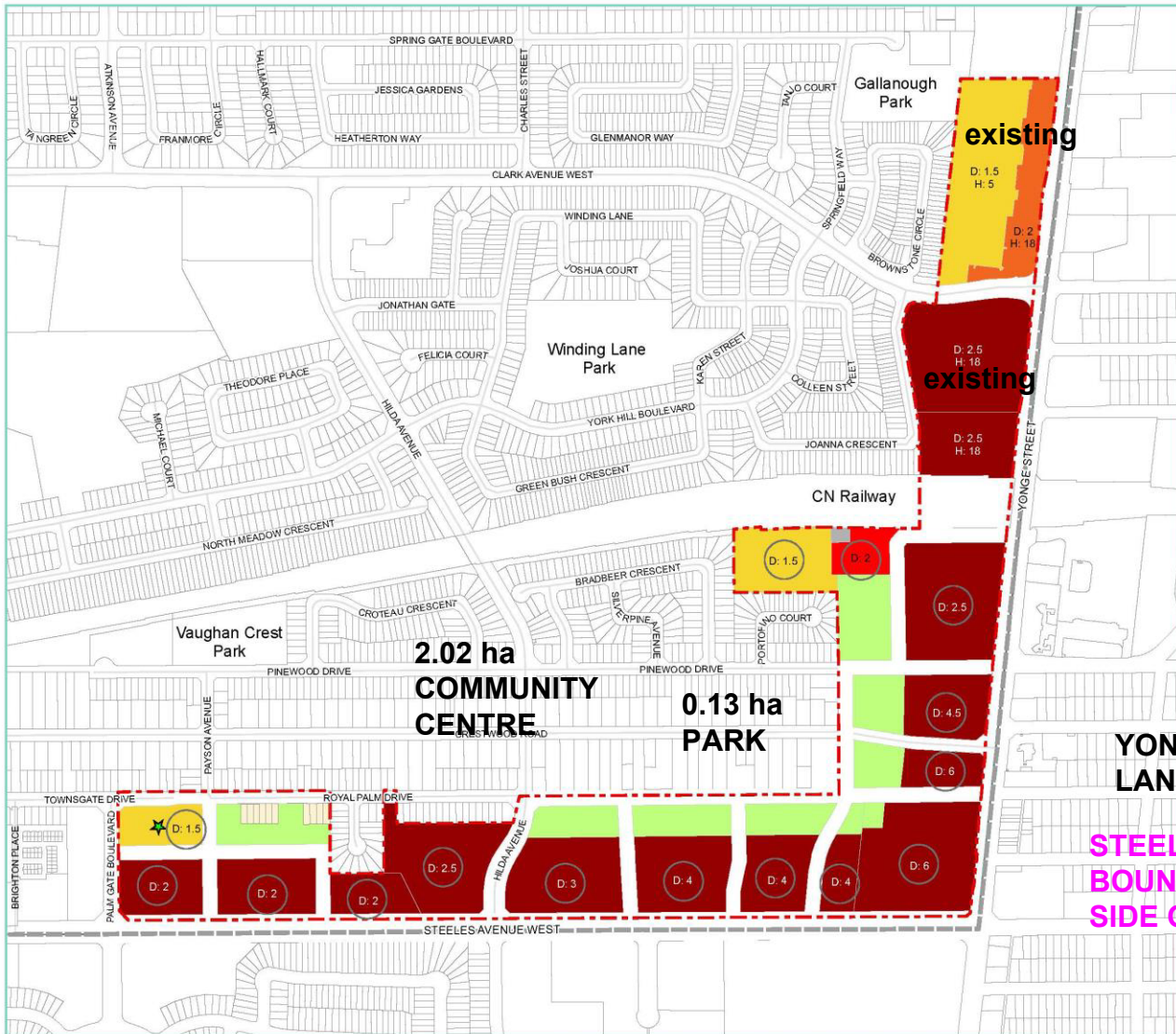

Secondary Plan Boundary

High-Rise Residential

Low-Rise Residential

High-Rise Mixed Use

Mid-Rise Mixed Use

Mid-Rise Residential

Infrastructure and Utilities

Park

Proposed Park

D: # Density

H: # Height

D: # Density is a Minimum Target

D: # Zoning Approved Density and Height
 H: #

**YONGE STEELES
 LANDOWNER GROUP BOUNDARY**

**STEELES SUBWAY STATION MTSA
 BOUNDARY ON CITY OF VAUGHAN
 SIDE OF YONGE**



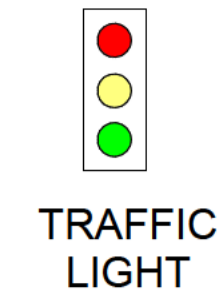

FUTURE ROYAL PALM DRIVE

PARK BUILT TO 2035:
1,300 sqm

PARKLAND DEDICATION
1,780 m²

BUILDING "B"
NORTH TOWER
38 STOREY

ACURA

BUILDING "B"
SOUTH TOWER
45 STOREY

PODIUM
8 STOREY

PODIUM
10 STOREY

BUILDING "C"
64 STOREY

BUILDING "A"
59 STOREY

PODIUM
10 STOREY

WOONERF

50 Storeys

7 Storeys

PROPOSED NEIGHBOURING DEVELOPMENT

56 Storeys

7 Storeys

65 Storeys

HIGHLAND PARK BOULEVARD

YONGE STREET

STEELES AVENUE WEST

