

TOWNSHIP  
OF KING

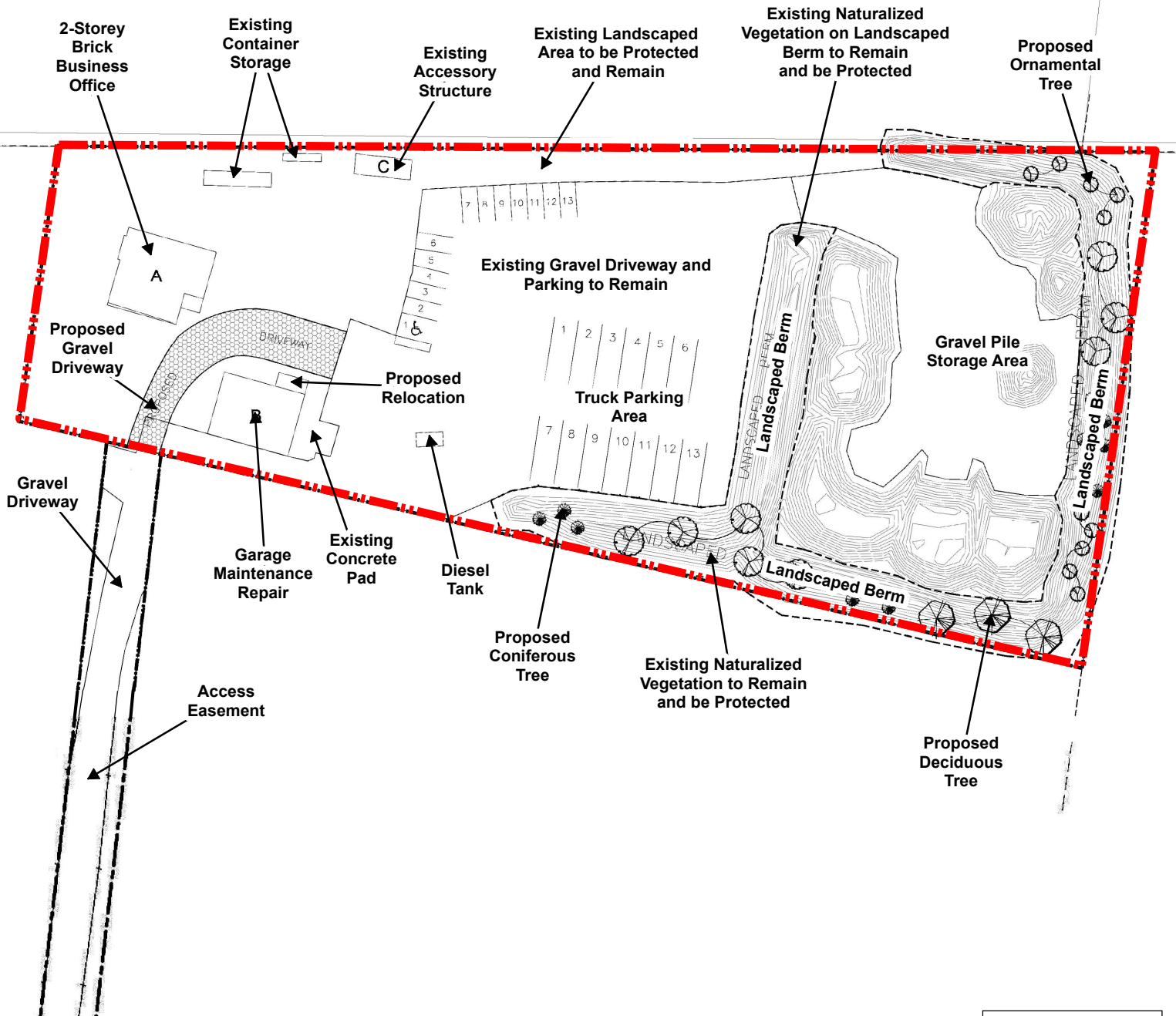

 Subject Lands

0 5 10 20 Metres

## Landscape Plan

LOCATION: 3500 King-Vaughan Road  
Part of Lot 1, Concession 5

APPLICANT:  
Zepco Holdings Inc.



Development and  
Parks Planning

FILE: Z.12.019  
RELATED FILE:  
DA.12.045

DATE: May 6, 2025

## Attachment

# 3