

LEGEND:

1	DETAIL #
D-0	SHEET #

	PROPERTY LINE CHAIN
	LINK FENCE GUARDRAIL
	EXISTING DECIDUOUS TREES
	EXISTING CONIFEROUS TREES
	EXISTING LIGHT POLE
	CONCRETE PAVING
	ASPHALT PAVING
	EXISTING CATCH BASIN
	EXISTING MANHOLE

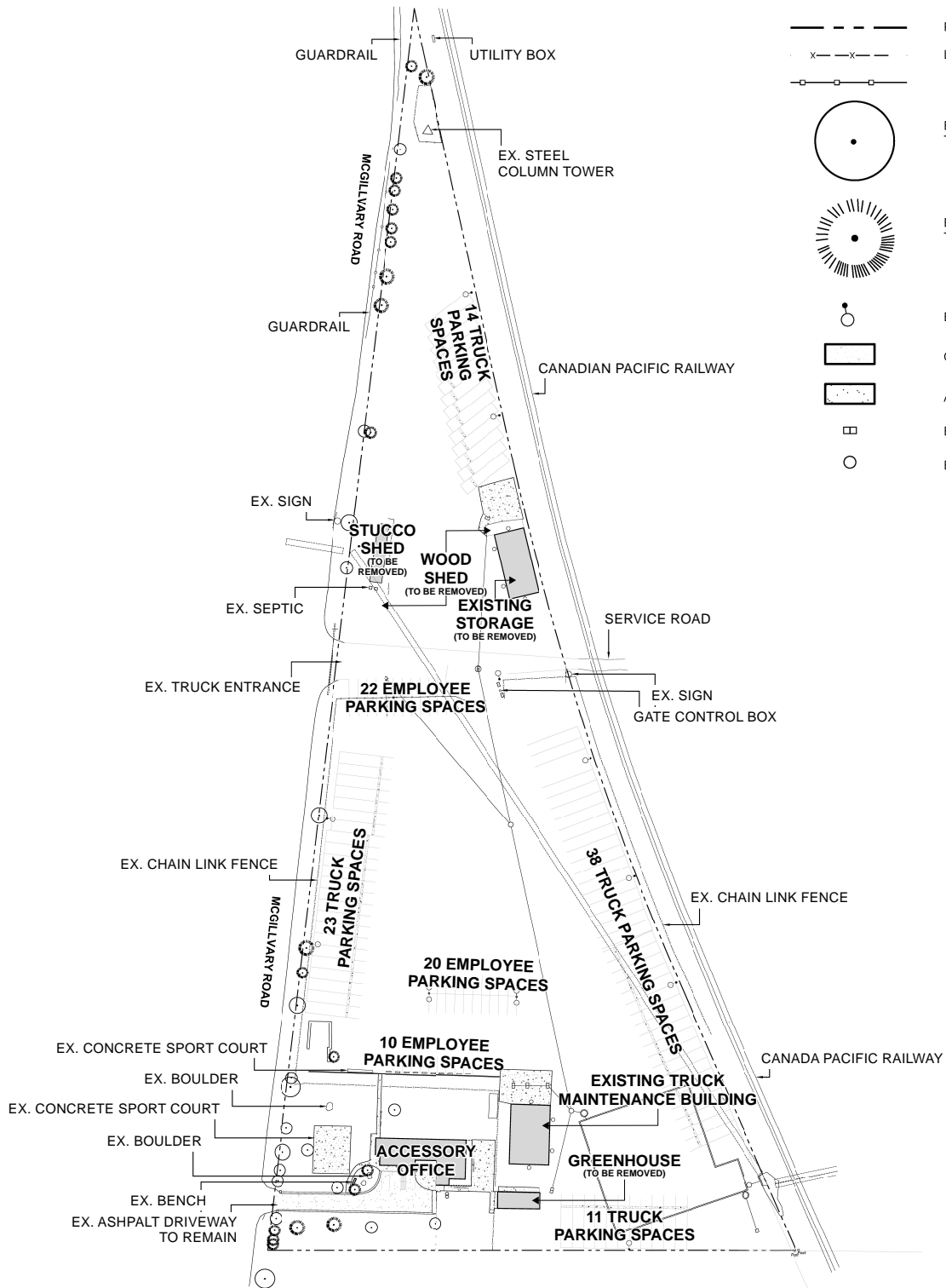

Landscape Plan

LOCATION:

9751 McGillivray Road
Part of Lot 19, Concession 9

APPLICANT:

2677812 ONTARIO INC.



Development and
Parks Planning

Attachment

FILE:

Z.24.032

RELATED FILES:

DATE:

May 6, 2025

3