



C 3

Communication

CW(WS) – May 8, 2024

Item No. 1

# **NORTH MAPLE REGIONAL PARK FAMILY RECREATION AREA UPDATE 30% DESIGN MAY 2024**

May 8, 2024

# Context

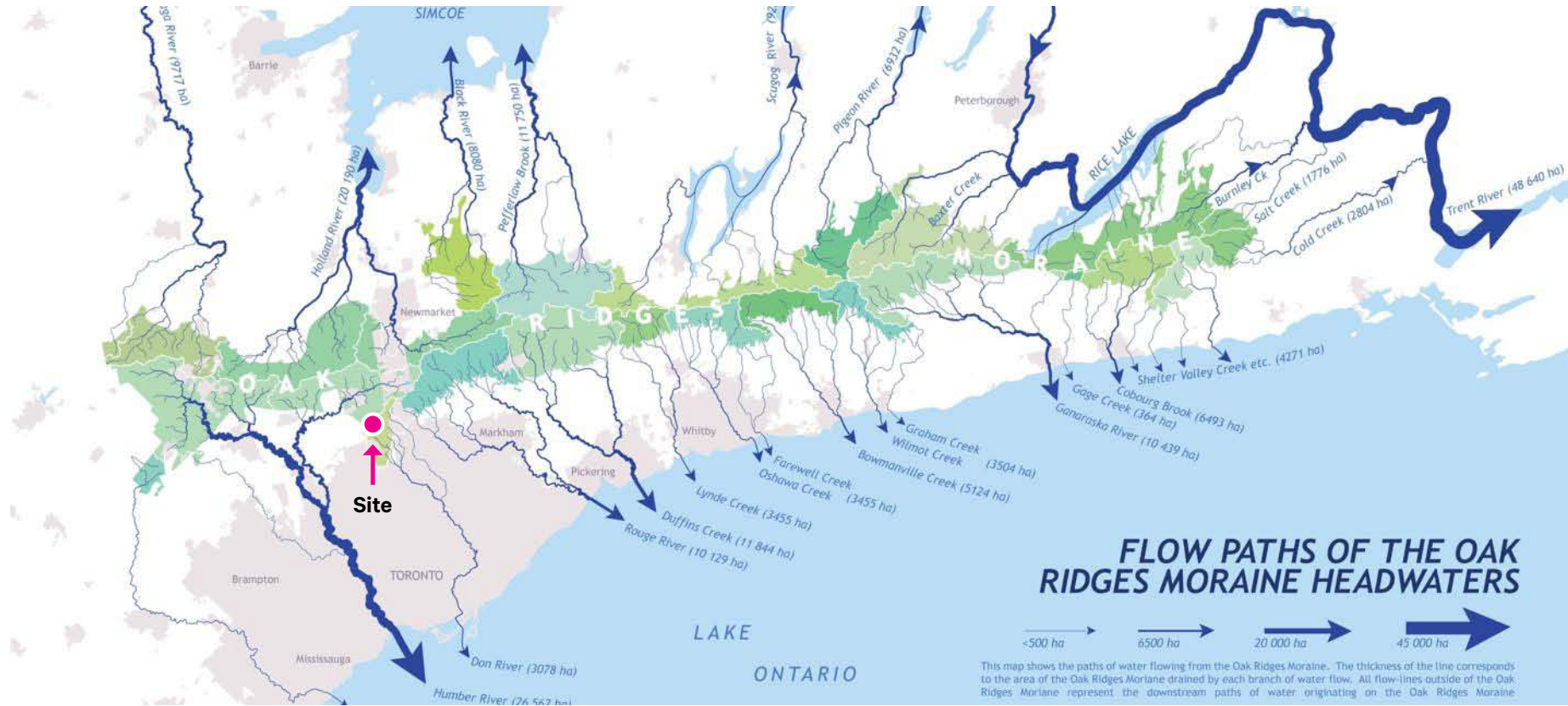

SvN

restore

engage

play

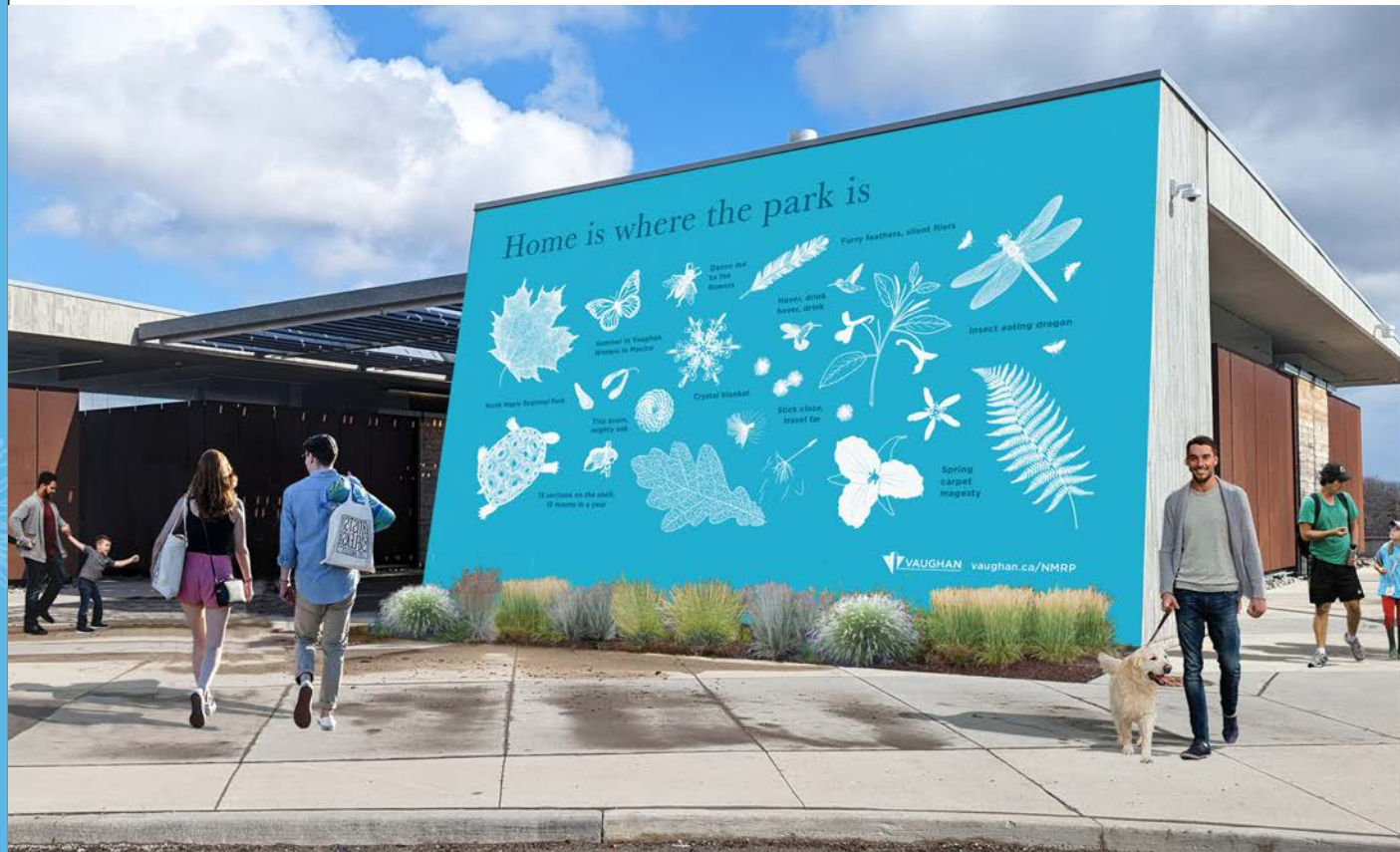

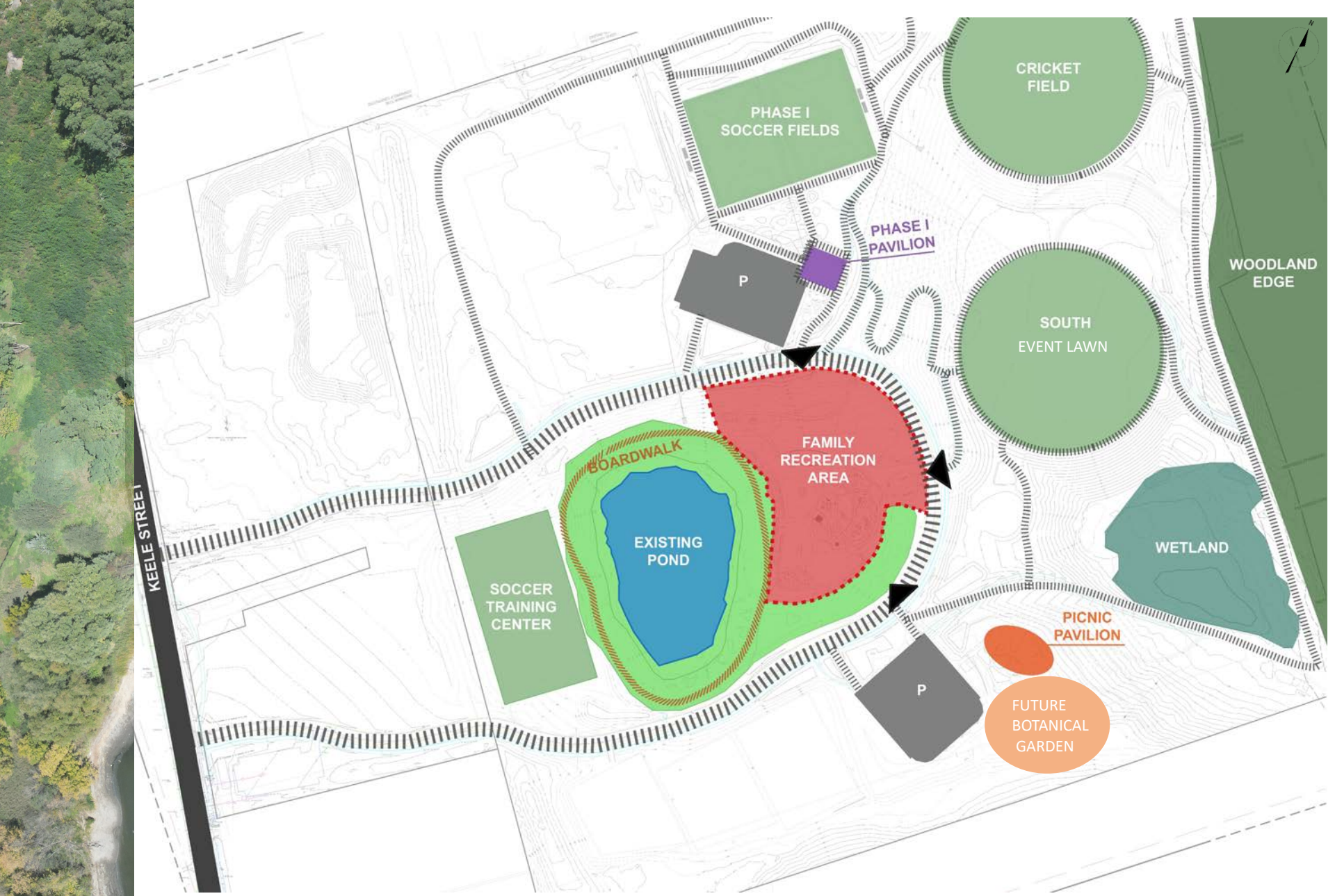

# North Maple Regional Park Ontario, Canada

INITIAL  
CONCEPT





North Entrance

North Entrance

East Entrance

East Entrance

South Entrance

South Entrance

Expanded scope

South Parking Lot

Green Parking Lot

Picnic Pavilion Area

Family Recreation Area

Pond









- Create comfortable, welcoming, park-like environments
- Predominantly permeable surfacing
- Use of regional and natural materials



Flexible spaces and a variety of materials  
inspire the imagination



A variety of play options  
for different age groups  
supports the development process



- 18m - 5 years
- 5 - 12 years
- Teens

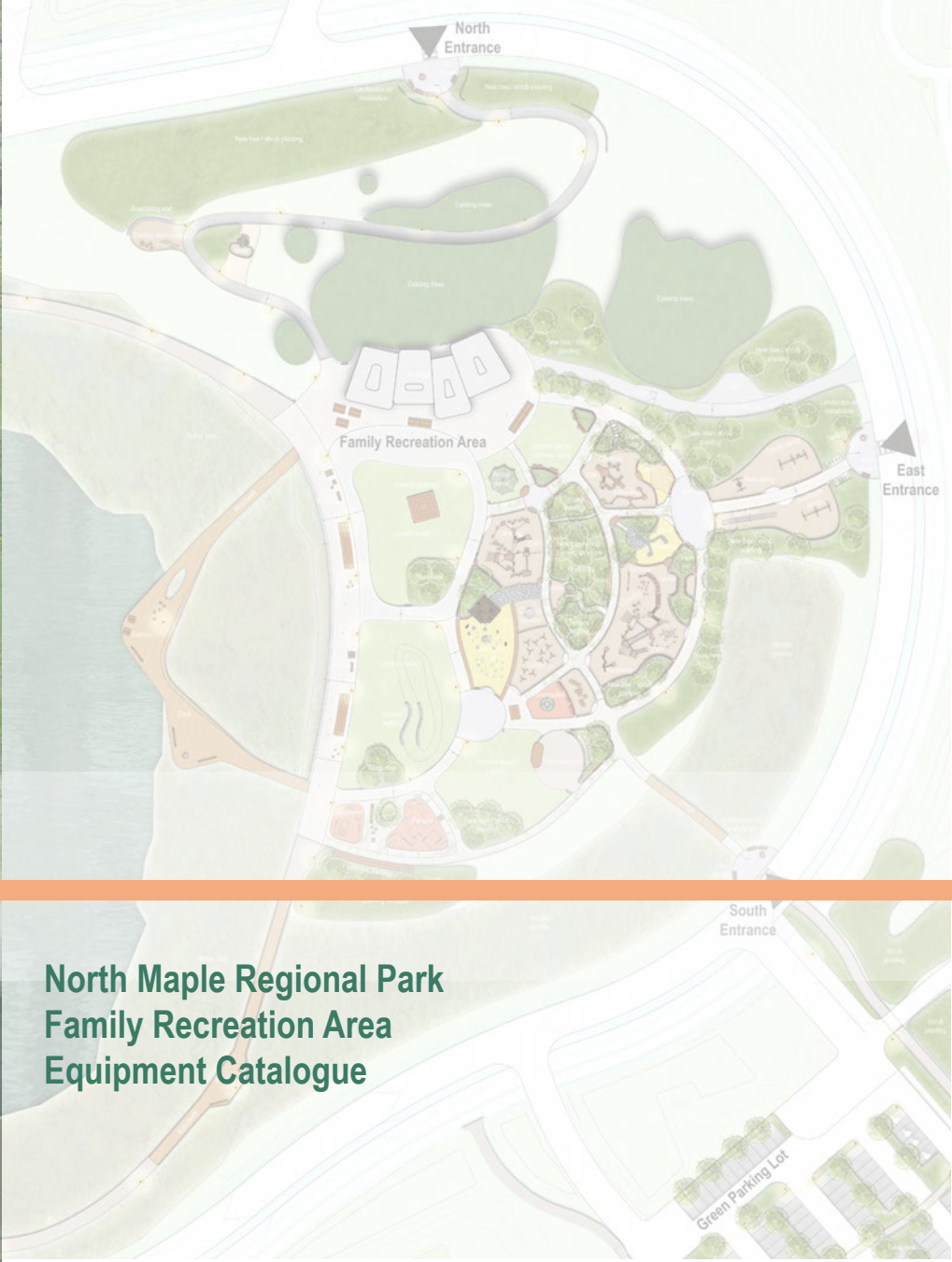

**North Maple Regional Park  
Family Recreation Area  
Equipment Catalogue**



- Opportunity to develop essential motor skills
- Development of balance and coordination
- Usage of natural materials, uncut logs, hardwood
- Suitable for a variety of ages

Ages 18 months - 5 years

Low climber



Tunnel



Climber



Balance logs



Ages 18 months - 5 years

Slide



Swings





Ages 5 - 12 years

Climber



Climbing boulder



Belt path



See saw



Age 12+ years

Green gym

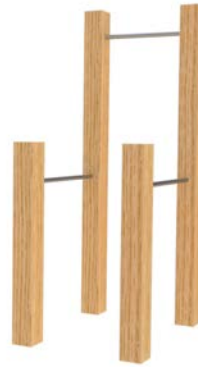

Parkour





- No risk is itself a risk
- Opportunity to develop children's essential motor skills
- Offer variety and graduated challenges
- As safe as necessary



- Unique play opportunities
- Development of social skills



Materials for creating  
with the imagination

Ages 5 - 12 years

Forest Fountains



See saw pumps



Ages 5 - 12 years

Active water play - Pumps, Trays, and the Archimedean screw









Wooden seating platform

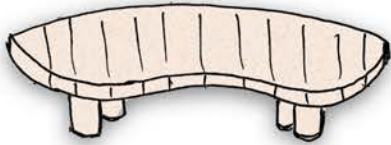

Loungers



„Drifter“ bench

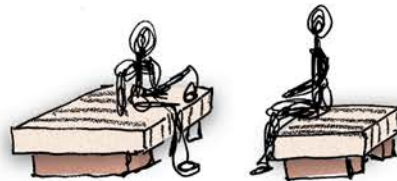
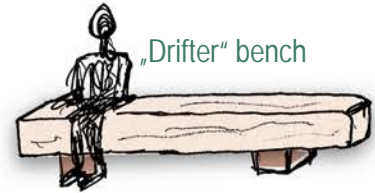

Seating cubes

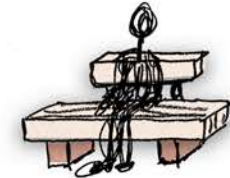

Standard bench

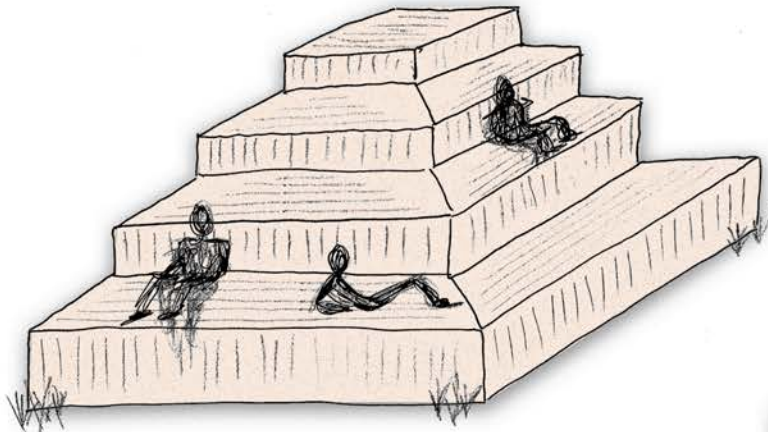

Seating pyramide

Terraced seating

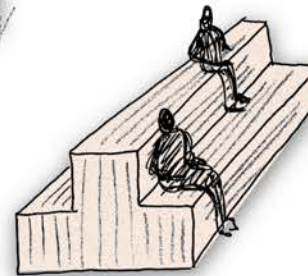

All seating elements are made of hardwood

## SEATING ELEMENTS

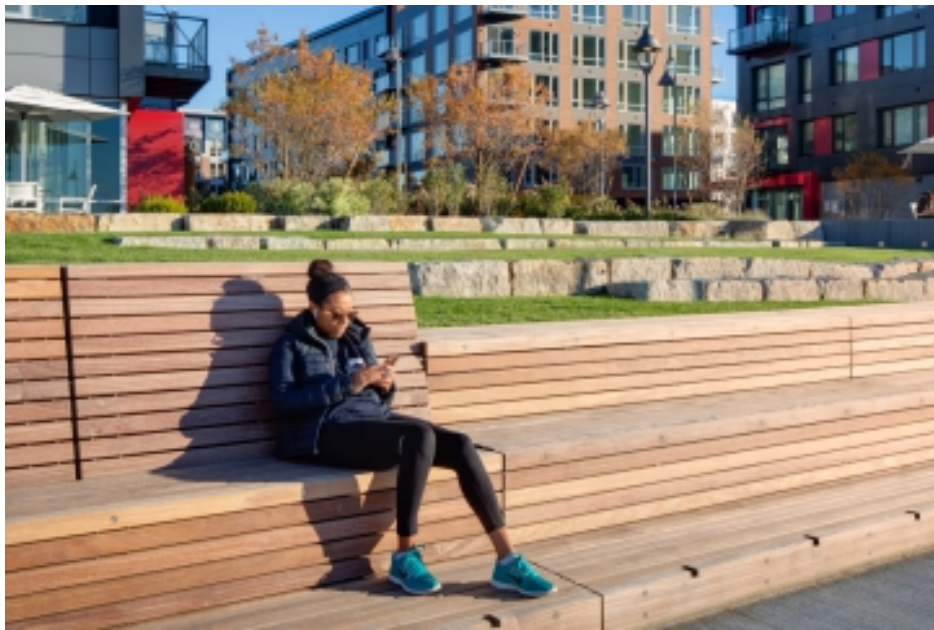





- Informal seating
- Multiple uses
- Play island

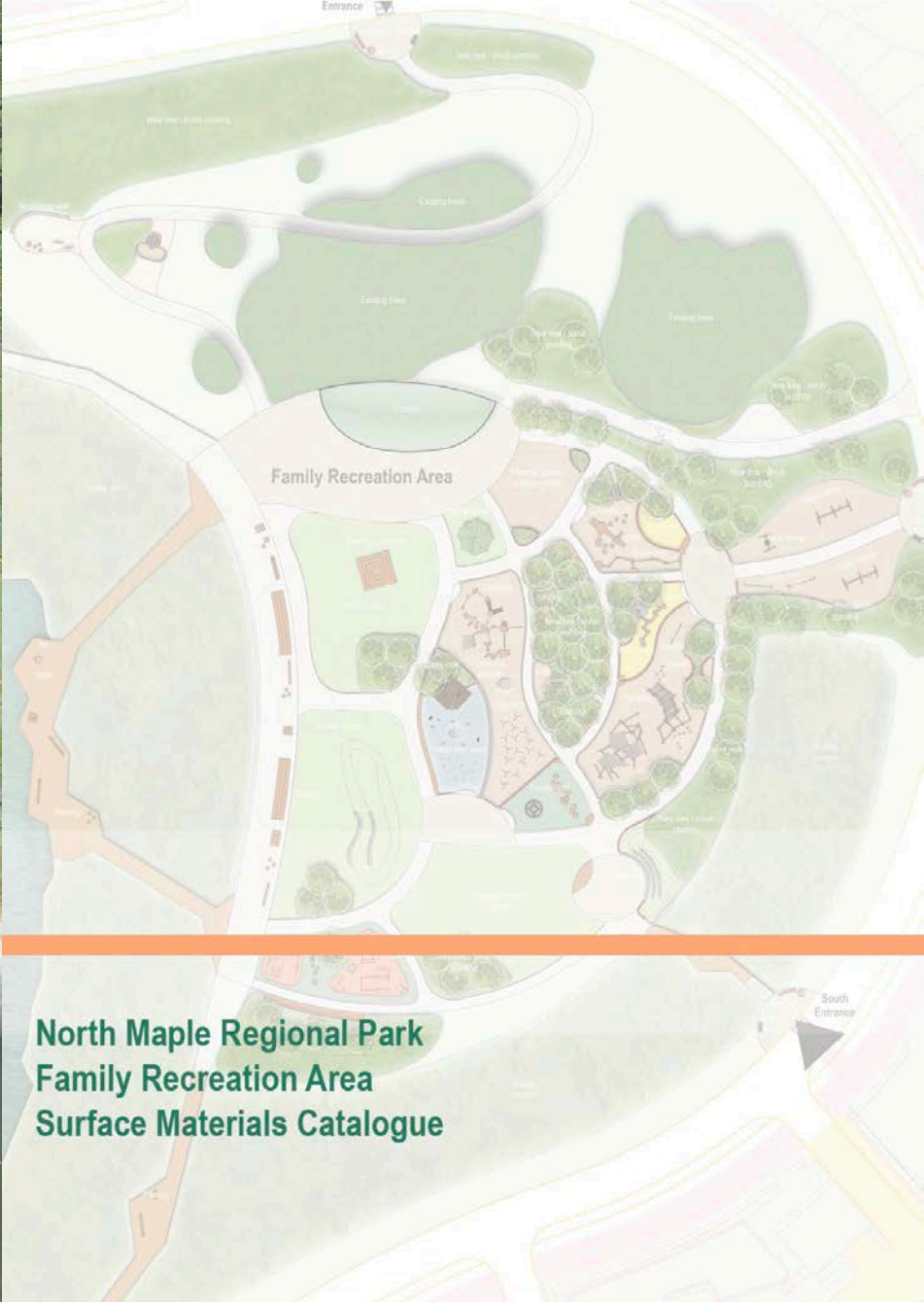

**North Maple Regional Park  
Family Recreation Area  
Surface Materials Catalogue**

A mix of surfaces: Accessible and permeable



Multiple uses

Unique character

Retainment of sand and soil

Seating

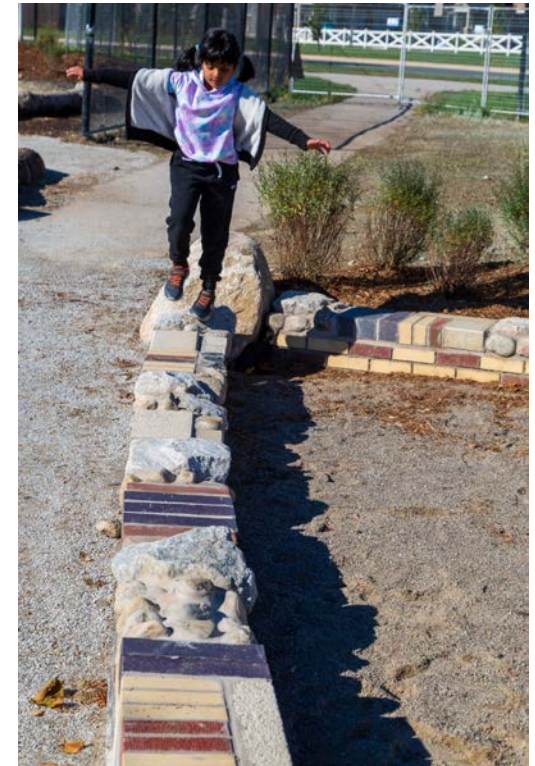

Natural materials  
Unique character  
Retention of sand and soil  
Seating





## Reuse of available materials on site (Hardwood Robinia)

---

Knee-height fencing



Balancing structure





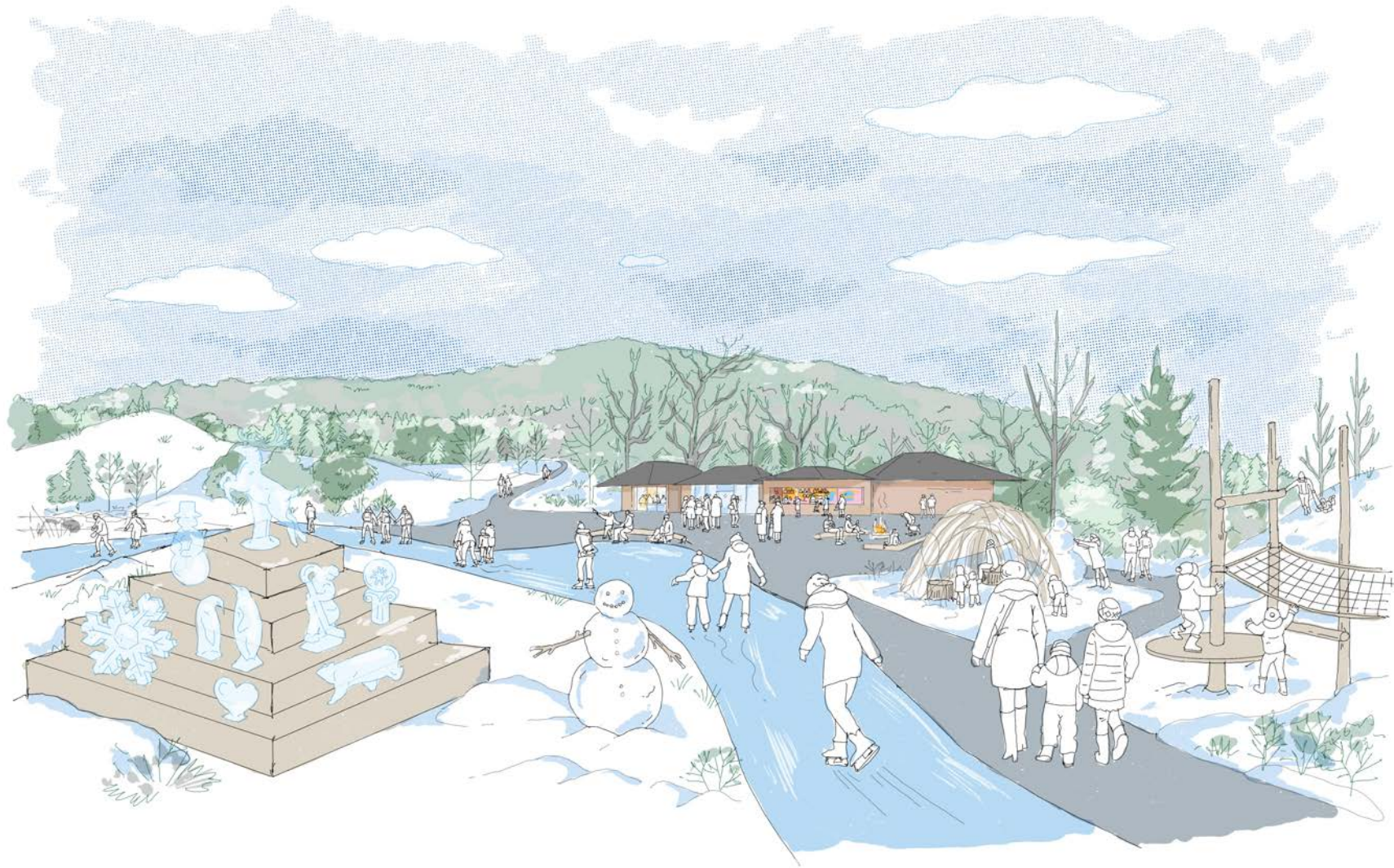

# Site Access

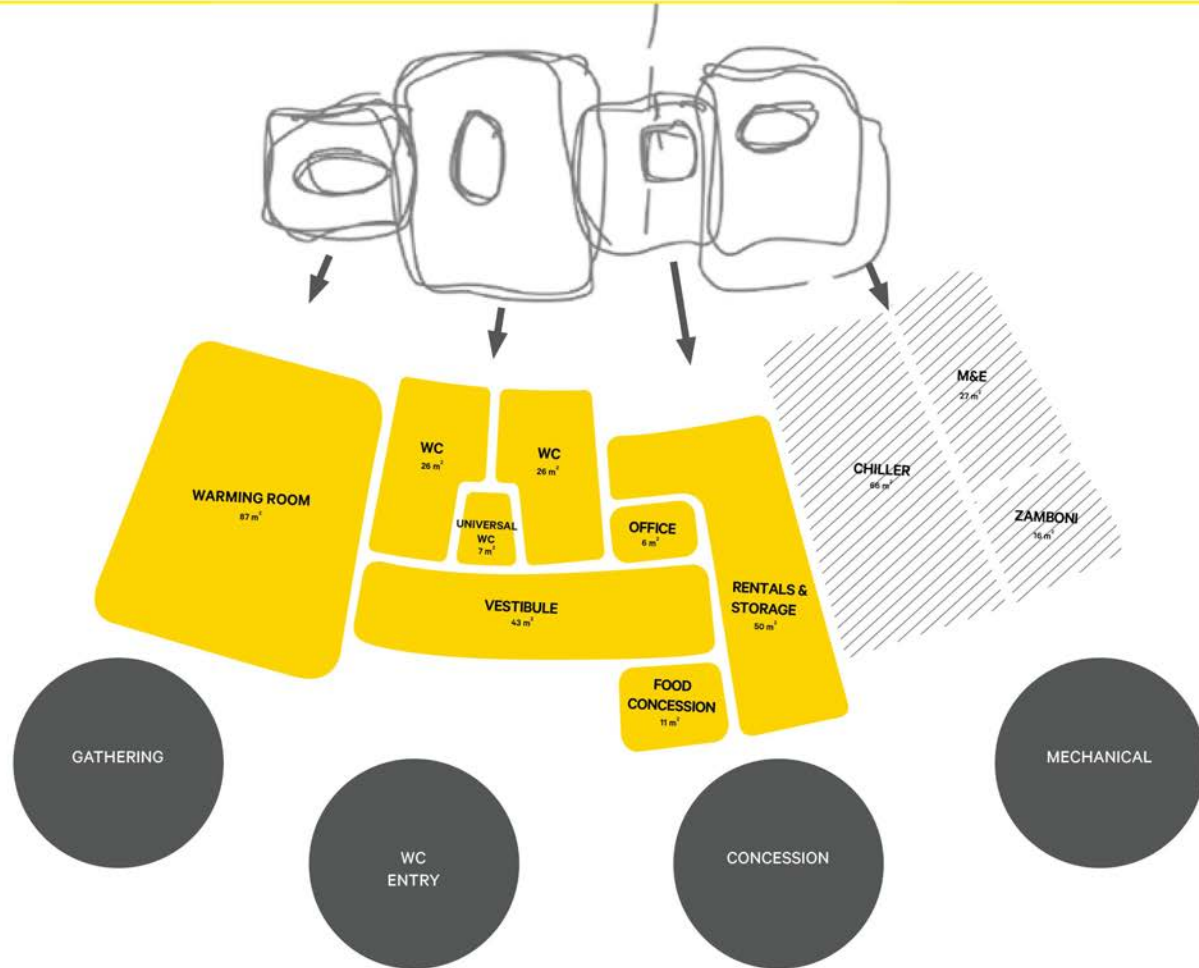

SvN

## Concept

---



SvN















# Precedent Analysis

---



Chatfield District Park



MacKenzie Glen District Park



Doctors McLean District Park



Sonoma Heights



Veneto Centre

SvN

# Precedent Analysis

Belair Way Park



**45 sq m**

4 tables  
24 people

Chatfield District Park



**104 sq m**

8 tables  
48 people

MacKenzie Glen District Park



**120 sq m**

10 tables  
60 people

Doctors McLean District Park

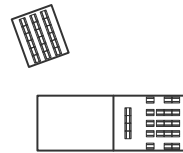

**355 sq m**

40 tables  
240 people

Sonoma Heights



**609 sq m**

Veneto Centre

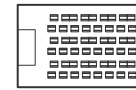

**585 sq m**

50 tables  
300 people

**Current Design**



**540 sq m**

50 tables  
300 people

SvN

## Integration of Water- Precedents

---



Sanderumgaard Pavillion, SQ1



The Serpentine Pavilion 2011 by Peter Zumthor

SvN

# Views

---



SvN

# Views

---



SvN



# Integration of Water

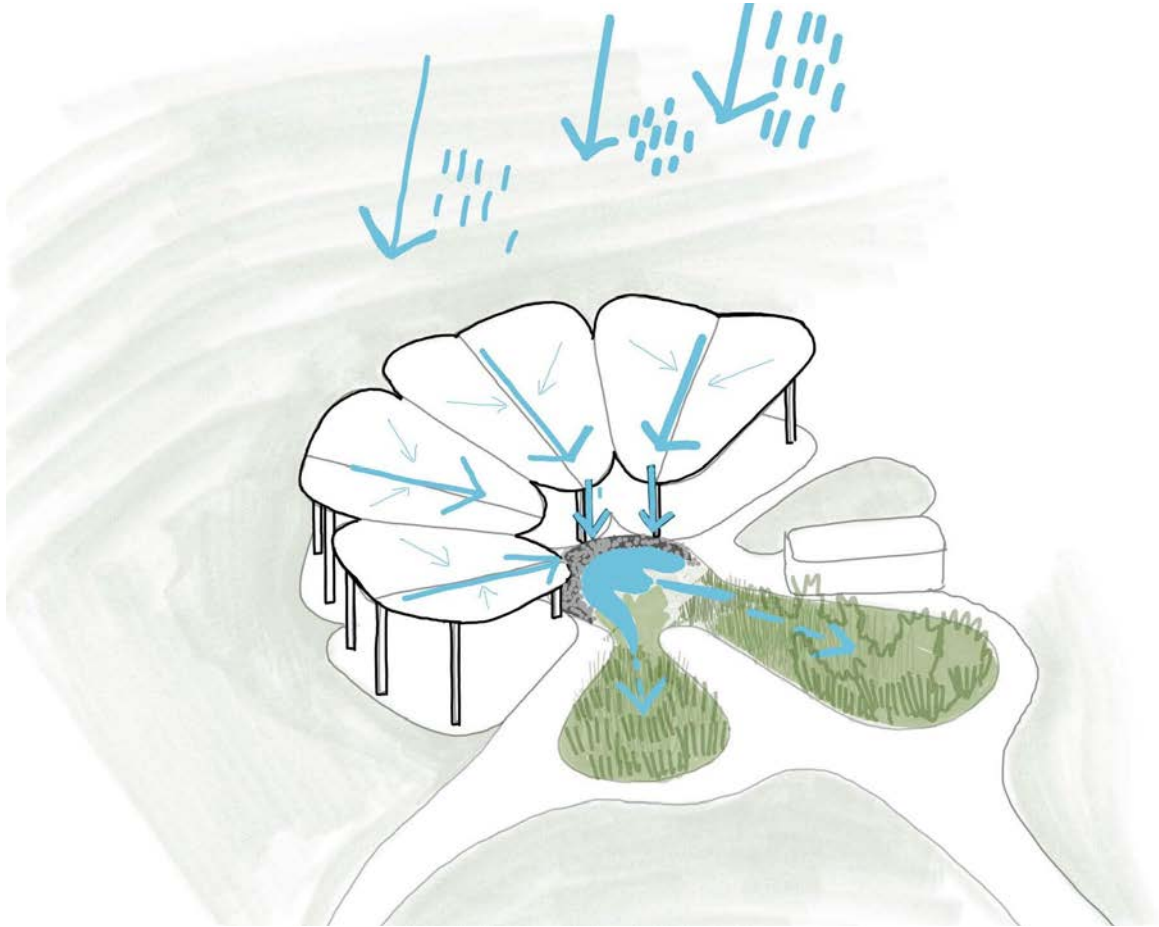

SvN

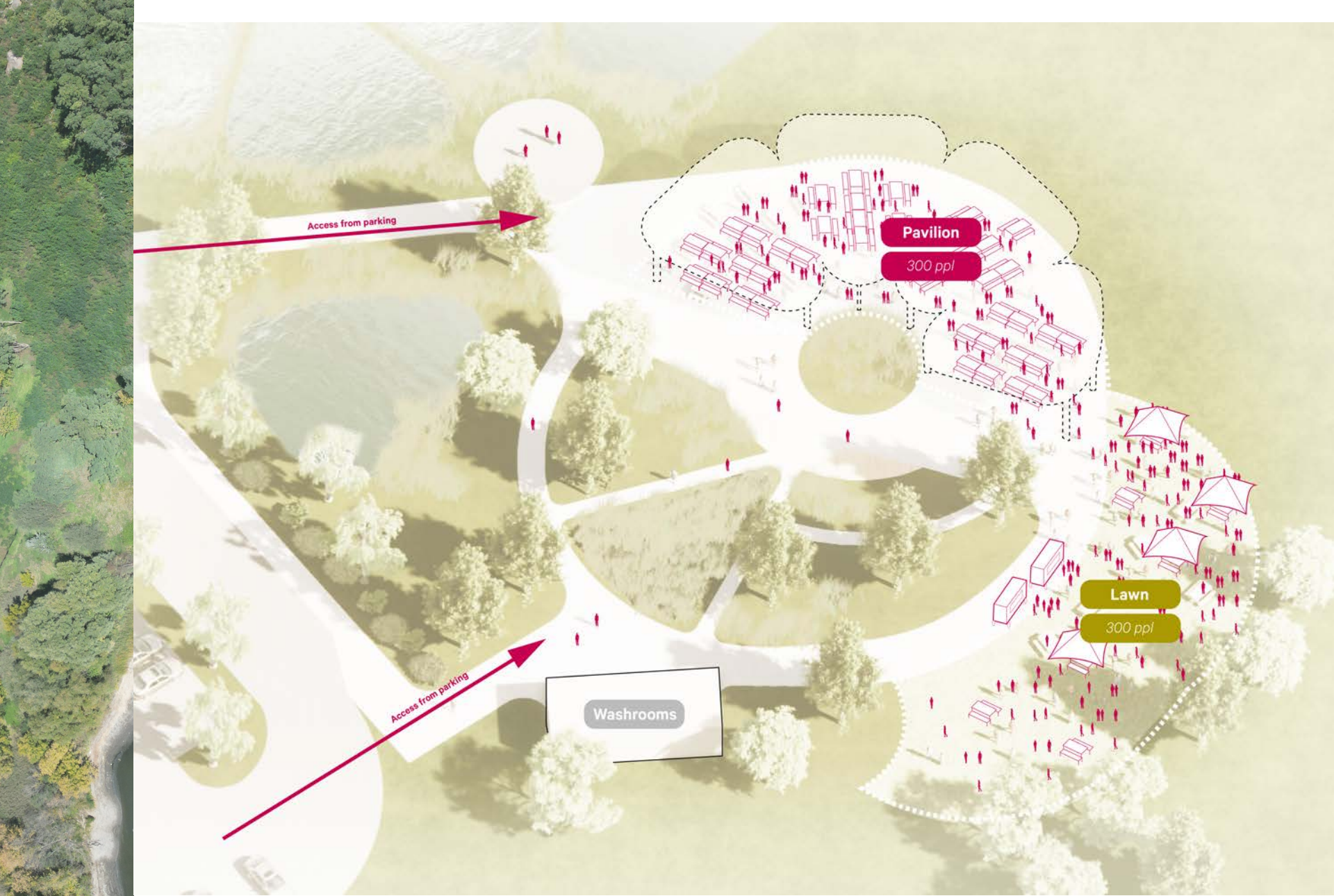





-  RAIN GARDEN / STORMWATER MANAGEMENT CELL
-  NATIVE PERENNIAL GARDEN
-  NATURALIZED AREA







## NEXT STEPS

- May - Contractor pre-qualification being issued
- May - Feedback on 30% design package
- Q3 - 60% Design submission and feedback
- Q4 - Final design submission and tender
- 2025 - Construction start
- 2026 - Construction completion



# QUESTIONS AND DISCUSSION