

3310 Steeles Avenue Woodbridge

File Number B002/22

Consent to Lease

Location

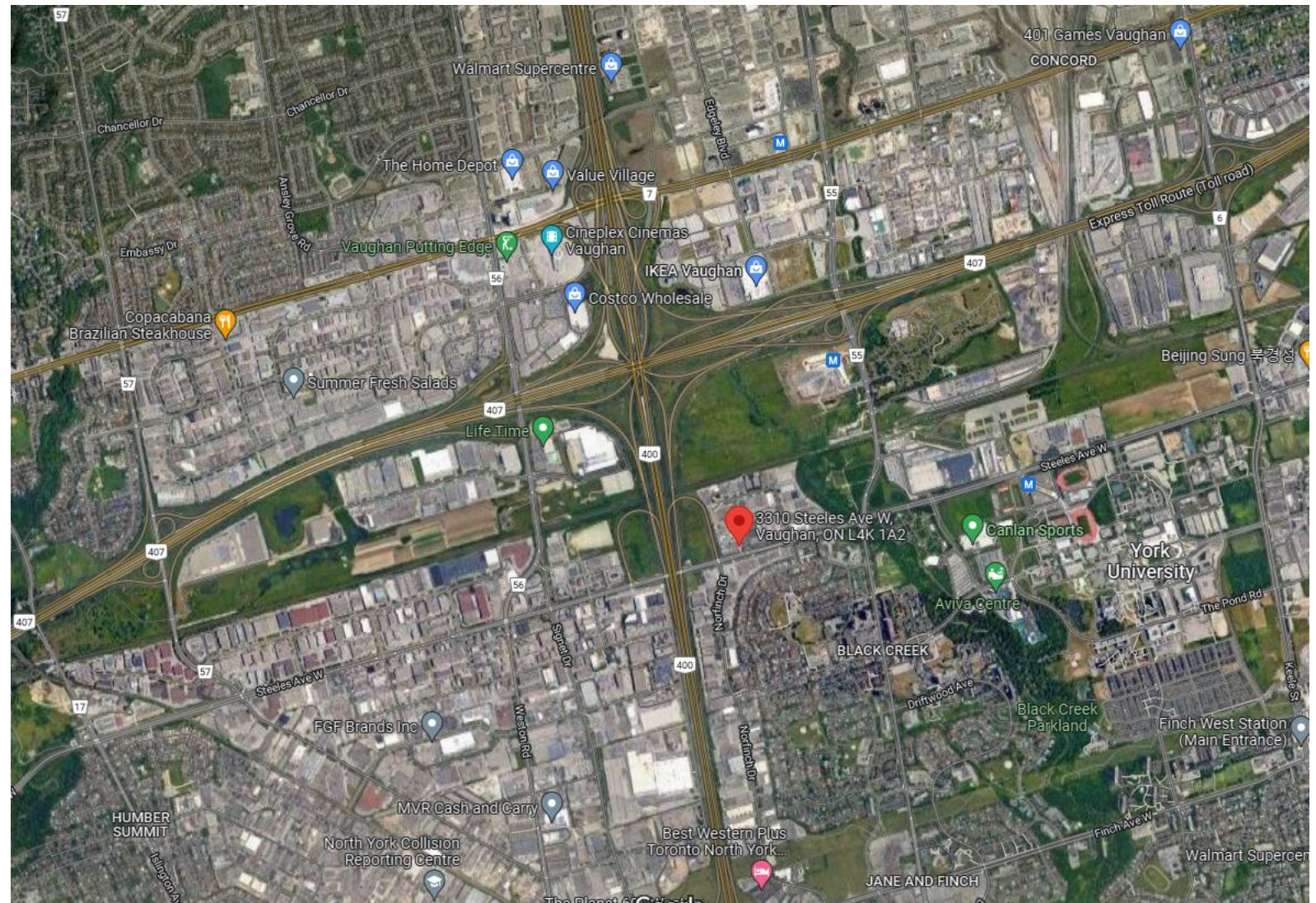

Purpose of the Application

- Consent to Lease application to permit a lease in excess of 21 years for a lease associated with the premises in favour of the TDL Group Corp.
- The proposed use will continue as a Tim Hortons' Restaurant and no new development is proposed.

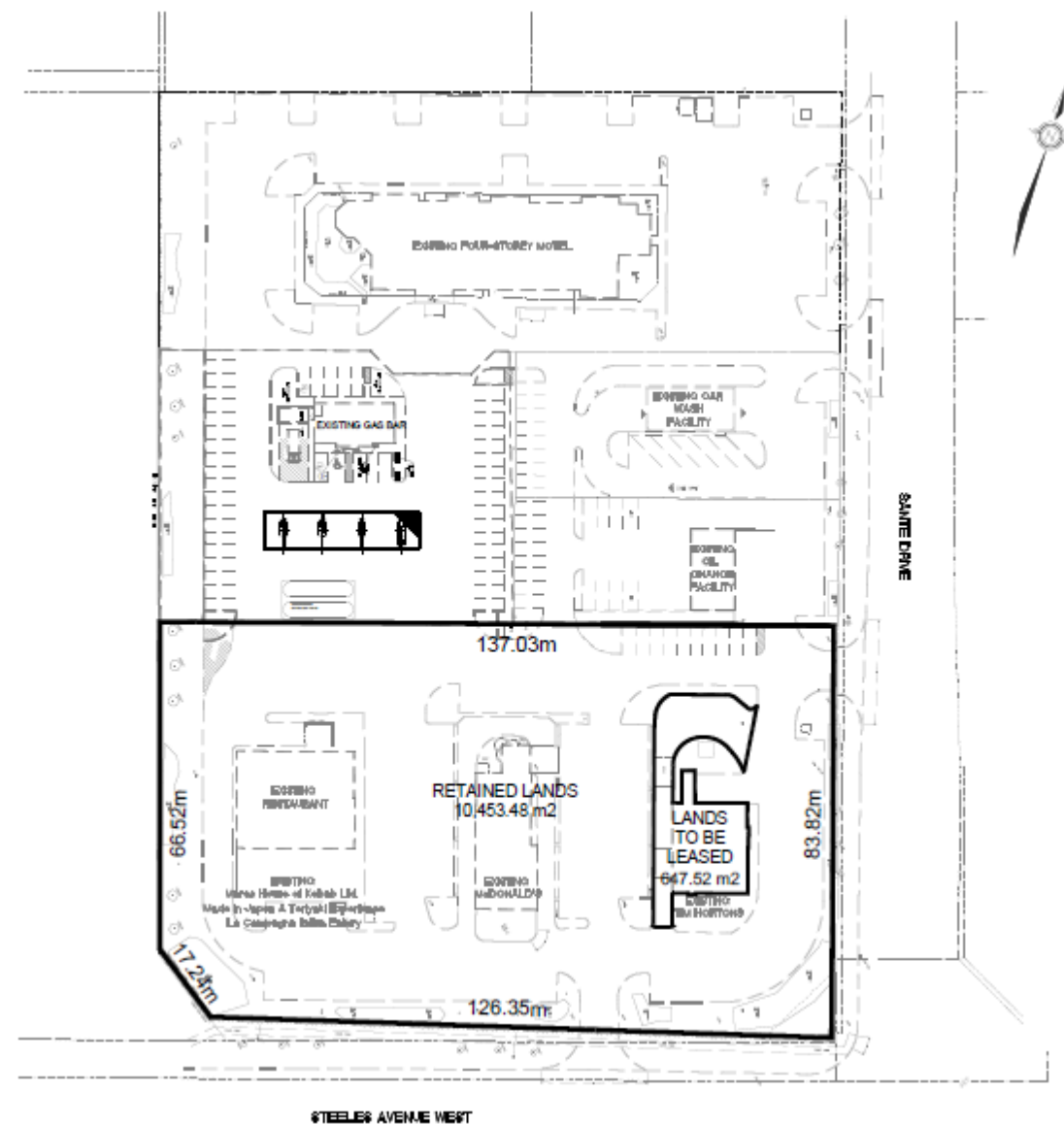

Questions?

- Presentation by: Alyssa Woods and Mark Yarranton
of **KLM Planning Partners Inc.**
- Contact information: awoods@klmplanning.com
myarranton@klmplanning.com