

# COMMITTEE OF ADJUSTMENT HEARING

9773 Keele Street

October 28, 2021

CITY OF VAUGHAN  
VIRTUAL HEARING

Consent Application B019/21

**WESTON**  
CONSULTING





# SUBJECT PROPERTY



# PROPOSED EASEMENTS

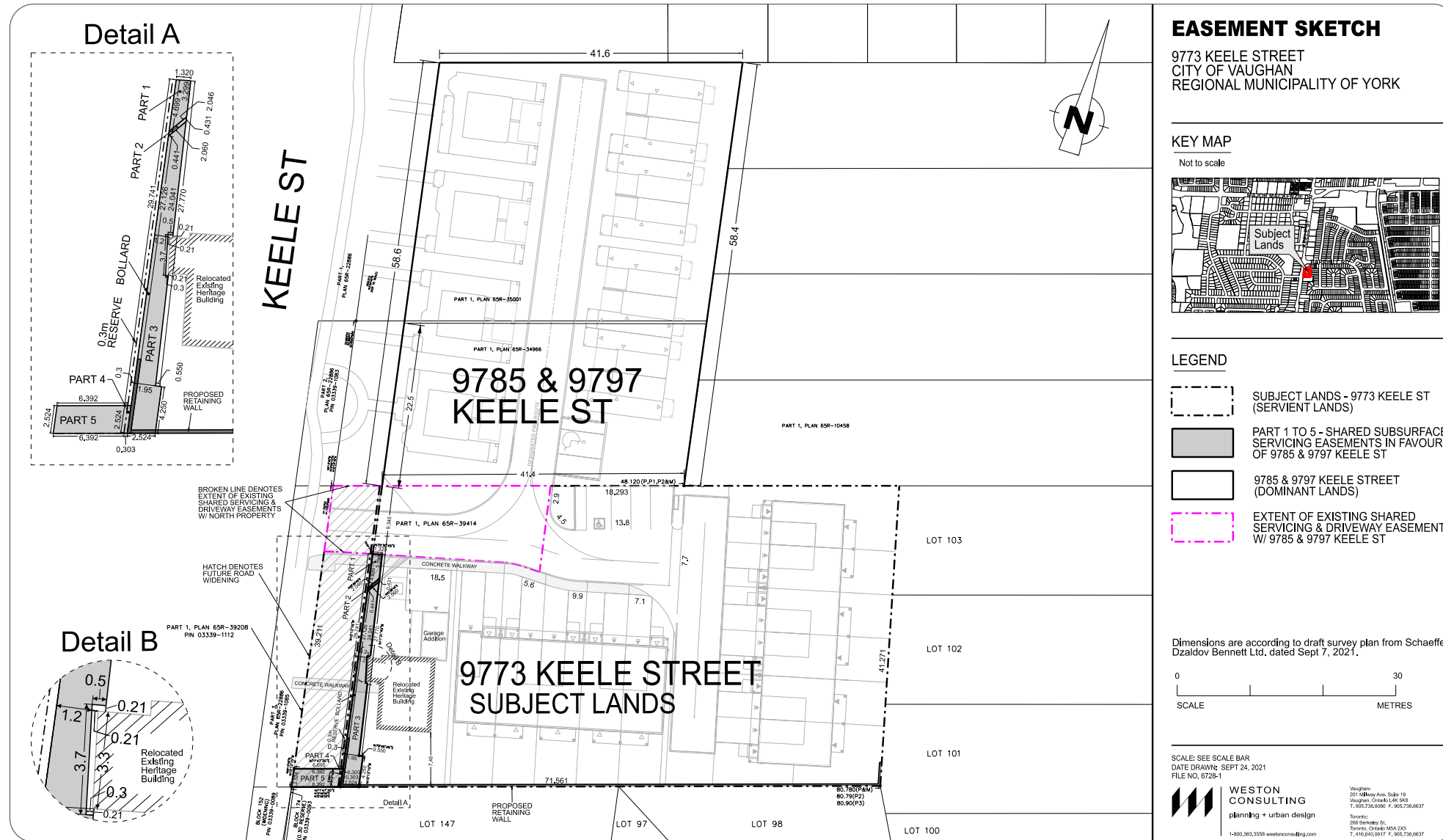



# TREE PROTECTION PLAN

**GENERAL NOTES:**

WORK REQUIRED TO OCCUR WITHIN A TREE PROTECTION ZONE (TPZ) SHALL CONFORM TO THE FOLLOWING ADDITIONAL REQUIREMENTS:

- A QUALIFIED TREE PROFESSIONAL MUST BE PRESENT FOR ALL WORK WITHIN THE IDENTIFIED TREE PROTECTION ZONES.
- YORK REGION NATURAL HERITAGE AND FORESTRY STAFF (ALEXANDRA.RYLAND@YORK.CA) SHALL BE NOTIFIED WITH 24HRS NOTICE PRIOR TO WORKING WITHIN THE TREE PROTECTIONS ZONES.
- THE TREE PROTECTION BARRIER SHALL NOT BE MOVED AT ANY TIME DURING CONSTRUCTION UNLESS WITH THE OVERSIGHT OF A QUALIFIED TREE PROFESSIONAL.
- ROOT ZONE COMPACTION PROTECTION PROVISIONS MUST BE FOLLOWED
- ROOT SENSITIVE EXCAVATION PROVISIONS MUST BE FOLLOWED
- AFTER THE COMPLETION OF CONSTRUCTION, SOIL COMPACTION AND RESTORATION PROVISIONS SHALL BE FOLLOWED WHEN DEEMED NECESSARY BY YORK REGION NATURAL HERITAGE AND FORESTRY STAFF.

 THE PORTIONS OF THE TPZ OTHER THAN THE APPROVED TREES # 108 & 146 THAT ARE ENCRACHED UPON.



The Tree Specialists Inc.

**The Tree Specialists Inc.**

**LEGEND**

- Tree to be preserved
- ✕ Tree to be removed
- Prescribed TPZ
- Tree Protection Hoarding

**KEY MAP**



SCALE	SHEET NUMBER
1:100	TPP-1
PLOT DATE	
10/25/20	
FILE NAME	
9773 Keele Street (York Region Keele Street right-of-way) Vaughan, ON	



# SITE SERVICING PLAN

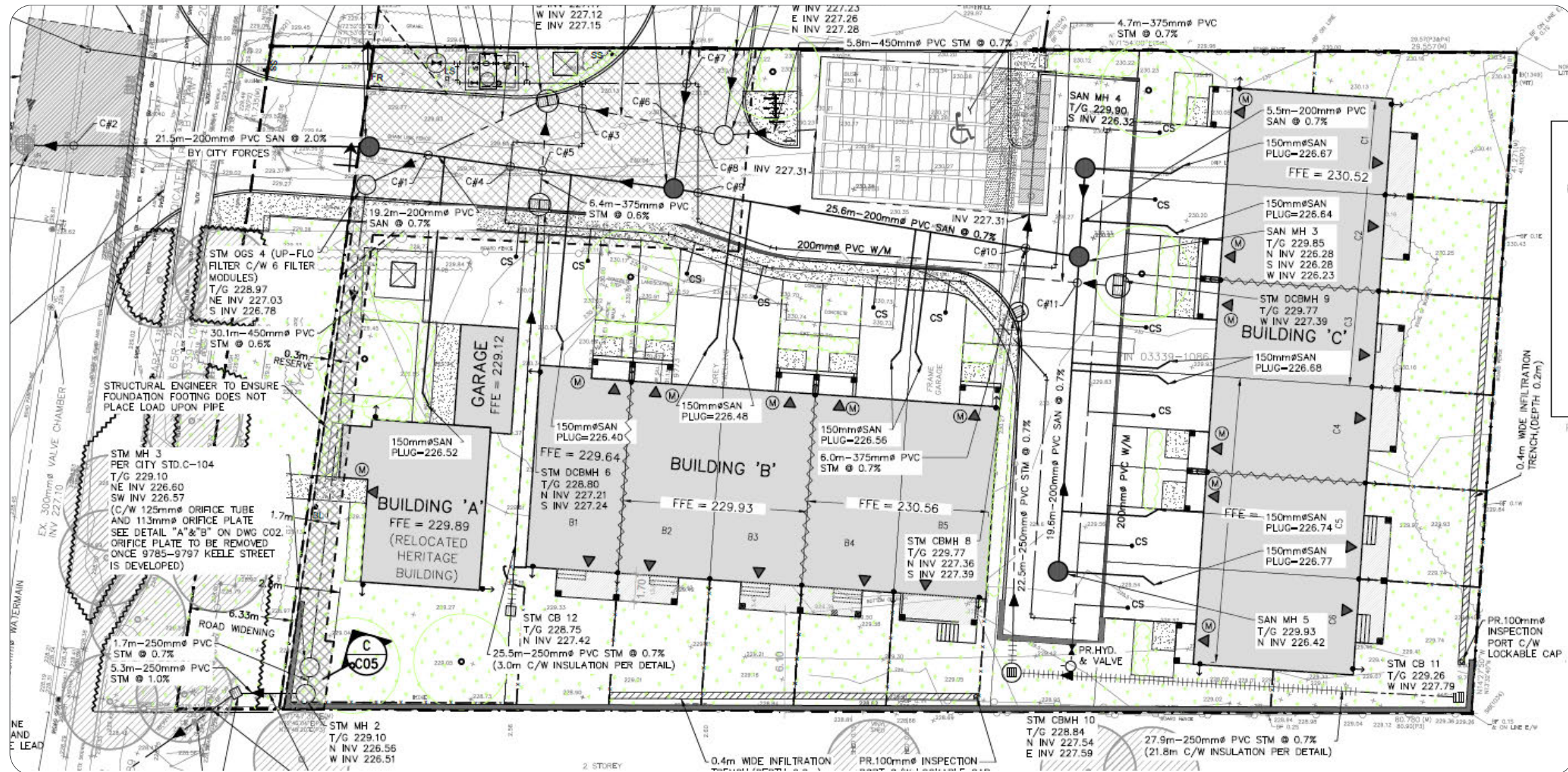

# Thank You

## Comments & Questions?

**Ryan Guetter**

**Weston Consulting**

905-738-8080 ext. 241

[rguetter@westonconsulting.com](mailto:rguetter@westonconsulting.com)

**Steven Pham**

**Weston Consulting**

905-738-8080 ext. 312

[spham@westonconsulting.com](mailto:spham@westonconsulting.com)

