

- LEGEND:
- PROPOSED LANDSCAPE AREA
 - TREE PROTECTION HOARDING
 - TREES TO REMAIN

- (2) Ulmus x 'Pioneer'
- (1) Acer saccharum
- (1) Magnolia X soulangiana
- (7) Buxus 'Green Velvet'
- (13) Taxus x media 'Hicksii'
- (1) Acer saccharum
- (1) Magnolia X soulangiana
- (5) Taxus x media 'Hicksii'

No.	Date (DD/MM/YY)	Issue	By
3	29/06/23	REISSUED FOR HERITAGE VAUGHAN COMMITTEE	YY
2	21/06/23	ISSUED FOR HERITAGE VAUGHAN COMMITTEE	YY
1	17/02/23	ISSUED FOR REVIEW	YY

POPOVICH ASSOCIATES
 1 Robert Speck Parkway, Suite 100
 Mississauga, Ontario L4Z 3M1
 T. 905.270.2229 F. 905.270.2190
 info@popovich.ca

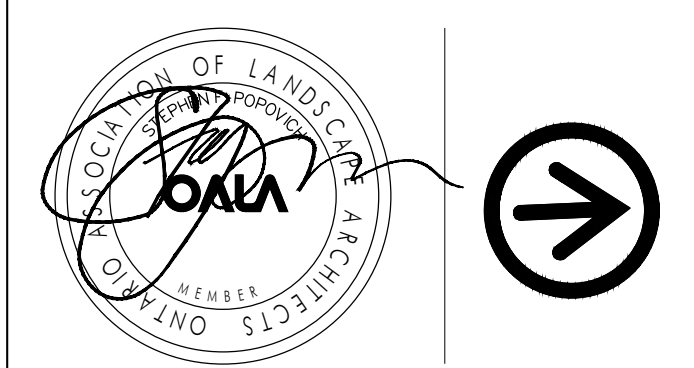

The contractor will check and verify all dimensions and job conditions on the site and report any discrepancies to the Landscape Architect prior to the commencement of construction.
 This drawing must not be used for construction purposes until signed by the Landscape Architect.
 All drawings are the property of the Landscape Architect and may not be copied, reproduced or altered without written permission from the Landscape Architect.
 DO NOT SCALE DRAWING

Project Info:
 717 Nashville Rd
 717 Nashville Rd, Woodbridge ON

Owner Info:
 Birchberry Estates Inc.

3300 Steeles Avenue West, Suite 9, Concord, ON

Sheet Title:
 Heritage Landscape Plan

Project Number: 1589
 Drawn By: YY
 Checked By: SP
 Date: FEB 2023
 Scale: AS NOTED

Sheet Number:
HP1

1 HERITAGE LANDSCAPE PLAN
 HP1 1:100

DECIDUOUS TREES								
QUANTITY	BOTANICAL NAME	COMMON NAME	SIZE-CAL	ROOT	REMARKS	DROUGHT TOLERANCE	SOIL SALT TOLERANCE	NATIVE
4	Acer Saccharum	Sugar Maple	60mm Cal.	W.B.	Straight trunk, evenly branched crowns	MOD	LOW	YES
4	Carpinus betulus 'Fastigiata'	Pyramidal European Hornbeam	60mm Cal.	W.B.	Straight trunk, evenly branched crowns	HIGH	MOD	NO
2	Magnolia X soulangiana	Saucer Magnolia	250 HT	W.B.	Specimen, Evenly branched, Min. 3 Canes	HIGH	MOD	YES
2	Ulmus x 'Pioneer'	Pioneer Elm	60mm Cal.	W.B.	Straight trunk, evenly branched crowns	HIGH	LOW	YES

CONIFEROUS SHRUBS								
QUANTITY	BOTANICAL NAME	COMMON NAME	SIZE-CAL	ROOT	REMARKS	DROUGHT TOLERANCE	SOIL SALT TOLERANCE	NATIVE
17	Buxus 'Green Velvet'	Green Velvet Boxwood	50 HT/5G	CONT.	Full, dense plant	MOD	LOW	NO
18	Taxus x media 'Hicksii'	Hicks Yew	60 HT/7G	CONT.	Full, dense plant	MOD	LOW	NO

2 PLANT SCHEDULE
 HP1 NTS

**ATTACHMENT 6
 717 NASHVILLE**



1 ELEVATION
HP2 1:75



2 ELEVATION
HP2 1:75

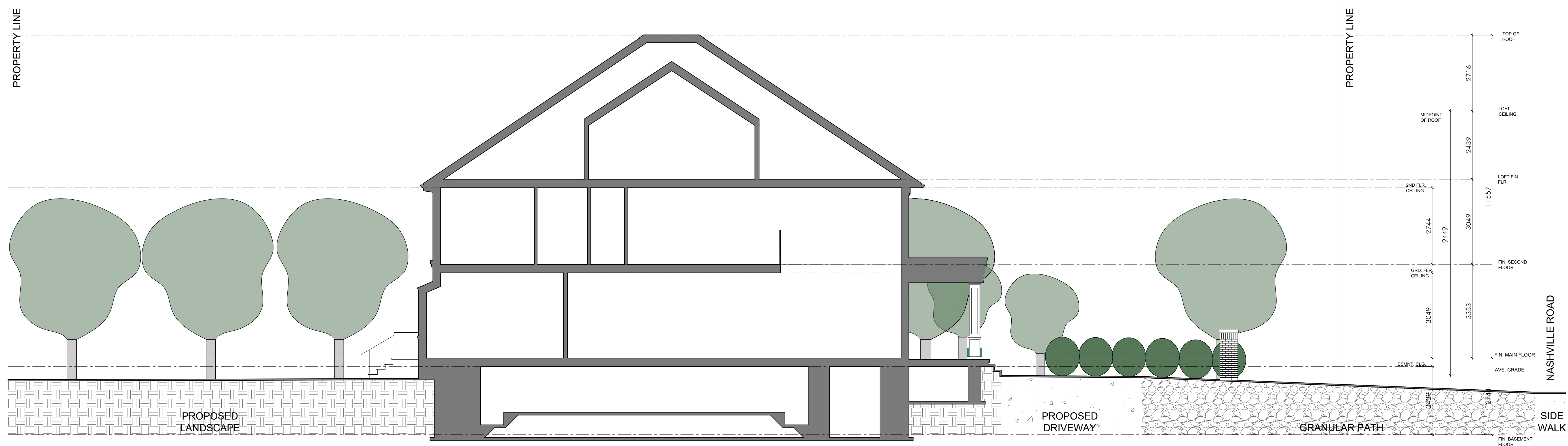

3 SECTION
HP2 1:75

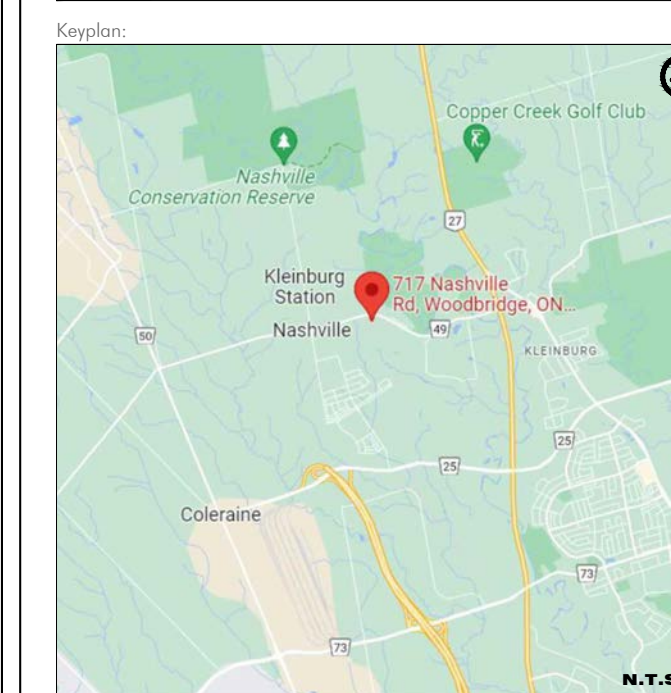

LEGEND:

No.	Date (D/M/Y)	Issue	By
3	29/06/23	REISSUED FOR HERITAGE VAUGHAN COMMITTEE	YY
2	21/06/23	ISSUED FOR HERITAGE VAUGHAN COMMITTEE	YY
1	17/02/23	ISSUED FOR REVIEW	YY

POPOVICH ASSOCIATES
 1 Robert Speck Parkway, Suite 100
 Mississauga, Ontario L4Z 3M3
 T. 905.270.2229 F. 905.270.2190
 info@popovich.ca



The contractor will check and verify all dimensions and job conditions on the site and report any discrepancies to the Landscape Architect prior to the commencement of construction.
 This drawing must not be used for construction purposes until signed by the Landscape Architect.
 All drawings are the property of the Landscape Architect and may not be copied, reproduced or altered without written permission from the Landscape Architect.
 DO NOT SCALE DRAWING.

Project Info:
 717 Nashville Rd
 717 Nashville Rd, Woodbridge ON
 Owner Info:
 Birchberry Estates Inc.

3300 Steeles Avenue West, Suite 9, Concord, ON

Sheet Title:
SECTIONS

Project Number: 1589
 Drawn By: YY
 Checked By: SP
 Date: FEB 2023
 Scale: AS NOTED

Sheet Number:
HP2

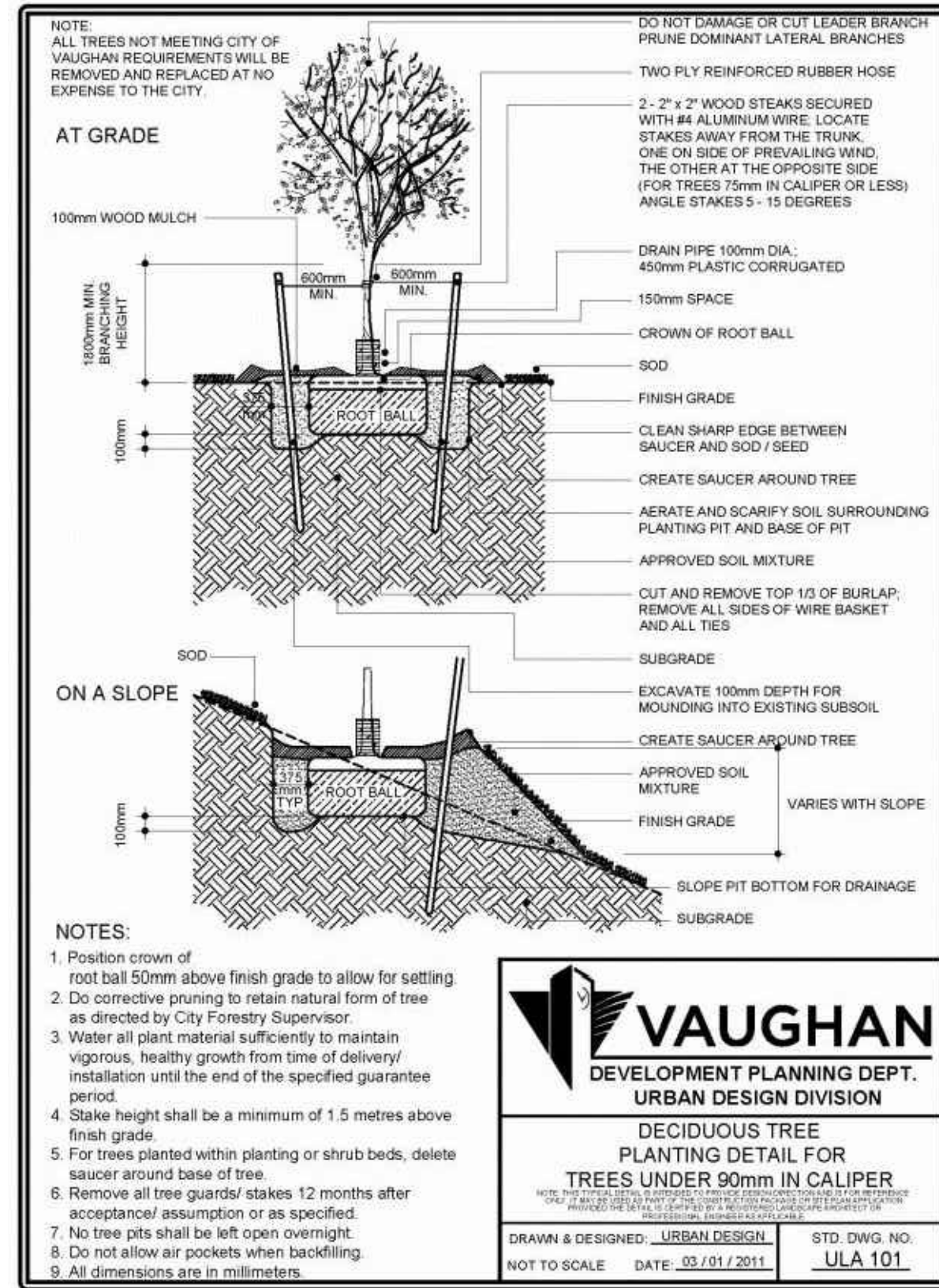

1
HP3
NTS
DETAIL - DECIDUOUS TREE PLANTING

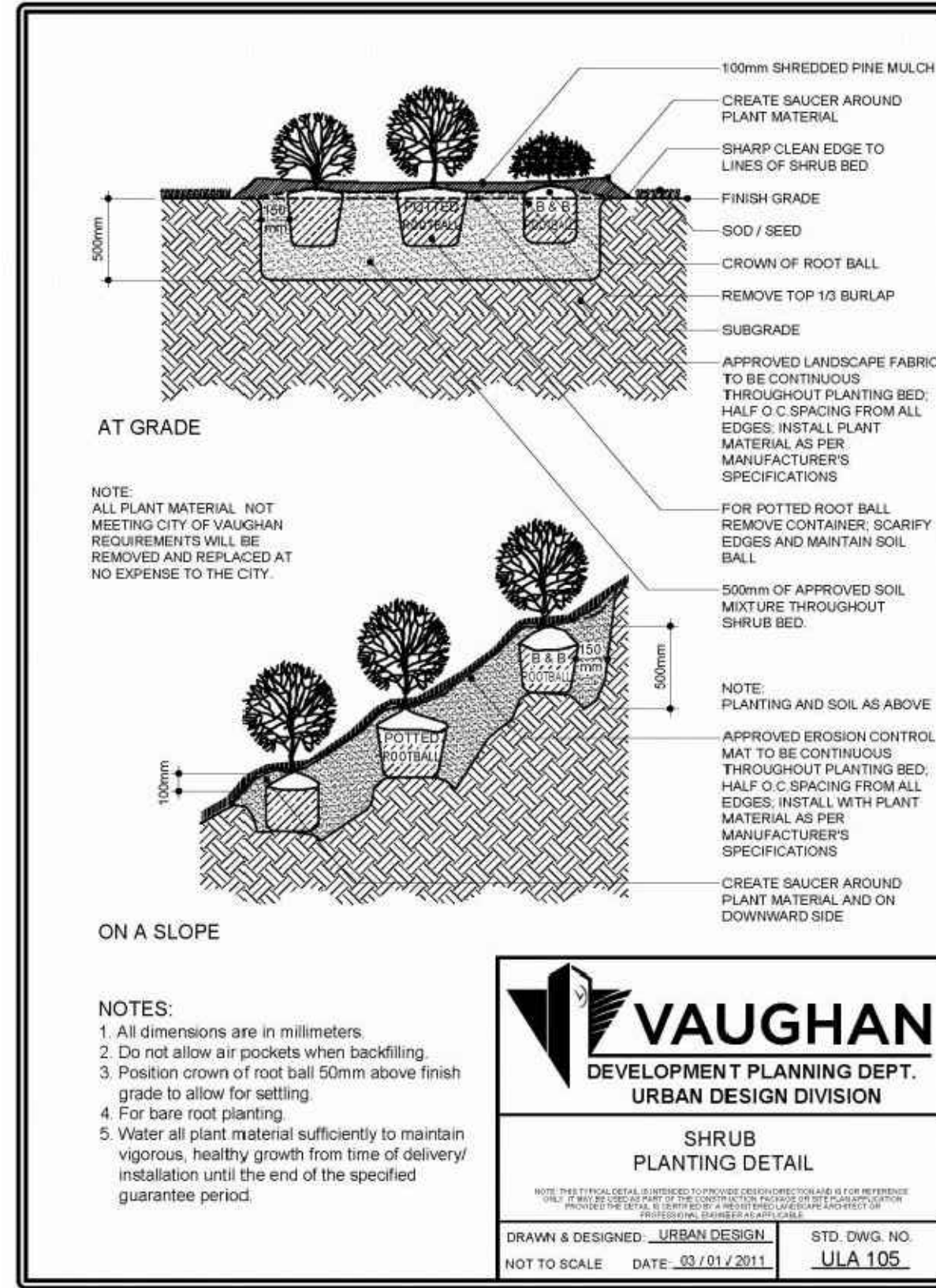

2
HP3
NTS
DETAIL - SHRUB PLANTING

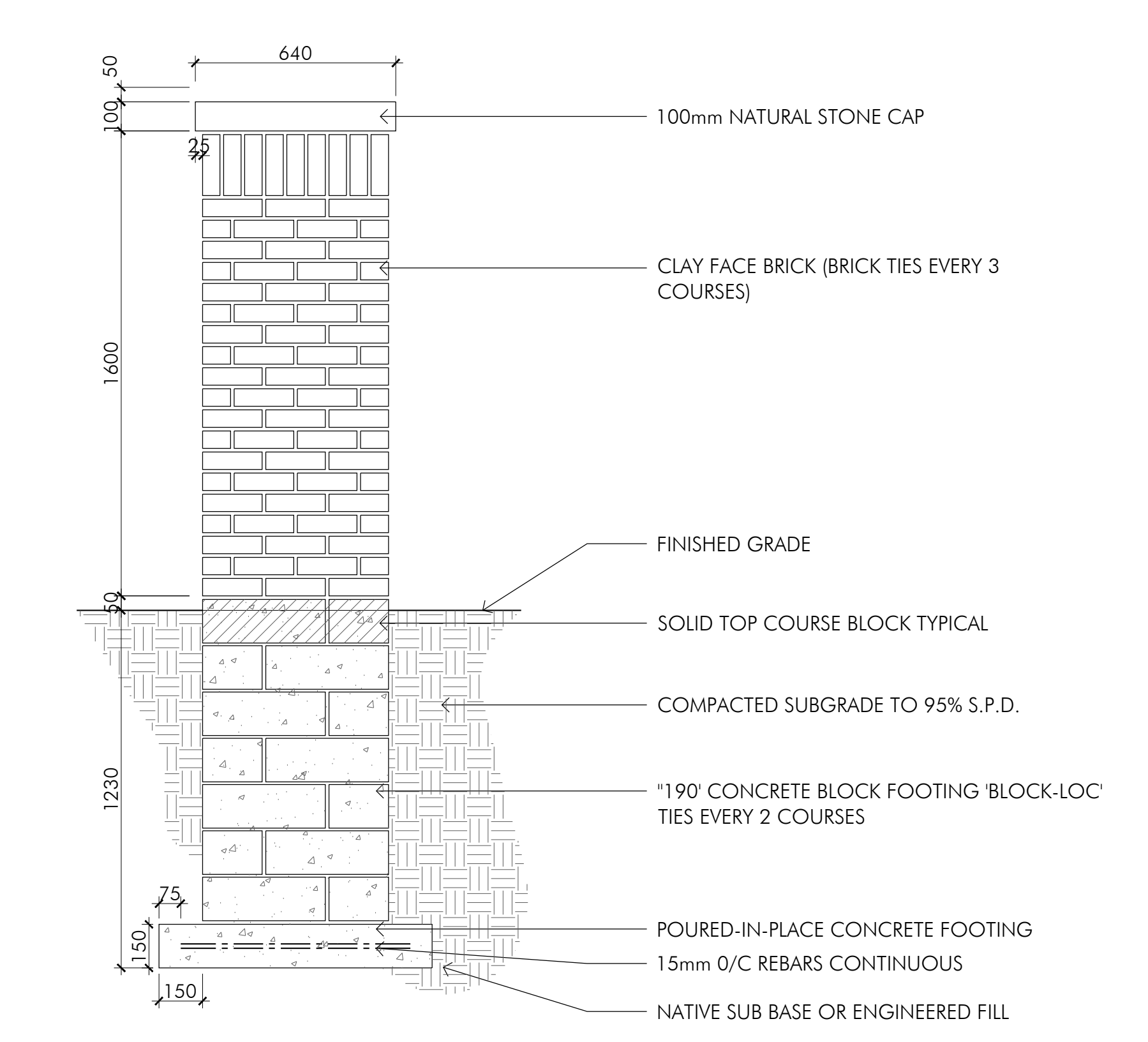

5
HP3
NTS
DETAIL - MASONRY PILLAR SECTION

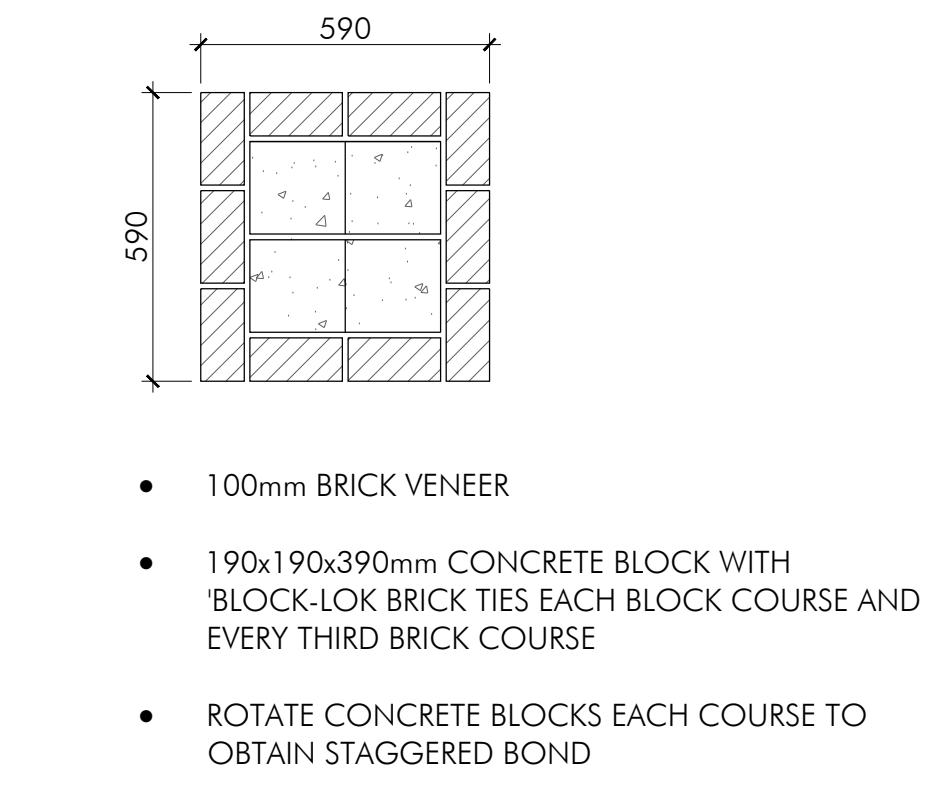

5
HP3
NTS
DETAIL - MASONRY PILLAR PLAN

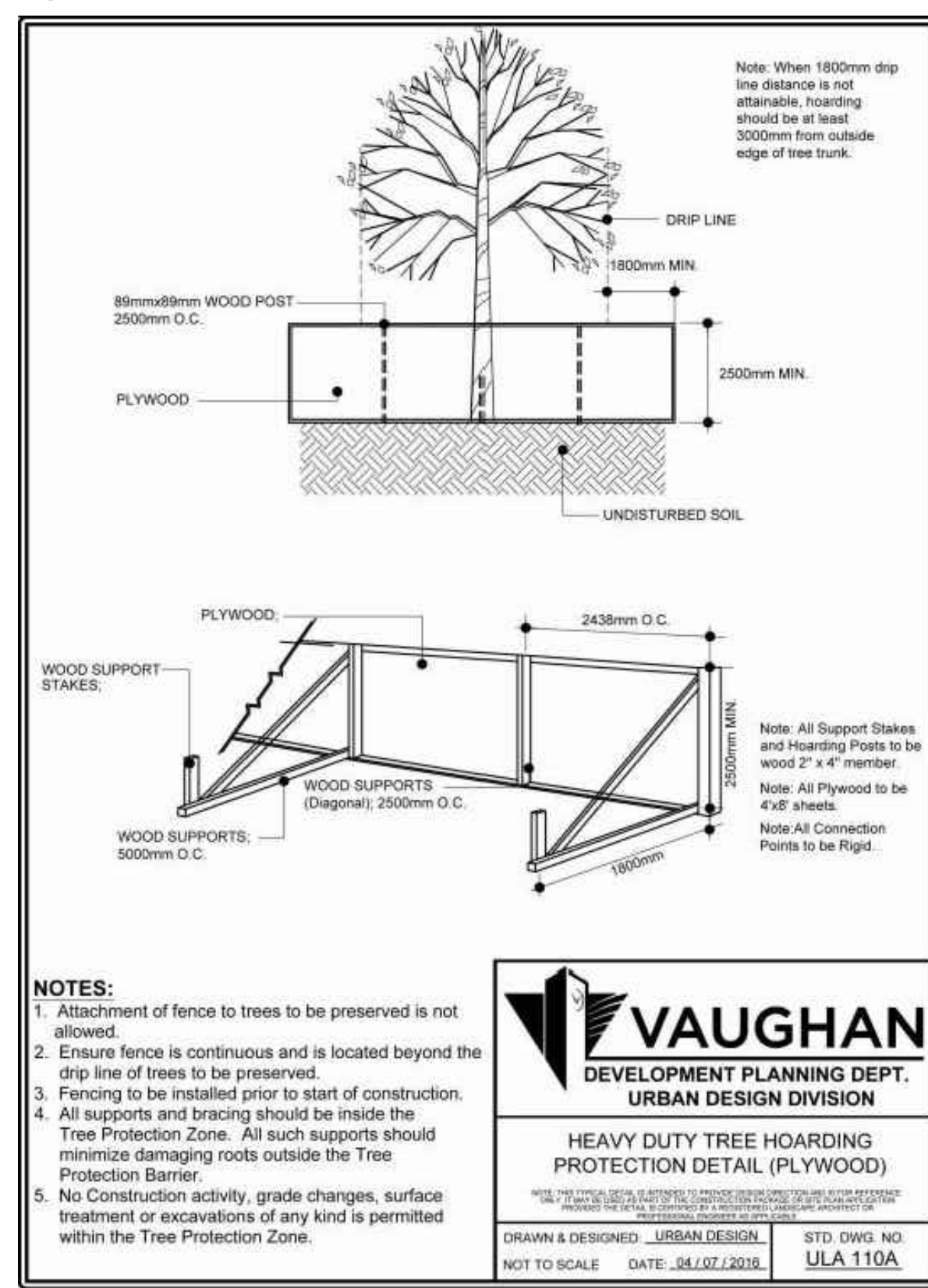

3
HP3
NTS
DETAIL - HEAVY DUTY TREE HOARDING

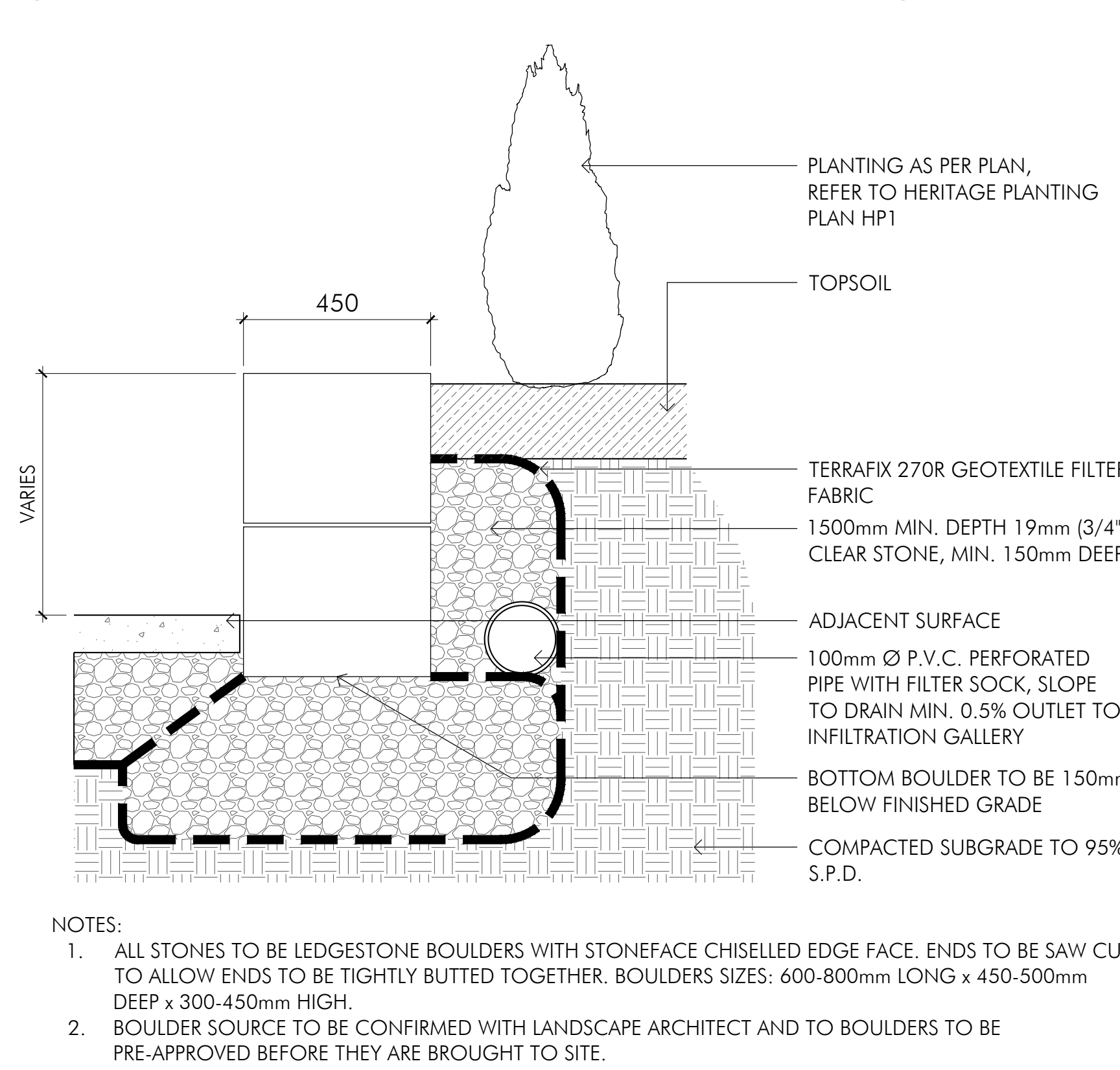

4
HP3
NTS
DETAIL - STONE/PLANTER WALL

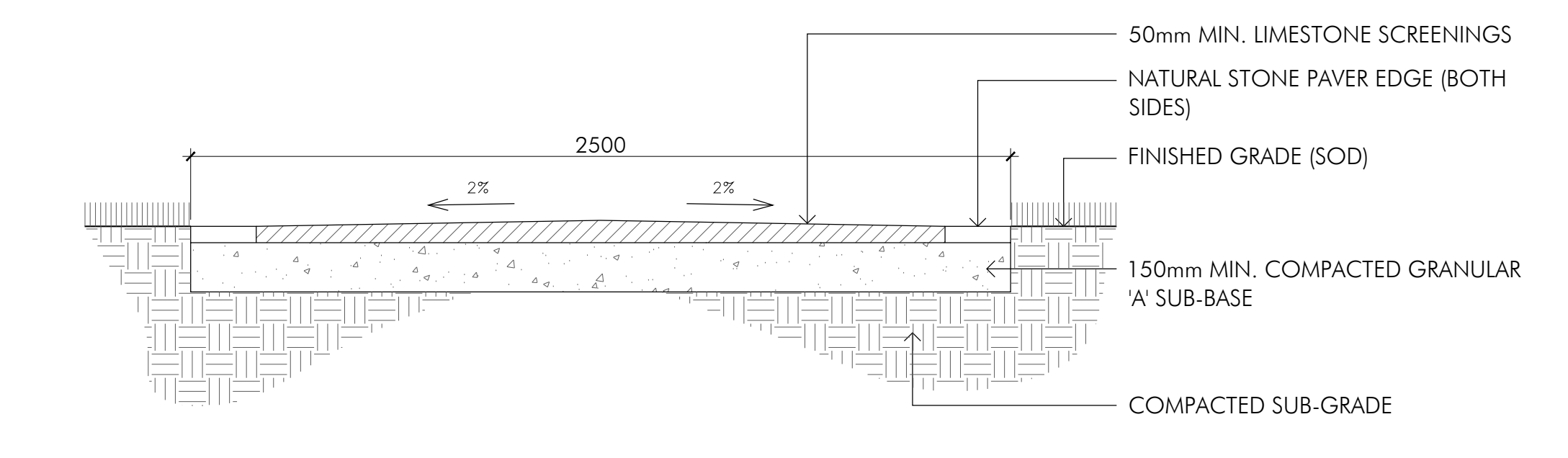

7
HP3
NTS
DETAIL - GRANULAR PATH

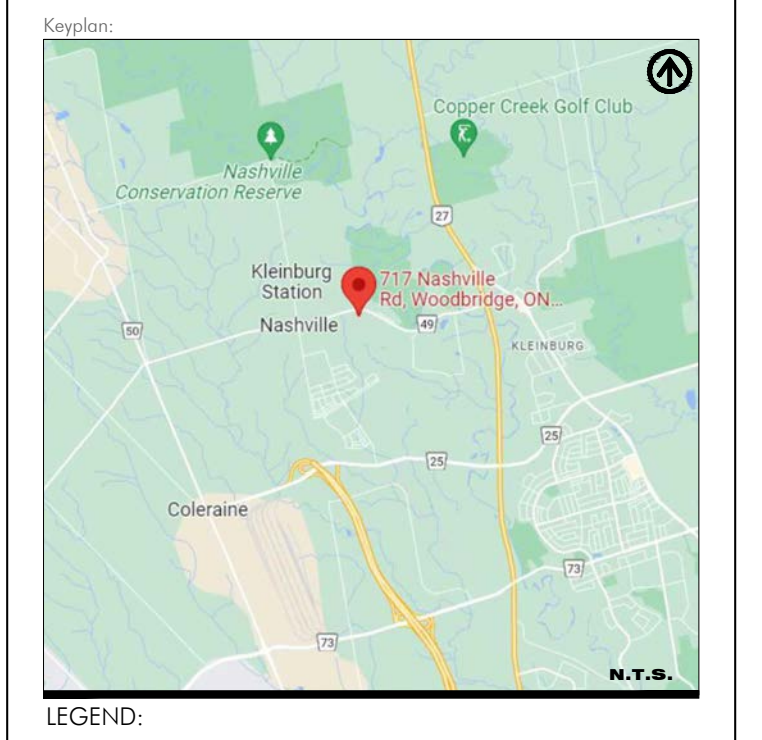

LEGEND:

No.	Date (D/M/Y)	Issue	By
1	29/06/23	REISSUED FOR HERITAGE VAUGHAN COMMITTEE	YY

POPOVICH ASSOCIATES
1 Robert Speck Parkway, Suite 100
Mississauga, Ontario L4Z 3M3
T. 905.270.2229 F. 905.270.2190
info@popovich.ca



The contractor will check and verify all dimensions and job conditions on the site and report any discrepancies to the Landscape Architect prior to the commencement of construction. This drawing must not be used for construction purposes until signed by the Landscape Architect. All drawings are the property of the Landscape Architect and may not be copied, reproduced or altered without written permission from the Landscape Architect. DO NOT SCALE DRAWING.

Project Info:
717 Nashville Rd
717 Nashville Rd, Woodbridge ON
Owner Info:
Birchberry Estates Inc.
3300 Steeles Avenue West, Suite 9, Concord, ON

Sheet Title:
PLANTING DETAILS
Project Number: 1589
Drawn By: YY
Checked By: SP
Date: FEB 2023
Scale: AS NOTED
Sheet Number:
HP3