

Tree Inventory & Protection Plan

Prepared for:
Bancheri Bros.

Subject Site:
10680 Islington Avenue, Vaughan, ON. L4H 3N5

Prepared By:
The Urban Arborist Inc.
PO BOX #74525 Humbertown Centre,
Etobicoke Ontario M9A 3A8
Tel: 416.833.6467
info@theurbanarborist.ca



ISA Certified Arborist---Robert Rafal Lis---Cert. #ON-1374A

March 27, 2023

Table of Contents

1.0	Introduction.....	02
1.1	Assignment	02
1.2	Existing Site Characteristics	02
2.0	Methodology and Guidance.....	03
2.1	Field Study	03
2.2	Tree Locations	03
2.3	Tree Conditions	03
3.0	Tree Inventory	04
3.1	Trees to Preserve	04
3.2	Trees to Remove	05
3.3	Trees to Injure	05
3.4	Trees to Plant	05
4.0	Tree Preservation, Protection and Management	06
4.1	Tree Protection	06
4.2	Tree Protection Barriers.....	06
5.0	Conclusions and Recommendations	07
Appendix 1	Tree Inventory.....	08
Appendix 2	York Region Street Tree Removal Calculation	09
Appendix 3	Site Plan / Tree Protection Plan Drawing TP-1.....	10
Appendix 4	City of Vaughan Heavy Duty Tree Protection Hoarding ULA 110A.....	11
Appendix 5	York Region NHF-100 Caliper Deciduous Tree Planting Detail	11
Appendix 6	Photographs	12-

1.0 Introduction

1.1 Purpose of Assignment

The Urban Arborist Inc was retained by Bancheri Bros. Interlocking and Paving Corp. to prepare a Tree Inventory & Protection Plan for a residential project. The purpose of the project is to install a pool and landscaping in the backyard.



Figure 1. Front of subject site at 10680 Islington Avenue, Vaughan, ON. L4H 3N5.

1.2 Existing Site Characteristics

The subject site has 2 adjacent residential lands, 1 being a vacant parcel. Beyond the rear property line is York Region R.O.W. lands. The backyard is void of any private trees protected but there are several trees on York Region R.O.W. lands that are within 6m of the subject property.

2.0 Methodology and Guidance

All data used in this report is empirical in nature, unless stated otherwise. All measurements in this

report utilize the metric system of measurement.

2.1 *Field Study*

Site inspection and data collection was initiated March 15, 2023. All trees 20cm in diameter measured at base within 6m of the subject site on private property as well as all York Region owned trees adjacent to the property within 6m have been included in this report.

2.2 *Tree Locations*

The locations of all significant trees were surveyed and plotted on the Tree Inventory Protection Plan and shown on Tree Inventory Plan drawing TP-1 in appendix 3.

2.3 *Tree Conditions*

During field study a generalized assessment system was used to give each significant tree a rating based on structural condition and health condition.

The following 5 level assessment for health is listed below.

- Very Poor - Tree displays severe dieback of branches, canopy is extremely sparse. May exhibit extreme pathogen infestation or infection. Or tree is dead.
- Poor - Tree displays some dieback. Branches or canopy is sparse with little or no signs of new growth or vigour. Possible pathogen infestation or infection. Foliar canopy is sparse.
- Fair - Tree is developing in a manner typical to others in the area. Canopy is full.
- Good - New growth is vigorous as evidenced by stem elongation and colour. Canopy is dense.
- Very Good - In addition to the attributes of a good rating, tree is displaying extremely vigorous growth and trunk displays a pattern of vigour cracks or lines.

The following 5 level assessment for structural condition was as follows:

- Very Poor - Trunk has large pockets of decay, is bifurcated or has a severe lean.

Limbs or branches are poorly attached or dead. Possible hazard.

- Poor - Limbs or branches are poorly attached or developed. Canopy is not symmetrical. Trunk has a lean.
- Fair - Trunk, limb and branch development though flawed is typical of this species.
- Good - Trunk is well developed with well attached limbs and branches; some flaws but are hardly visible.
- Very Good - In addition to attributes of a good rating, the tree exhibits a well developed root flare and a balanced canopy.

Factors Assessed were as follows:

Roots	Trunk	Foliage/Buds	Scaffold Branches	Small Branches/Twigs
<ul style="list-style-type: none"> · Collar/flare · Mechanical injury · Girdling roots · Insects/disease · Decay/fungi 	<ul style="list-style-type: none"> · Cavities · Mechanical injury · Cracks · Swollen/sunken areas · Insects/disease · Fungi 	<ul style="list-style-type: none"> · Size of foliage/buds · Foliage colour · Foliage injury · Dieback of buds/foilage · Insects/disease 	<ul style="list-style-type: none"> · Attachments/included bark · Taper · Distribution · Decay/cavities · Deadwood · Insects/disease 	<ul style="list-style-type: none"> · Vigour/growth rates · Distribution · Appearance · Insects/disease · Dieback

3.0 Tree Inventory

A total of 9 trees was inventoried. (See Tree Inventory Spreadsheet in appendix 1).

3.1 Trees to Preserve

The trees in this section have been evaluated suitable for preservation and fall under the Tree Preservation, Protection and Management guidelines in this report. Different approaches of Tree Preservation can be carried out following tree health and structure evaluation. The following describes the differences in approaches to Tree Preservation.

1. Preserve, Protect & Maintain

Includes protection with tree preservation hoarding, as well as pre and post-construction arboricultural works.

2. Preserve & Protect

Includes the installation of tree protection hoarding; no maintenance will be required unless

specified in the recommendations in Appendix 1

3. Retain

No protection or maintenance measures are required. Installation of tree protection barriers is optional.

# of Trees evaluated as suitable for Preservation	8
# of Trees to use Method 1	n/a
# of Trees to use Method 2	4 (#1152 - #1155)
# of Trees to use Method 3	n/a

In the case of 10680 Islington Avenue, 8 trees can be preserved and protected. 4 trees will require Heavy Duty Tree Protection Hoarding to aid in their protection for the duration of the project.

3.2 Trees to Remove

All trees scheduled for removal shall be removed prior to any construction, earthworks or installation of tree protection hoarding. Due to site or development, tree condition or location, retention is not warranted. 1 tree to be removed requires a permit from York Region.

Total of number of Trees to Remove requiring a permit	1
Trees Proposed to be Removed	#1157 (York Region R.O.W. Tree)

3.3 Trees to Injure

There are no trees scheduled to be injured.

3.4 Trees to Replant (Replacement)

A York Region Street Tree Removal Calculation has been created and is attached in appendix 2. A total of 2 replacement trees measuring 60mm are required for compensation. It is being proposed that 2

trees be planted on either side of the existing Silver Maple #1157 that is being proposed to be removed.

3.5 Pruning

No pruning is required for the proposed site plan.

4.0 Tree Preservation, Protection and Management

4.1 Tree Protection

All trees scheduled to be preserved must be protected with Heavy Duty Tree Protection Hoarding as shown on the Tree Inventory Protection Plan Drawing TP-1 in appendix 3.

4.2 Tree Protection Barriers

The TPZ barriers must be installed to the specifications set out in the City of Vaughan Heavy Duty Tree Protection Hoarding Detail ULA-110. Once built, photographs will be taken and sent to the City of Vaughan forestry department for reference.

5.0 Conclusions and Recommendations

Based on all data collected from on-site field work and review of all site plans the following conclusions and recommendations are made and correspond with Tree Inventory in Appendix 1:

Conclusions	Recommendations
1 tree is to be removed that is situated on York Region R.O.W. lands.	Circulate this report with City of Vaughan and York Region for permit approval.
4 trees on site are to be protected with Solid Plywood Tree Protection Hoarding.	Build Solid Plywood Tree Protection Hoarding as shown in Tree Inventory / Protection Drawing TP-1 in appendix 3.

Attachments are as follows:

- Appendix 1 Tree Inventory
- Appendix 2 York Region Street Tree Removal Calculation
- Appendix 3 Site Plan / Tree Protection Plan Drawing TP-1
- Appendix 4 City of Vaughan Heavy Duty Tree Protection Hoarding ULA 110A
- Appendix 5 York Region NHF-100 Caliper Deciduous Tree Planting Detail
- Appendix 6 Photographs

This 7 page Report was written by

Robert Rafal Lis
The Urban Arborist Inc.
ISA Certified Arborist No. ON-1374A
MTCU Qualified Arborist 18004025

Tree Inventory – 10680 Islington Ave. Vaughan, ON L4H 3N5 – March 15 2023.

Tag #	Common Name	Botanical Name	Diameter @ Base (cm)	Diameter at Breast Height (cm)	Health Condition	Structural Condition	Notes	Ownership	Recommendations Based on Site Plan	Minimum TPZ (m)	Proposed TPZ (m)	Replacement Trees Required
1151	Norway Maple	Acer platanoides	49	38 x 38	Good	Average	Co-dominant stems.	10680 Islington	Retain	2.4	2.4	-
1152	White Spruce	Picea glauca	40 x 37	27 x 29	Average	Average		10680 Islington	Preserve & Protect	1.8	1.8	-
1153	White Spruce	Picea glauca	37	28	Average	Average		10680 Islington	Preserve & Protect	1.8	1.8	-
1154	Mountain Ash	Sorbus	34	19 x 21	Average/Poor	Very Poor	Cavity below main union and frost crack on one stem. Significant deadwood throughout.	10680 Islington	Preserve & Protect	1.8	1.8	-
1155	White Spruce	Picea glauca	32	25	Average	Average	Trunk scar on East facing side.	10680 Islington	Preserve & Protect	1.8	1.8	-
1156	Norway Maple	Acer platanoides		12	Good	Good	Across the fence, no tag given. York Region owned	York Region	Retain	2.4	2.4	-
1157	Silver Maple	Acer saccharinum		73	Average	Very Poor	Across the fence, no tag given. Co-dominant litres with split in union and cracked all the way to base. York Region tree. Some breakage and deadwood throughout.	York Region	Remove	7.3	-	See York Region Calculation
1158	Silver Maple	Acer saccharinum		30	Average	Poor	Irregular crown, decay in trunk lower level. 6 meters away.	York Region	Retain	3	3	-
1159	Siberian Elm	Ulmus pumila		24	Average	Average		York Region	Retain	2.4	2.4	-

York Region Street Tree Removal Calculation – 10680 Islington Ave. Vaughan, ON L4H 3N5 – March 15 2023.

Tag #	Common Name	Botanical Name	Diameter @ Breast Height (1.4m) CM	Condition Rating	%	Ownership	# of Replacement Trees	Compensation Value
1156	Norway Maple	Acer platanoides	12	Satisfactory	80	Retain	York Region	-
1157	Silver Maple	Acer saccharinum	73	Death Imminent	20	Remove	York Region	2
1158	Silver Maple	Acer saccharinum	30	Satisfactory	80	Retain	York Region	-
1159	Siberian Elm	Ulmus pumila	24	Satisfactory	80	Retain	York Region	-
	Size of Replacement Tree (mm)		60					Total
	Cost of Deciduous Replacement (\$)		870.44					\$1,740.88
	Cost of Evergreen Replacement (\$)		770.38					2
							Required Financial Compensation	TBD

Tree Inventory – 10680 Islington Ave. Vaughan, ON L4H 3N5 – March 15 2023.

Tag #	Common Name	Botanical Name	Diameter @ Base (cm)	Diameter at Breast Height (cm)	Health Condition	Structural Condition	Notes	Ownership	Recommendations Based on Site Plan	Minimum TPZ (m)	Proposed TPZ (m)	Replacement Trees Required
1151	Norway Maple	Acer platanoides	49	38 x 38	Good	Average	Co-dominant stems.	10680 Islington	Retain	2.4	2.4	-
1152	White Spruce	Picea glauca	40 x 37	27 x 29	Average	Average		10680 Islington	Preserve & Protect	1.8	1.8	-
1153	White Spruce	Picea glauca	37	28	Average	Average		10680 Islington	Preserve & Protect	1.8	1.8	-
1154	Mountain Ash	Sorbus	34	19 x 21	Average/Poor	Very Poor	Cavity below main union and frost crack on one stem. Significant deadwood throughout.	10680 Islington	Preserve & Protect	1.8	1.8	-
1155	White Spruce	Picea glauca	32	25	Average	Average	Trunk scar on East facing side.	10680 Islington	Preserve & Protect	1.8	1.8	-
1156	Norway Maple	Acer platanoides		12	Good	Good	Across the fence, no tag given. York Region owned	York Region	Retain	2.4	2.4	-
1157	Silver Maple	Acer saccharinum		73	Average	Very Poor	Across the fence, no tag given. Co-dominant litres with split in union and cracked all the way to base. York Region tree. Some breakage and deadwood throughout.	York Region	Remove	7.3	-	See York Region Calculation
1158	Silver Maple	Acer saccharinum		30	Average	Poor	Irregular crown, decay in trunk lower level. 6 meters away.	York Region	Retain	3	3	-
1159	Siberian Elm	Ulmus pumila		24	Average	Average		York Region	Retain	2.4	2.4	-

- NOTES:**
- ALL TREE PROTECTION BARRIERS ARE TO BE BUILT TO THE EXTENT NOTED AND MEASURED FROM THE OUTSIDE OF THE TRUNK, NOT THE CENTER.
 - ALL PRIVATELY OWNED TREES ARE TO BE PROTECTED USING SOLID PLYWOOD CONSTRUCTION AND BE 4 FEET HIGH.
 - ALL TREE PROTECTION BARRIERS ARE TO STAY IN PLACE UNTIL CONSTRUCTION IS COMPLETED.
 - PLANTING OF NEW TREES ON YORK REGION IS TO BE CONFIRMED PRIOR TO PLANTING.
 - IF PLANTING CANNOT BE ACCOMMODATED A CASH-IN-LIEU OPTION WILL BE REQUIRED TO PAID IN FULL.

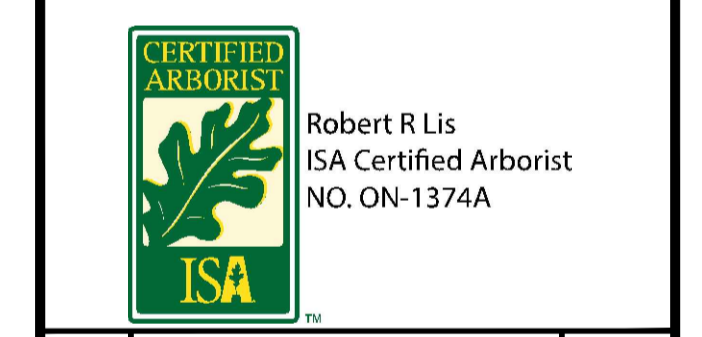
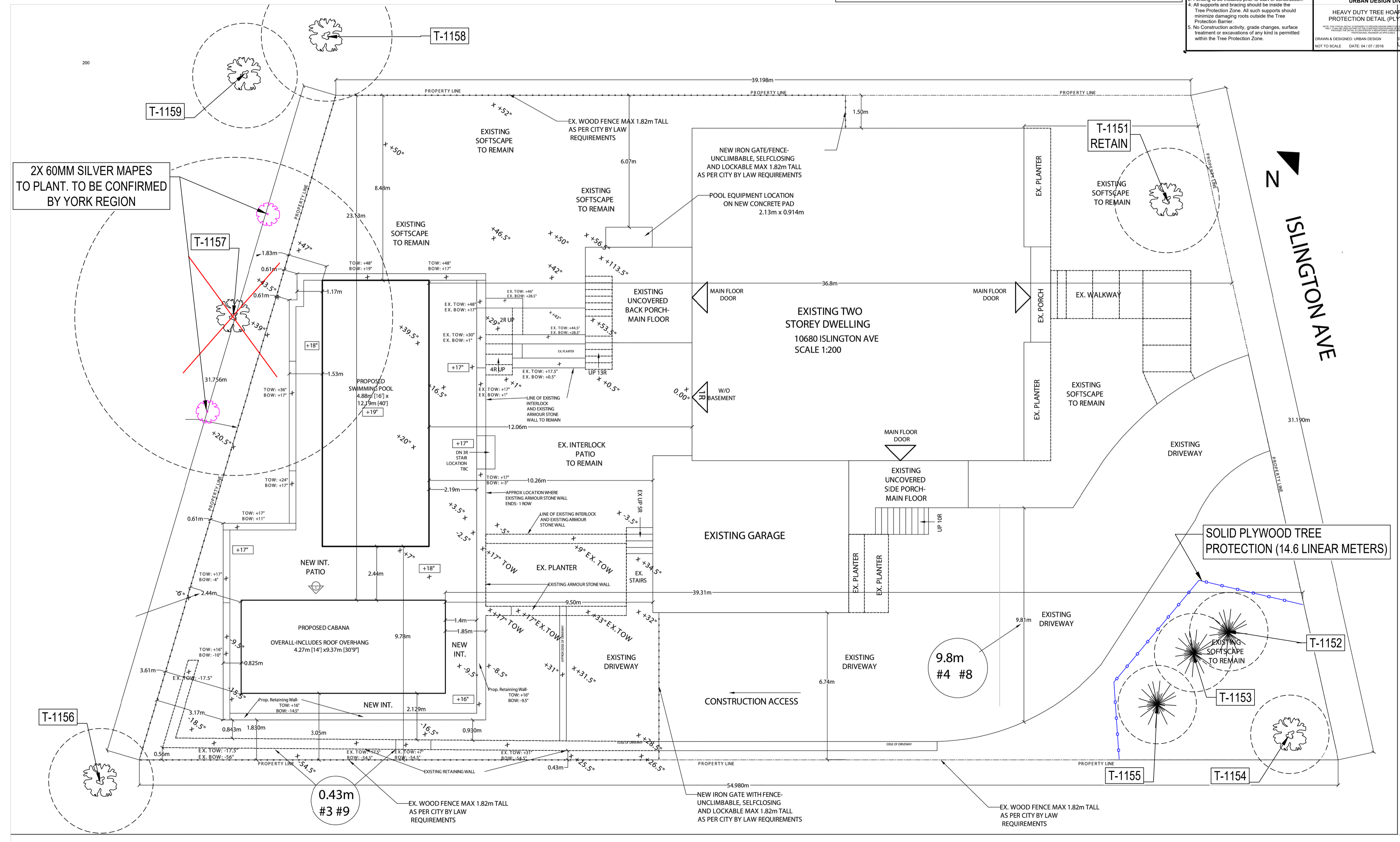
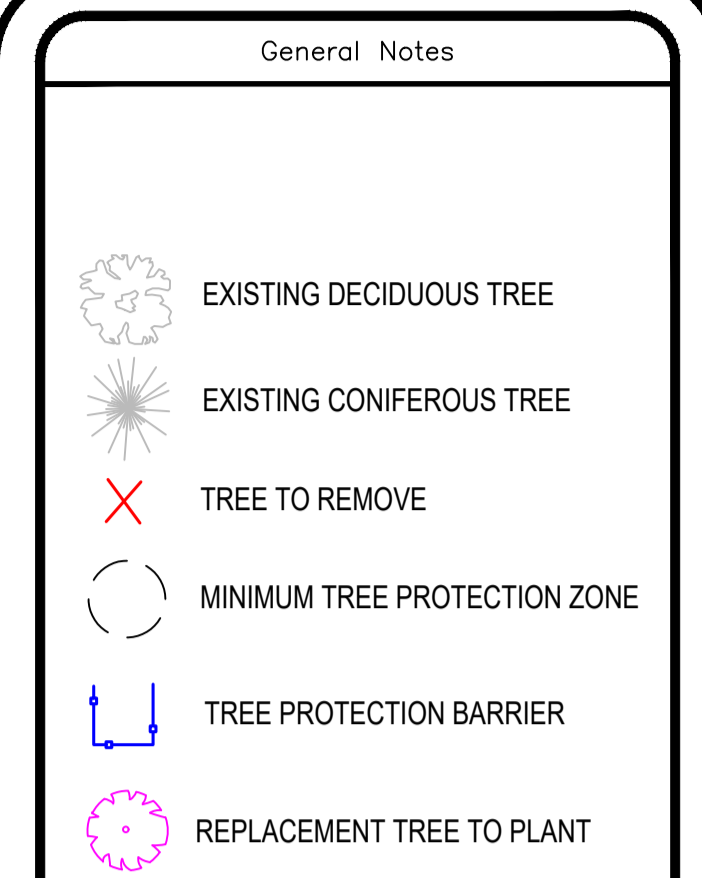
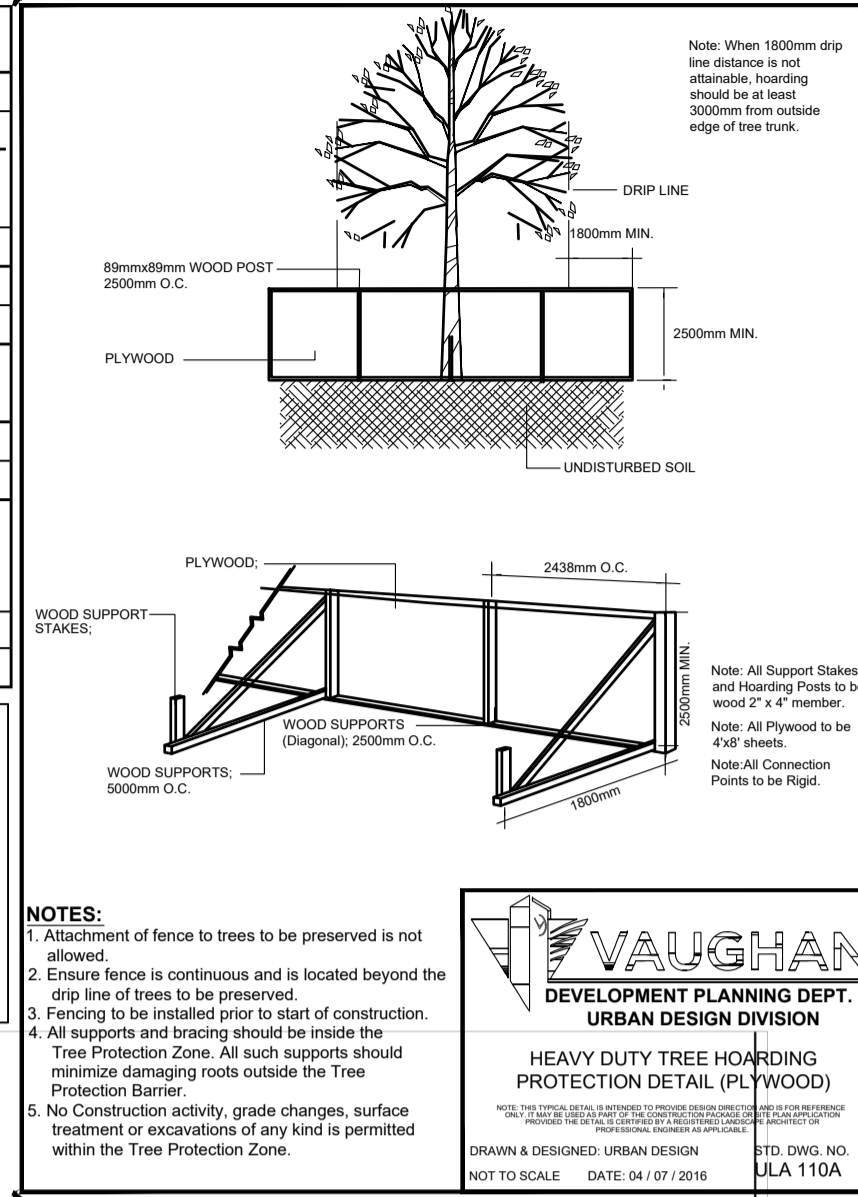

No.	Revision/Issue	Date

Firm Name and Address
The Urban Arborist Inc.
P.O. Box 74525
Humbertown Centre
Etobicoke, ON
M9A 5E2

Project Name and Address
10680 Islington Avenue
Vaughan, ON.
L4H 3N5

Project Tree Inventory Protection Plan	Sheet TP-1
Date 27.03.2023	Scale 1:100

Note: When 1800mm drip line distance is not attainable, hoarding should be at least 3000mm from outside edge of tree trunk.

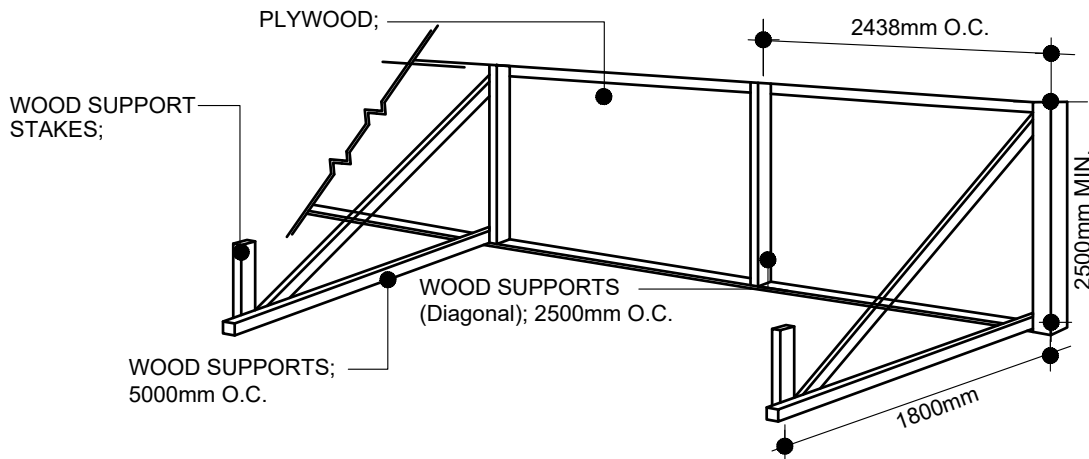
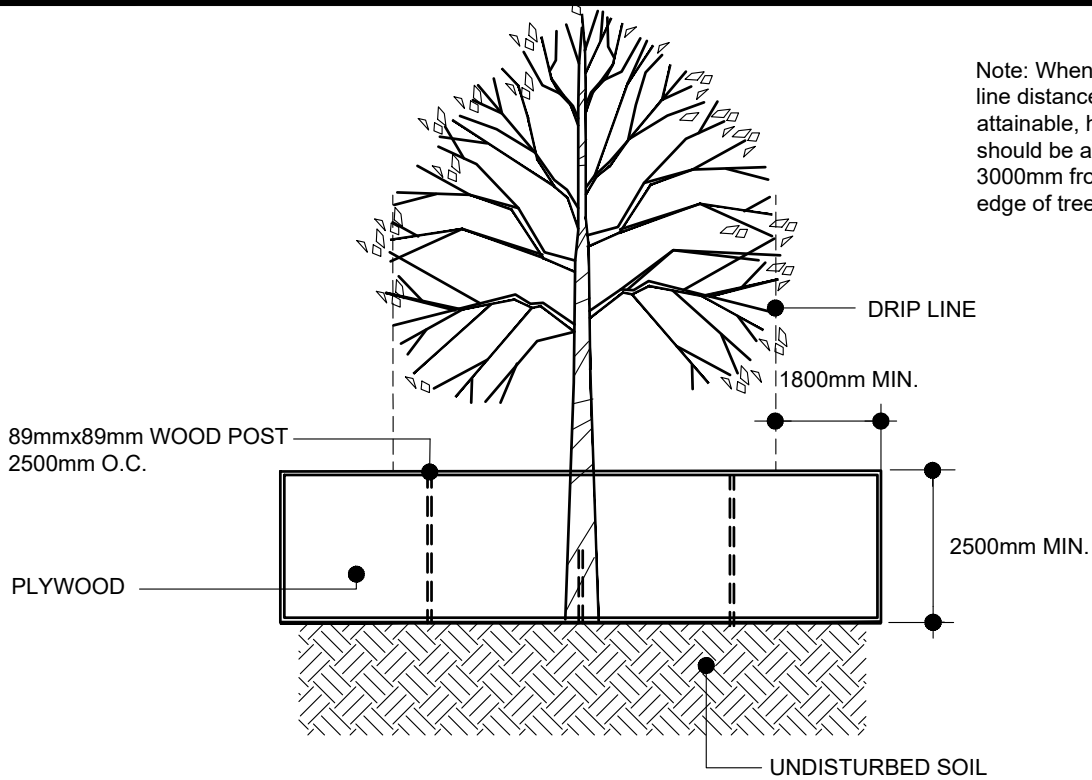

Note: All Support Stakes and Hoarding Posts to be wood 2" x 4" member.

Note: All Plywood to be 4'x8' sheets.

Note: All Connection Points to be Rigid.

NOTES:

1. Attachment of fence to trees to be preserved is not allowed.
2. Ensure fence is continuous and is located beyond the drip line of trees to be preserved.
3. Fencing to be installed prior to start of construction.
4. All supports and bracing should be inside the Tree Protection Zone. All such supports should minimize damaging roots outside the Tree Protection Barrier.
5. No Construction activity, grade changes, surface treatment or excavations of any kind is permitted within the Tree Protection Zone.



VAUGHAN

DEVELOPMENT PLANNING DEPT.
URBAN DESIGN DIVISION

HEAVY DUTY TREE HOARDING PROTECTION DETAIL (PLYWOOD)

NOTE: THIS TYPICAL DETAIL IS INTENDED TO PROVIDE DESIGN DIRECTION AND IS FOR REFERENCE ONLY. IT MAY BE USED AS PART OF THE CONSTRUCTION PACKAGE OR SITE PLAN APPLICATION PROVIDED THE DETAIL IS CERTIFIED BY A REGISTERED LANDSCAPE ARCHITECT OR PROFESSIONAL ENGINEER AS APPLICABLE.

DRAWN & DESIGNED: URBAN DESIGN

STD. DWG. NO.

NOT TO SCALE DATE: 04 / 07 / 2016

ULA 110A

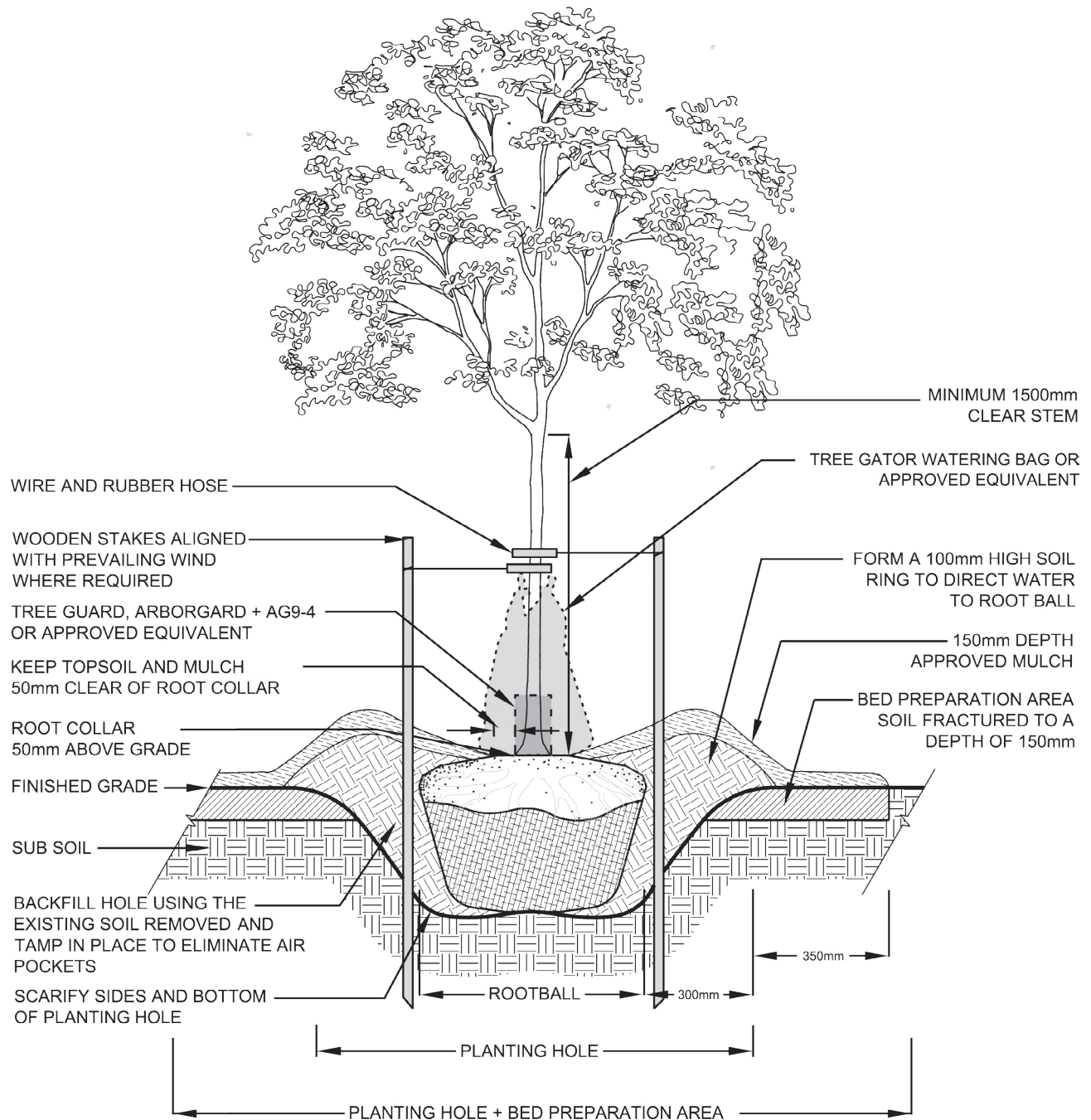

TREE PLANTING SPECIFICATIONS

PLANTING DETAIL TO BE READ IN CONJUNCTION WITH THE REGION'S SPECIFICATIONS FOR STREET TREE PLANTING

MYCORRHIZAL INOCULANTS:

- INSTALL MYKE PRO LANDSCAPE G

WATERING:

- SOAK THE ROOTBALL AND BACKFILL AREA WITH 40 LITRES OF WATER AFTER PLANTING
- INSTALL 57 LITRE TREE GATOR WATERING BAG

ROOTBALL, BURLAP, TWINE:

- CUT AND REMOVE ALL WIRE, ROPE, BURLAP AND TWINE FROM THE TOP 1/3 OF THE ROOTBALL

CROWN PRUNING:

- PRUNE AT PLANTING TO CAREFULLY REMOVE DEAD, BROKEN OR DAMAGED BRANCHES



Environmental
Services

CALIPER DECIDUOUS TREE PLANTING DETAIL FOR SOFTSCAPE BOULEVARDS

DATE: JUNE 2016

SCALE N.T.S.

REV.

X

X

NHF-100



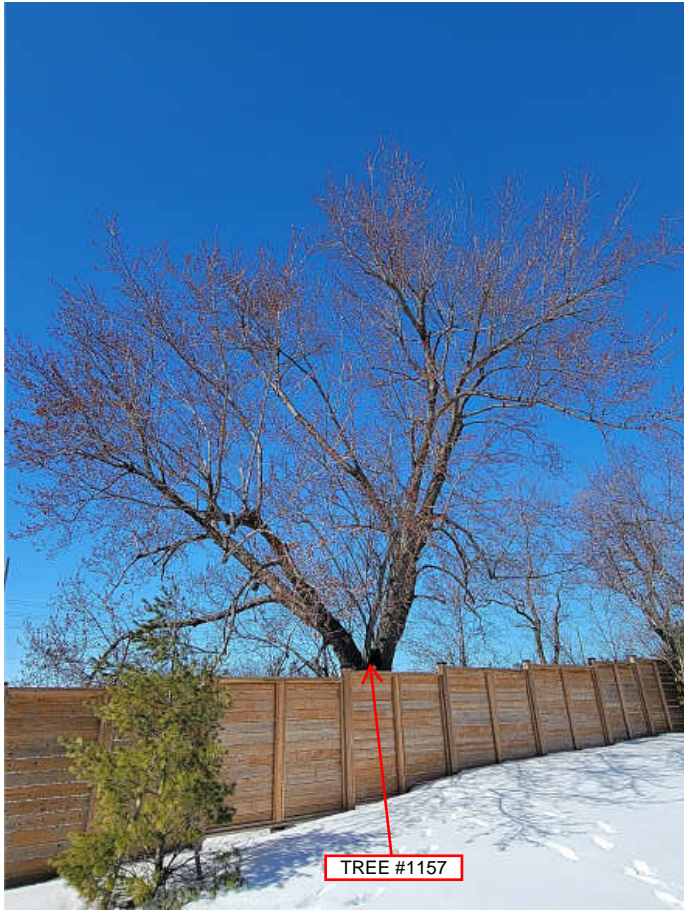

TREE #1157

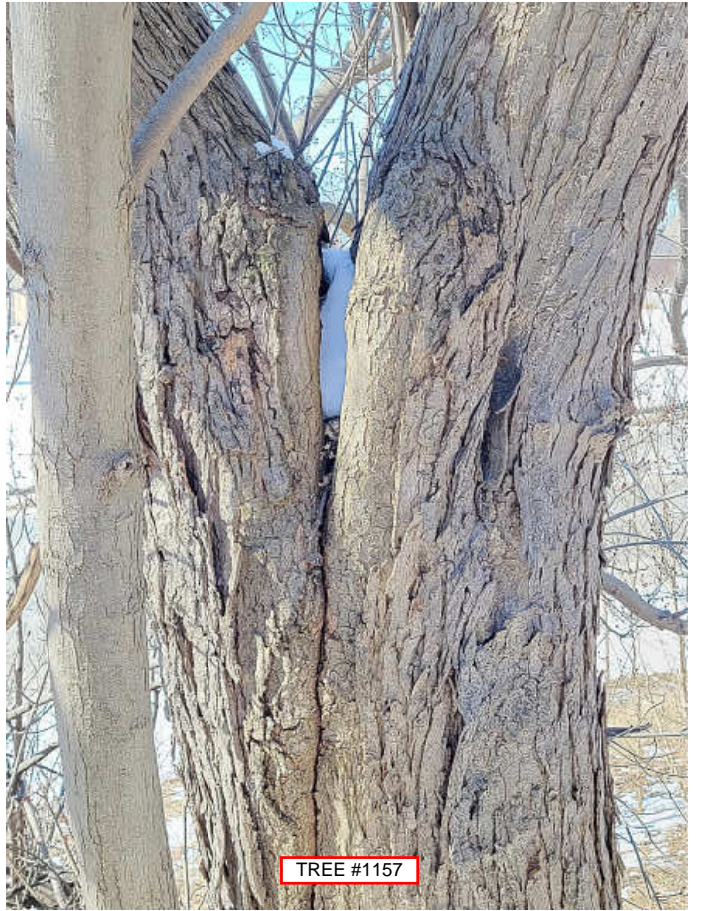

TREE #1157



TREE #1158