

CABANA- PLAN VIEW

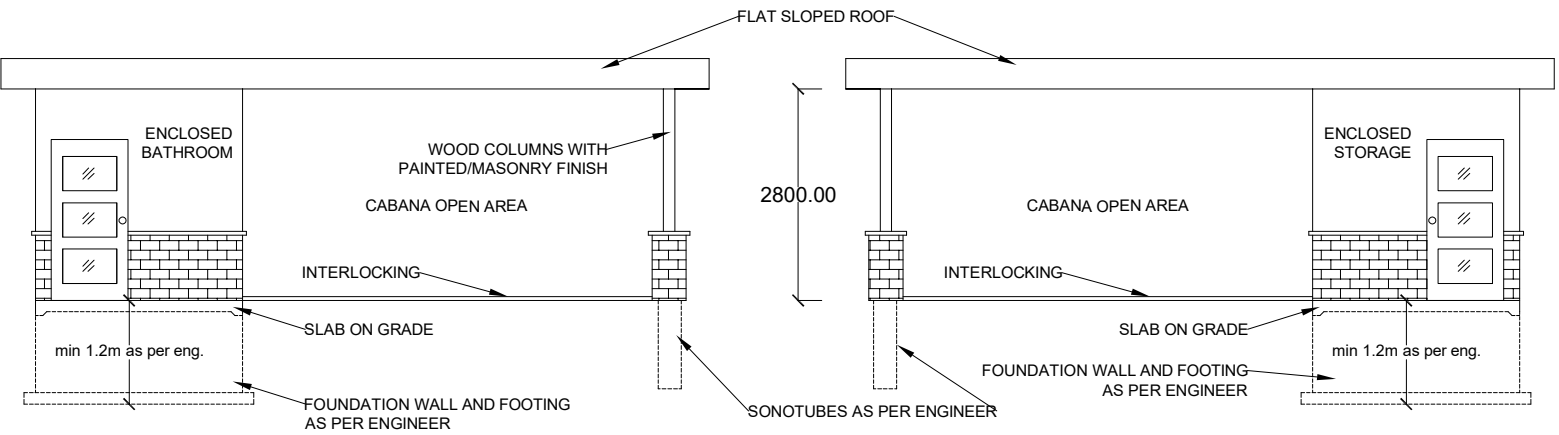

CABANA-EAST ELEVATION

CABANA-WEST ELEVATION

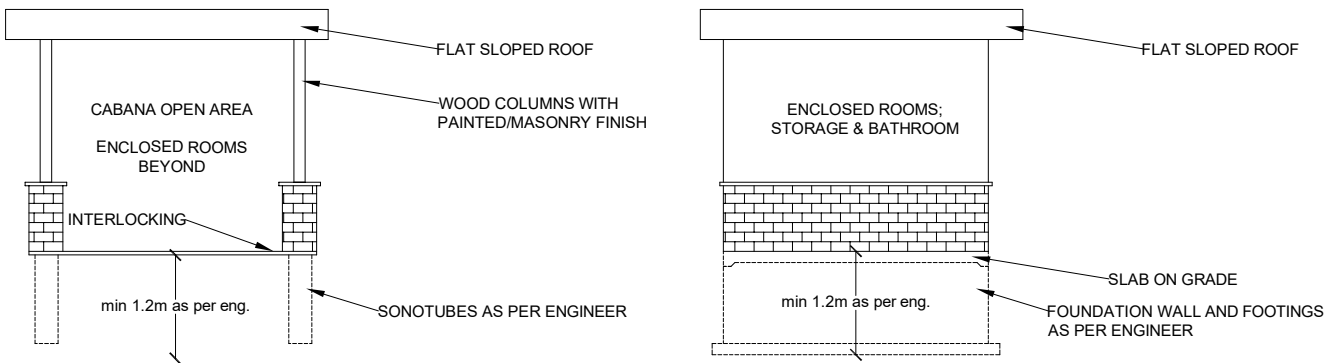

CABANA-NORTH & SOUTH ELEVATION

**ATTACHMENT 3**  
**10680 ISLINGTON**



**BANCHERI BROS**  
**INTERLOCK AND POOLS**

10680 ISLINGTON AVE

MARCH 9 2023

SCALE 1:100

MV- CABANA ELEVATIONS-  
FEB 15 2023

MV- REVISED CABANA  
ELEVATIONS- FEB 22 2023

HERITAGE- CABANA  
ELEVATIONS- MARCH 9 2023







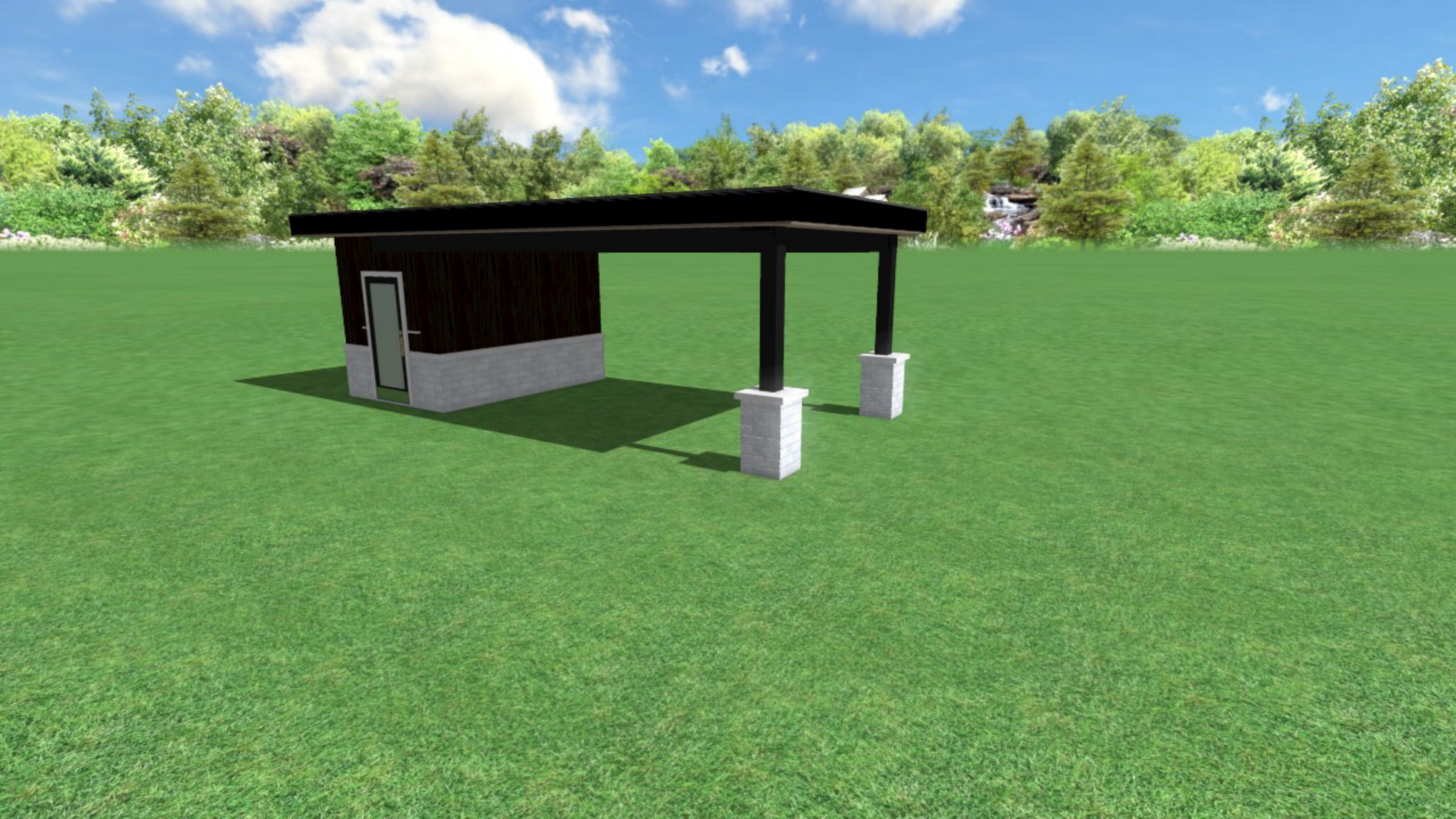















# Vivace

This durable concrete stone merges form and function into one, blending quality, strength and durability with beauty. Vivace's rich, bold colours and chiseled stone look add an aesthetic element that complements the surrounding landscape.





AVAILABLE SIZES

VIVACE MULTI BUNDLE



Length 216 mm (8 1/2")  
Height 102 mm (4")  
Depth 90 mm (3 1/2")



Length 251 mm (10")  
Height 102 mm (4")  
Depth 90 mm (3 1/2")



Length 292 mm (11 1/2")  
Height 102 mm (4")  
Depth 90 mm (3 1/2")



Length 330 mm (13")  
Height 102 mm (4")  
Depth 90 mm (3 1/2")



Length 368 mm (14 1/2")  
Height 102 mm (4")  
Depth 90 mm (3 1/2")



Length 405 mm (16")  
Height 102 mm (4")  
Depth 90 mm (3 1/2")



Length 216 mm (8 1/2")  
Height 177 mm (7")  
Depth 90 mm (3 1/2")



Length 251 mm (10")  
Height 177 mm (7")  
Depth 90 mm (3 1/2")



Length 292 mm (11 1/2")  
Height 177 mm (7")  
Depth 90 mm (3 1/2")



Length 330 mm (13")  
Height 177 mm (7")  
Depth 90 mm (3 1/2")



Length 368 mm (14 1/2")  
Height 177 mm (7")  
Depth 90 mm (3 1/2")



Length 405 mm (16")  
Height 177 mm (7")  
Depth 90 mm (3 1/2")



Length 444 mm (17 1/2")  
Height 292 mm (11 1/2")  
Depth 90 mm (3 1/2")



Length 521 mm (20 1/2")  
Height 292 mm (11 1/2")  
Depth 90 mm (3 1/2")

VIVACE LARGE BUNDLE



Length 330 mm (13")  
Height 292 mm (11 1/2")  
Depth 90 mm (3 1/2")



Length 368 mm (14 1/2")  
Height 292 mm (11 1/2")  
Depth 90 mm (3 1/2")



Length 403 mm (16")  
Height 292 mm (11 1/2")  
Depth 90 mm (3 1/2")



Length 444 mm (17 1/2")  
Height 292 mm (11 1/2")  
Depth 90 mm (3 1/2")



Length 483 mm (19")  
Height 292 mm (11 1/2")  
Depth 90 mm (3 1/2")



Length 521 mm (20 1/2")  
Height 292 mm (11 1/2")  
Depth 90 mm (3 1/2")

AVAILABLE COLOURS - CANADA ONLY

All colours in the sizes shown are Stock Item Products. Manufactured in our Hillsdale, Ontario plant. Colours may vary due to the manufacturing process.



CHARCOAL  
Sizes: Multi Bundle



CORTONA  
Sizes: Multi Bundle, Large Bundle



MILANO  
Sizes: Multi Bundle, Large Bundle

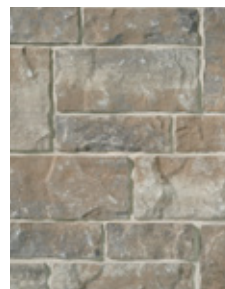

PALERMO BEIGE  
Sizes: Multi Bundle, Large Bundle



SIENA  
Sizes: Multi Bundle, Large Bundle



TWEED  
Sizes: Multi Bundle, Large Bundle

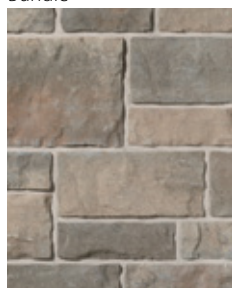

VERONA  
Sizes: Multi Bundle, Large Bundle



## STONE TEXTURE

Brampton Brick produces Vivace in an embossed texture.

## TYPICAL STONE PHYSICAL PROPERTIES

Product Property		CSA	ASTM	Typical Brampton Brick Range	
				Metric Units	Imperial Units
Minimum Compressive Strength	Individual	-	> 3000 psi	42 - 59 MPa	6000 - 8500 psi
	Average of 3 Specified	> 25 MPa	> 3500 psi		
Maximum Water Absorption	Individual	< 8%	< 12 lb/ft <sup>3</sup>	3.5 - 5.5%	4.9 - 7.7 lb/ft <sup>3</sup>
	Average of 3	-	< 10 lb/ft <sup>3</sup>		
Density	Individual	> 2000 kg/m <sup>3</sup>	>125 lb/ft <sup>3</sup>	2100 - 2250 kg/m <sup>3</sup>	130 - 145 lb/ft <sup>3</sup>
	Average of 3				

Based on CSA 165.2 for Grade I, Solid Units, Density over 2000 kg/m<sup>3</sup> and ASTM C1634 for Normal Weight

## PACKAGING SPECIFICATIONS

VIVACE	Quantity/ Pallet (pcs)	Weight/Piece (kg)	Weight/Piece (lbs)	Weight/Pallet (kg)	Weight/Pallet (lbs)	Coverage/ Pallet (m <sup>2</sup> )	Coverage/ Pallet (ft <sup>2</sup> )	Layers/Pallet
Vivace Multi Bundle	120	-	-	1,270.1	2,800	7.1	76	6 layers x 20 pieces
Vivace Large Bundle	48	-	-	1,170.7	2,581	6.3	68	6 layers x 8 pieces

## LEED PROGRAM

Brampton Brick can help maximize the number of LEED credits you wish to achieve by producing a product specific to your design needs. Our concrete products can be modified to achieve maximum LEED credits. Talk with your local Brampton Brick sales representative to learn how.

## AVAILABLE INTEGRAL WATER REPELLENT SYSTEM



Concrete masonry manufactured with the ACM Chemistries® RainBloc® Integral Water Repellent System resists rainwater penetration because:

- individual masonry units incorporate the RainBloc® water repellent additive during their manufacture
- concrete masonry units are tested and certified for water repellency performance compliance
- masonry mortar is produced with the RainBloc® for Mortar water repellent additive at the construction site

Concrete masonry produced with the RainBloc® Integral Water Repellent System resists wind-driven rain while still maintaining vapor transmission, reducing the chance of mold, mildew, and musty smells from developing inside a building.

RainBloc® for Mortar is a liquid admixture used at the masonry construction site to make mortar. RainBloc® for Mortar should only be used with concrete or clay masonry units manufactured with RainBloc® water repellent additive in exterior masonry wall construction. To ensure your masonry wall system is completely water repellent you must remember to include the RainBloc additive to the masonry mortar on site. Specify RainBloc Water Repellent System when designing with Bonneville, Contempo, Finesse, Profile Series or Origin Series.

RainBloc® for Mortar Performance in ASTM Standards and Tests RainBloc® for Mortar meets or exceeds the Performance requirements for high quality masonry mortar water repellents when tested and evaluated according to ASTM C 1384, "Standard Specification for Admixtures for Masonry Mortars". When measured by ASTM C 1072, "Standard Test Method for Measurement of Masonry Flexural Bond Strength", the RainBloc® Integral Water Repellent System does not adversely affect mortar bond.

[Ref #1]