

Kleinburg Village Improvements

Islington Avenue, Nashville Road and Stegman's Mill Road

Heritage Vaughan
November 30, 2022

Agenda



Introduction

Scope of Project

Project Background & Considerations

Infrastructure Improvements

Streetscape Design

Questions & Comments

Scope of Project

- Streetscape & Infrastructure Improvements
- Active Transportation (pedestrians & cyclists)
- New On Street Parking
- Watermain Replacement
- Roadway Pavement Replacement
- Streetlighting Upgrades
- Planned Construction Start 2023
- Anticipated Completion 2024

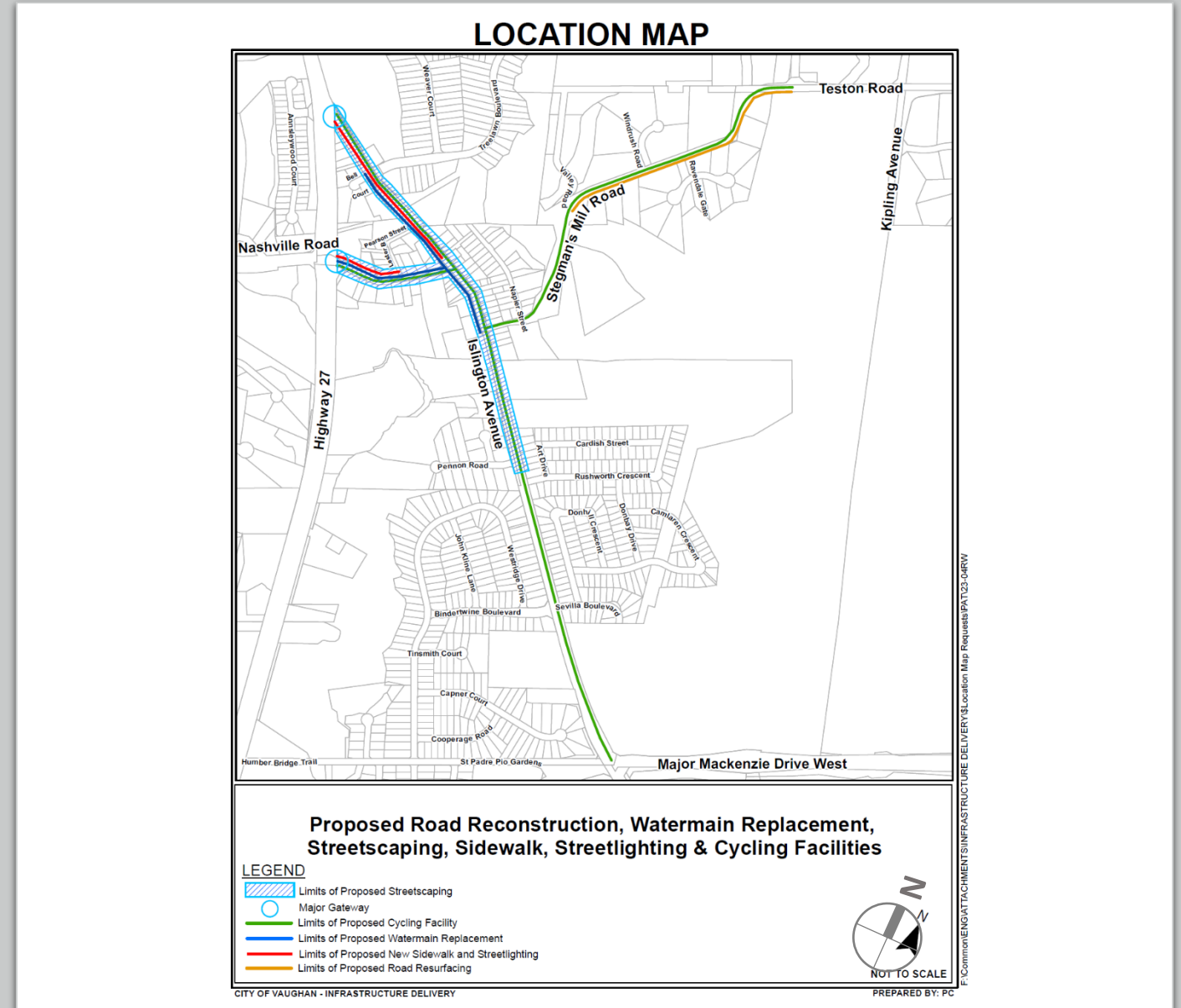

Key Stakeholders

Region of York

TRCA

Utility Companies

Heritage Vaughan Committee

Kleinburg BIA

McMichael Art Gallery

Area Schools

Ratepayers & Residents

City Design Review Panel (DRP)

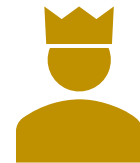
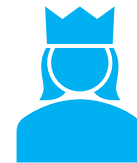

Consultation & Public Engagement

- Dedicated study webpage
- Study notifications:
 - Project webpage
 - Public service announcements
 - Social media & Local newspaper
- Stakeholder Group Engagement - BIA, McMichael, Ratepayers Association, residents, property owners, businesses
- Virtual Public Information Centres – introduce the project, receive comments / feedback, listen to issues and concerns





Source: Village of Kleinburg – Islington Avenue Streetscape Master Plan
Study Final Draft Report – June 2011



Goals and Objectives

- Create a unique and memorable streetscape
- Integrate Sustainable Principles and Ideals
- Increase safety and accessibility along the streetscape
- Advocate place-making
- Enhance connectivity
- Balance unity and diversity along the streetscape

Art and Nature Gateway



A

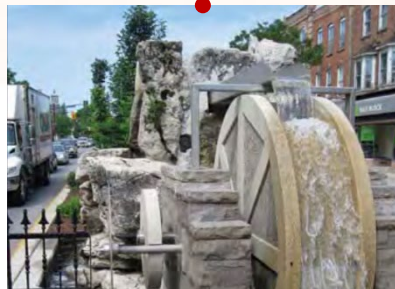

Water Power Energy Gateway

B

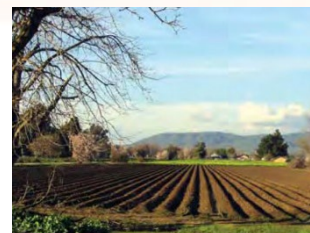

C *Agriculture Gateway
Phase 1 - Islington Avenue and Major Mackenzie Dr.*

Phase 1 Gateway – Islington Rd. and Major Mackenzie Dr. Intersection



Existing Conditions – Typical Sections



Islington Ave.

- ✓ Streetscape Improvements
- ✓ Active Transportation (pedestrians & cyclists)
- ✓ Watermain Replacement
- ✓ Changes to Streetlighting
- ✓ Road Rehabilitation Work

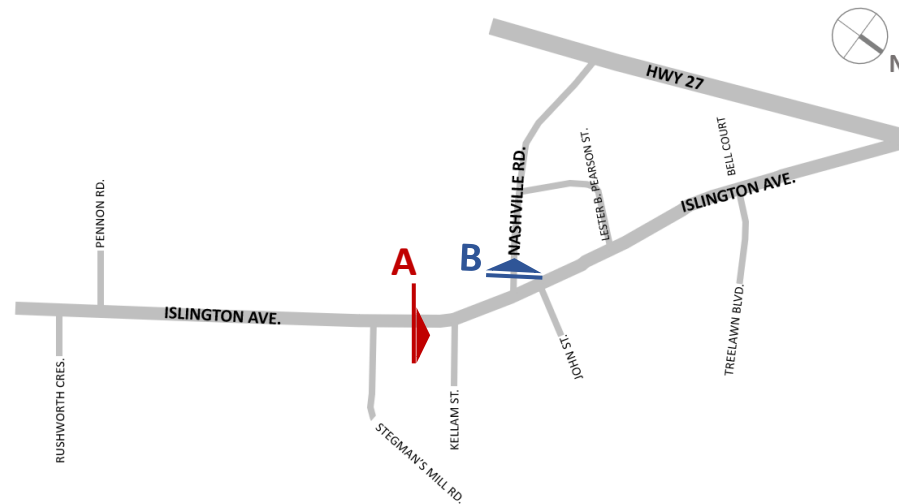

Nashville Rd.

- ✓ Streetscape Improvements
- ✓ Active Transportation (pedestrians & cyclists)
- ✓ Watermain Replacement
- ✓ Changes to Streetlighting
- ✓ Gateway
- ✓ Road Rehabilitation Work

Sections

Islington Ave. from
Stegman's Mill to Kellam St.

Existing Section **A**

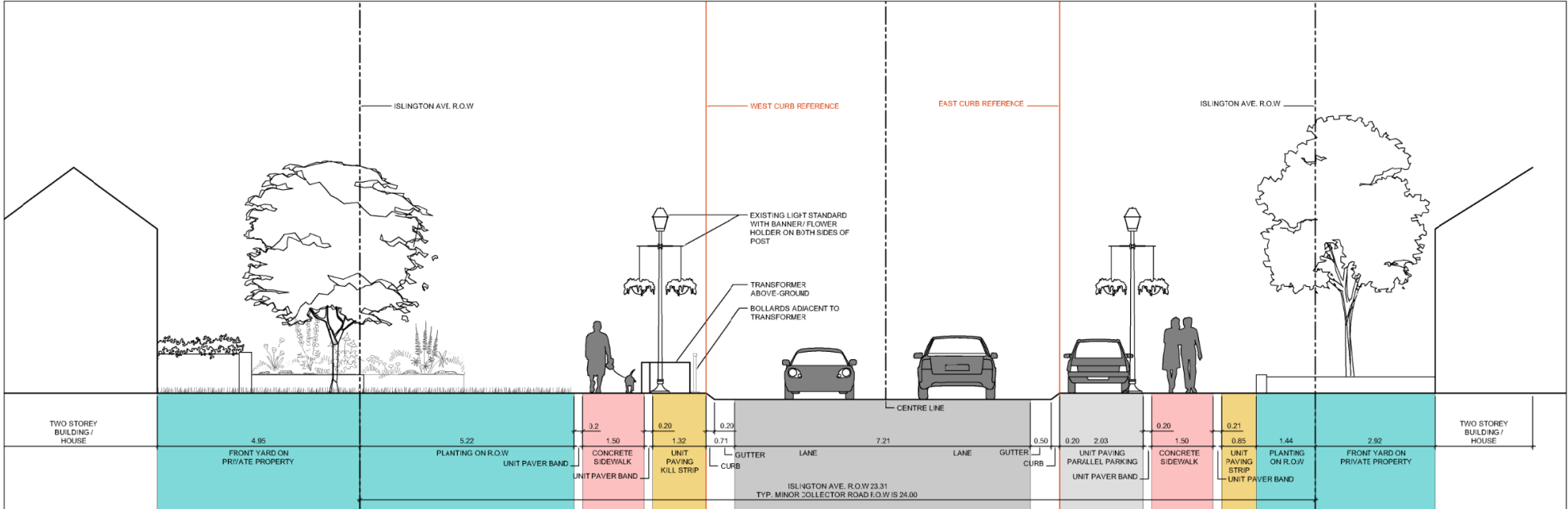

Proposed Conceptual Section **A**

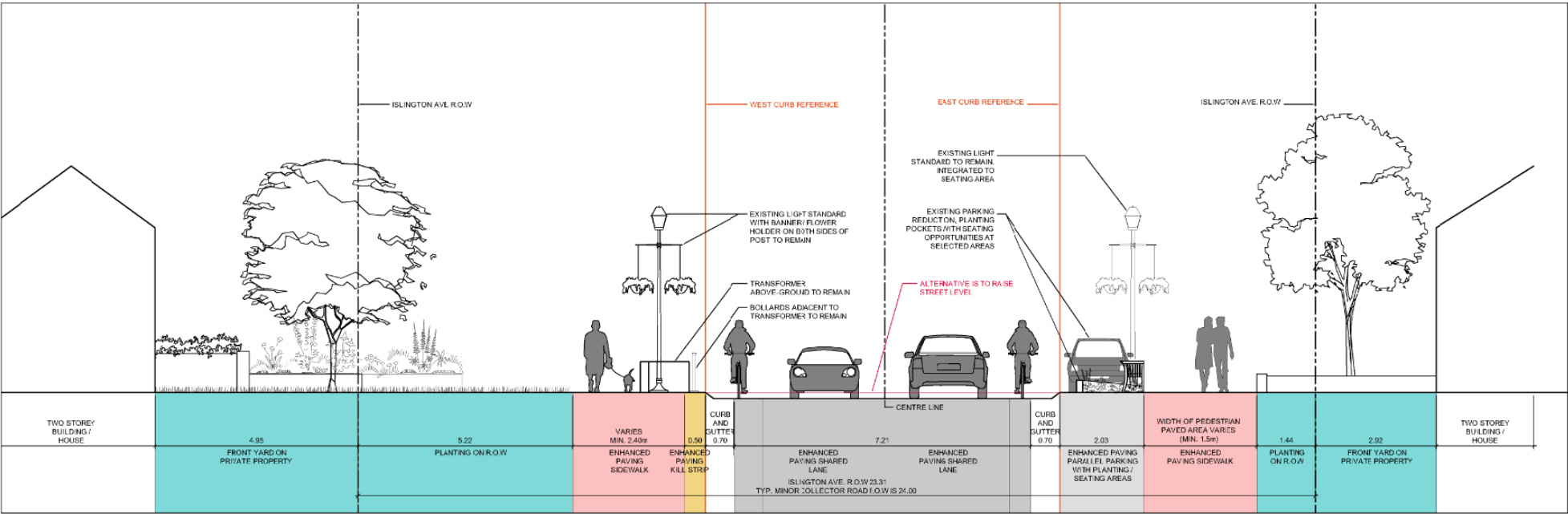

Sections

Nashville Rd. from Islington Ave. to Lester B. Pearson St.

Existing Section B

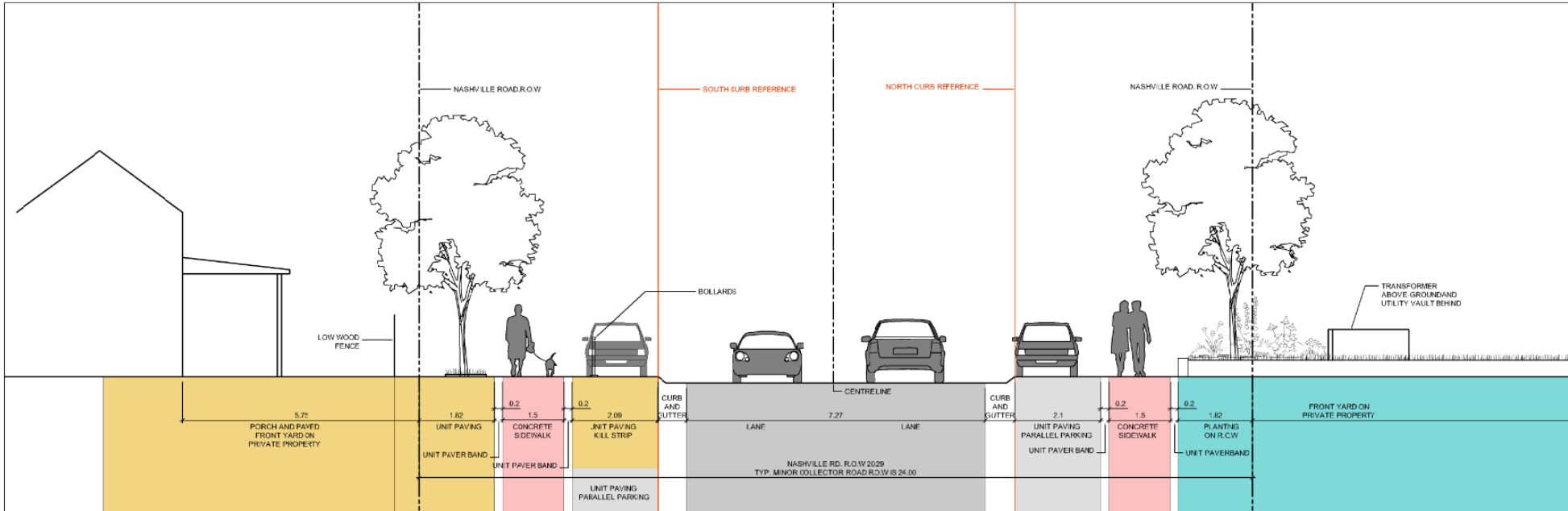

Proposed Conceptual Section B

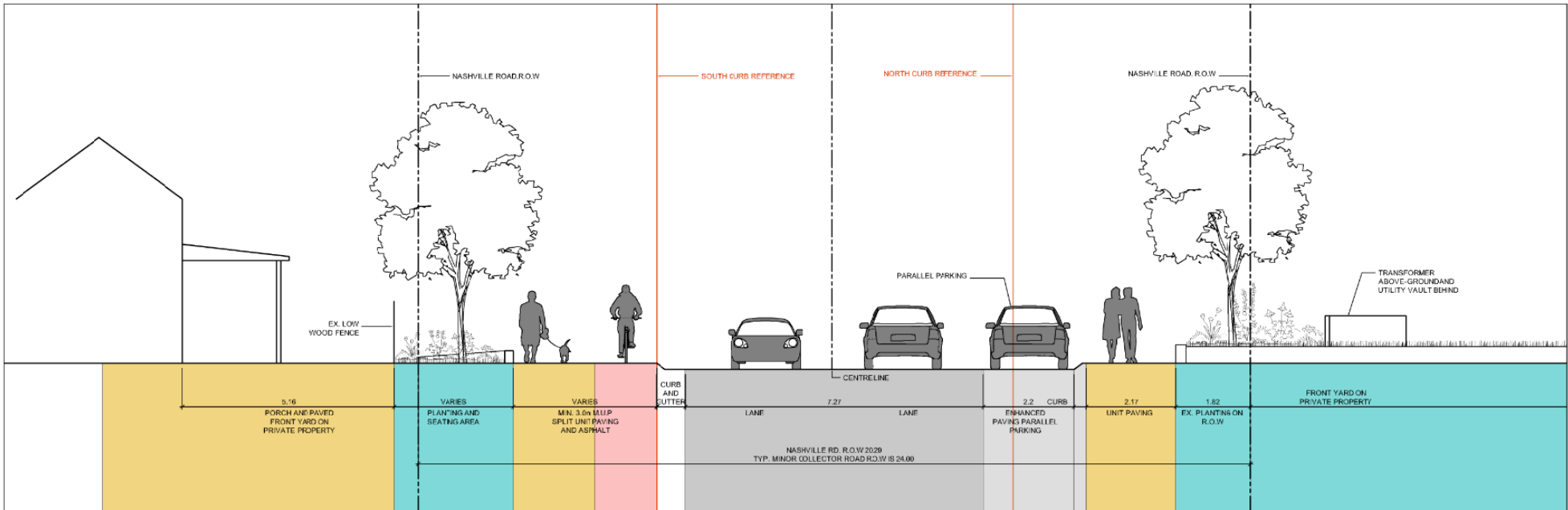

Village Core Area – Design Strategy

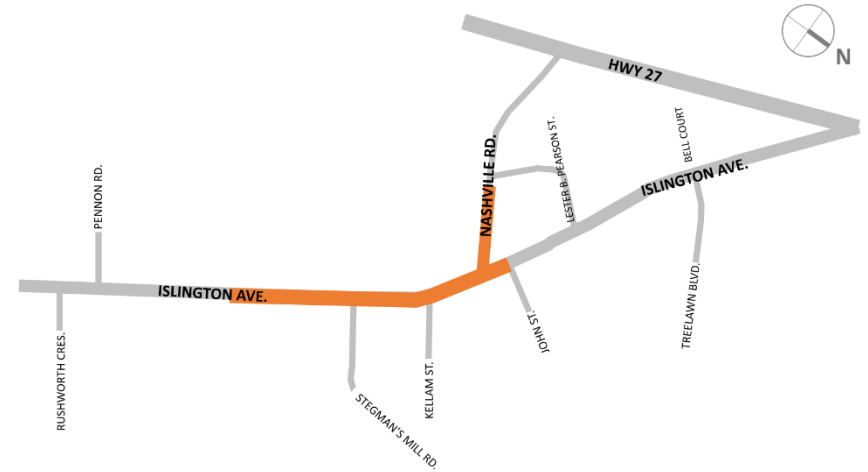

The Objectives

- Preserve unique Village character
- Unify and enhance Public Realm
- Seek planting opportunities
- Provide additional pedestrian resting areas
- Provide lay-by parking with enhanced surface treatment

Village Core Area – Plan

Boundaries:

- Islington Avenue: South - McMichael Gallery; North – John Street
- Nashville Road: East of Lester Pearson Street to Islington Avenue

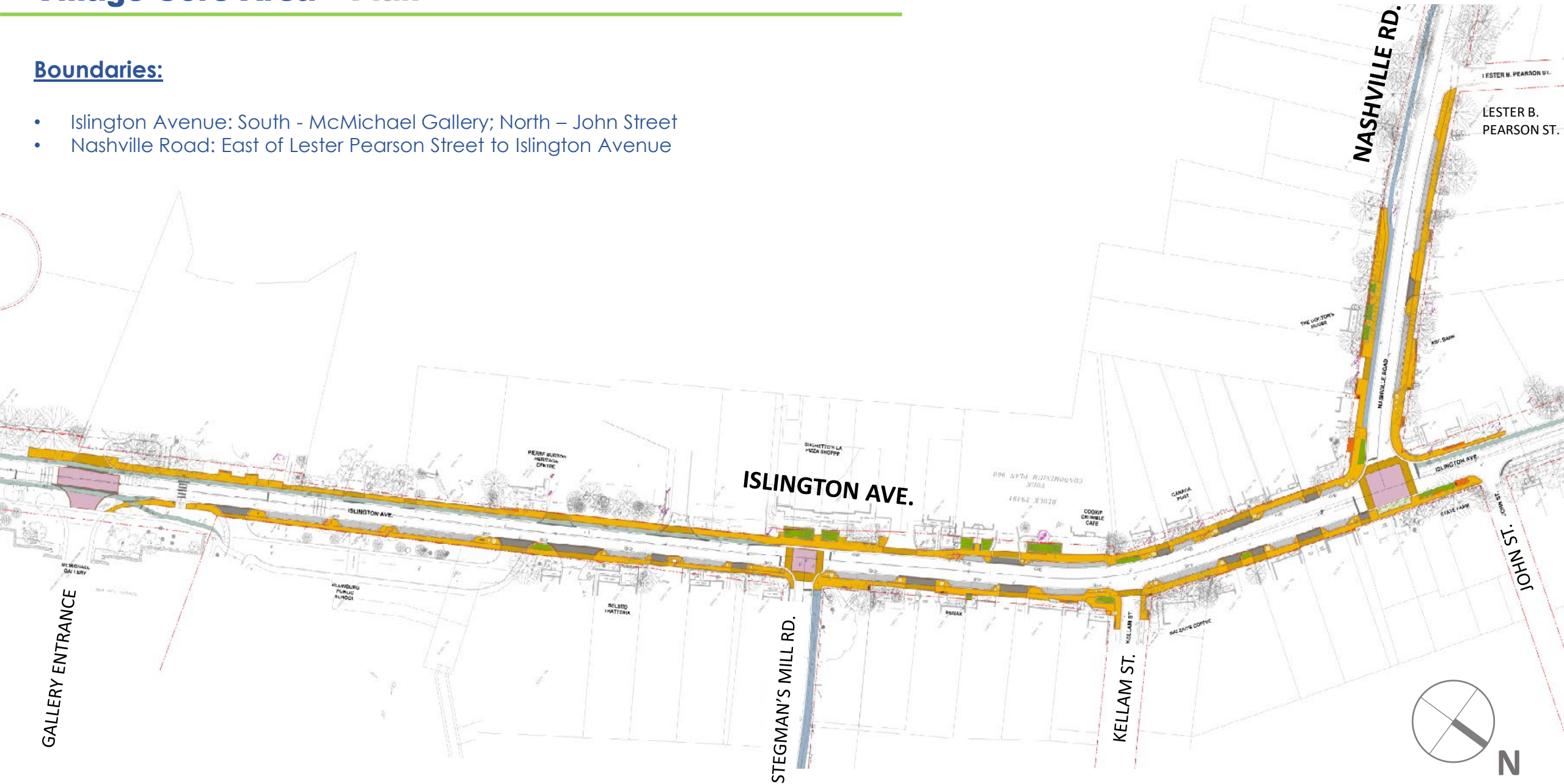

Demonstration Plan (Core Area)

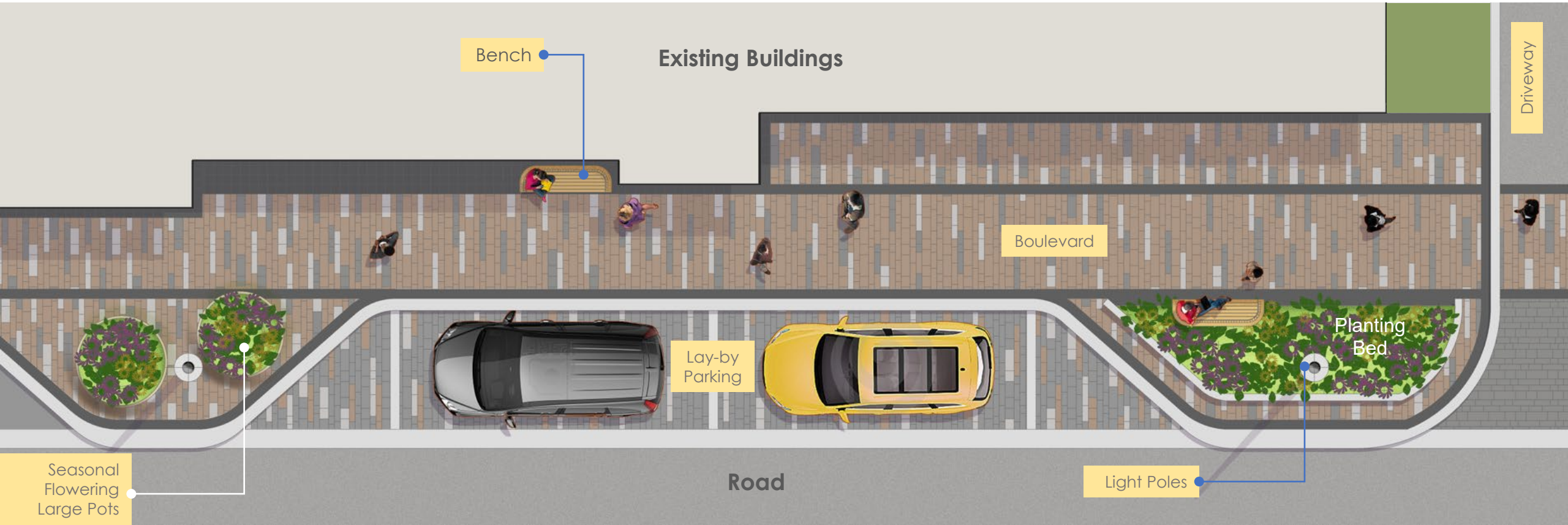

Enhanced Pedestrian Realm:

- Unit paved pedestrian zone with defined edging
- Seasonal Flowering Pots
- Year-round Planting Beds
- Seating areas and site furniture
- Light standards with hanging baskets and banners

Lay-by Parking:

- Pavement enhancement to differentiate and harmonize with pedestrian zone
- Barrier curbs for safety

Driveway:

- Clear delineation of pedestrian route
- Potential paving enhancement within vehicular zone

Paving Strategy – Core Area Boulevard

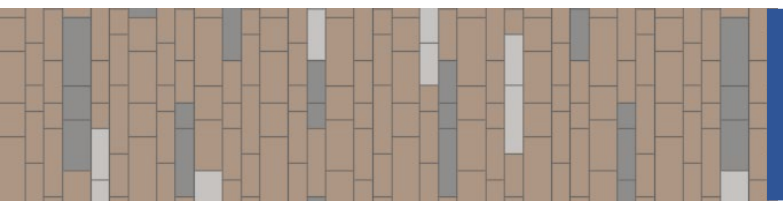

Boulevard

80%
BAVARIAN BLEND

10%
FOSSIL

10%
MIDNIGHT SKY

DESCRIPTION: ARTLINE
MANUFACTURER: UNILOCK

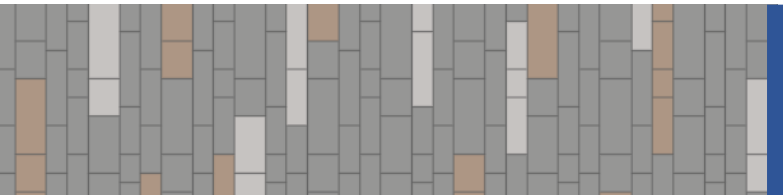

Layby Parking

80%
FOSSIL

10%
BAVARIAN BLEND

10%
MIDNIGHT SKY

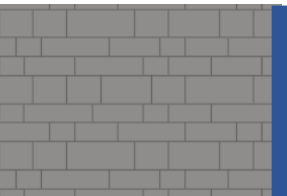

Driveway Edge

100%
MIDNIGHT SKY

DESCRIPTION: ARTLINE
MANUFACTURER: UNILOCK



Edge

100%
BLACK GRANITE

DESCRIPTION: SERIES
MANUFACTURER: UNILOCK
COLOUR: BLACK GRANITE

PHASE 1 MATERIAL
DESIGN LINK TO MASTER PLAN
DESIGN SCALE

Site Furniture – Core Area Boulevard



DESCRIPTION: MELVILLE BACKED BENCH, 72IN, WOOD

MANUFACTURER: LANDSCAPE FORMS

COLOUR: GLOSS BLACK FRAME, IPE WOOD SEAT



DESCRIPTION: TONYO RECEPTACLE, 60 AND 30 GAL, W/RAINHAT

MANUFACTURER: FORMS+SURFACES

COLOUR: GLOSS BLACK WITH IPE WOOD



DESCRIPTION: DS-32 PLANTER AND DS-29 PLANTER

MANUFACTURER: KORNEGAY DESIGN

COLOUR: SANDSTONE



DESCRIPTION: 100 SERIES BIKE RACK

MANUFACTURER: : MAGLIN

COLOUR: GLOSS BLACK



DESCRIPTION: NYSSA BOLLARD

MANUFACTURER: NERI

COLOUR: GLOSS BLACK

Site Furniture – Core Area Boulevard

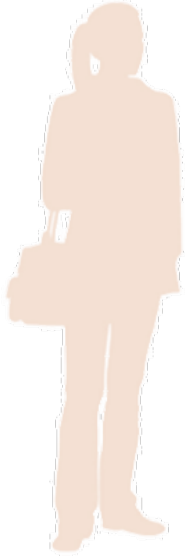

COLOUR: MAGLIN IPE WOOD SEAT WITH STONE WALL BASE



COLOUR: MAGLIN IPE WOOD SEAT WITH STONE WALL BASE

PHASE 1 FURNITURE
DESIGN LINK TO MASTER
PLAN DESIGN SCALE



DESCRIPTION: EXISTING

MATCH EXISTING LIGHT
POLES IN VILLAGE
CORE AREA

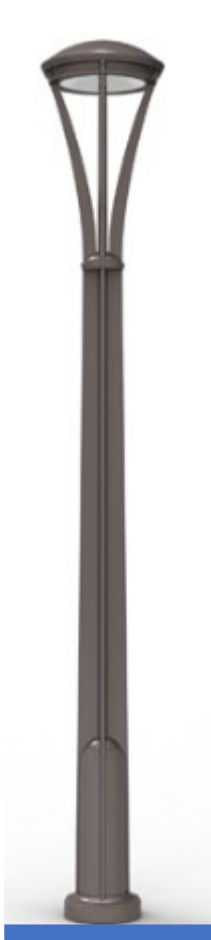

DESCRIPTION: ALCOTT
AREA LIGHT

MANUFACTURER:
LANDSCAPE FORMS

COLOUR: GLOSS BLACK



DESCRIPTION: ASHBEY
AREA LIGHT

MANUFACTURER:
LANDSCAPE FORMS

COLOUR: GLOSS BLACK

**OPTIONAL LIGHTING
UNDER CONSIERATION**

Progress Plan (Core Area, Islington Avenue and En Plain Air Drive)

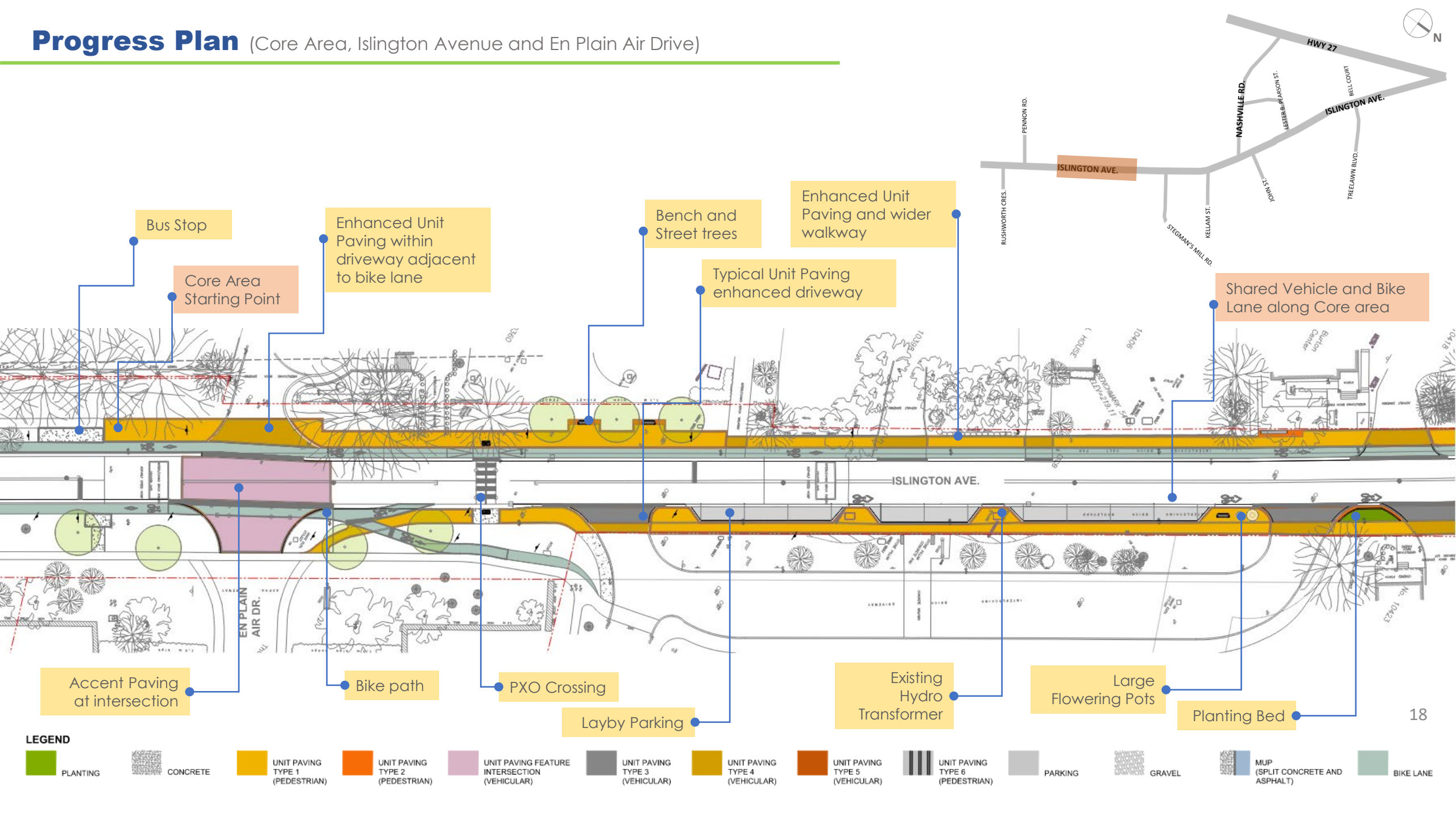

Progress Plan (Core Area, Islington Avenue and Stegman's Mill Road)

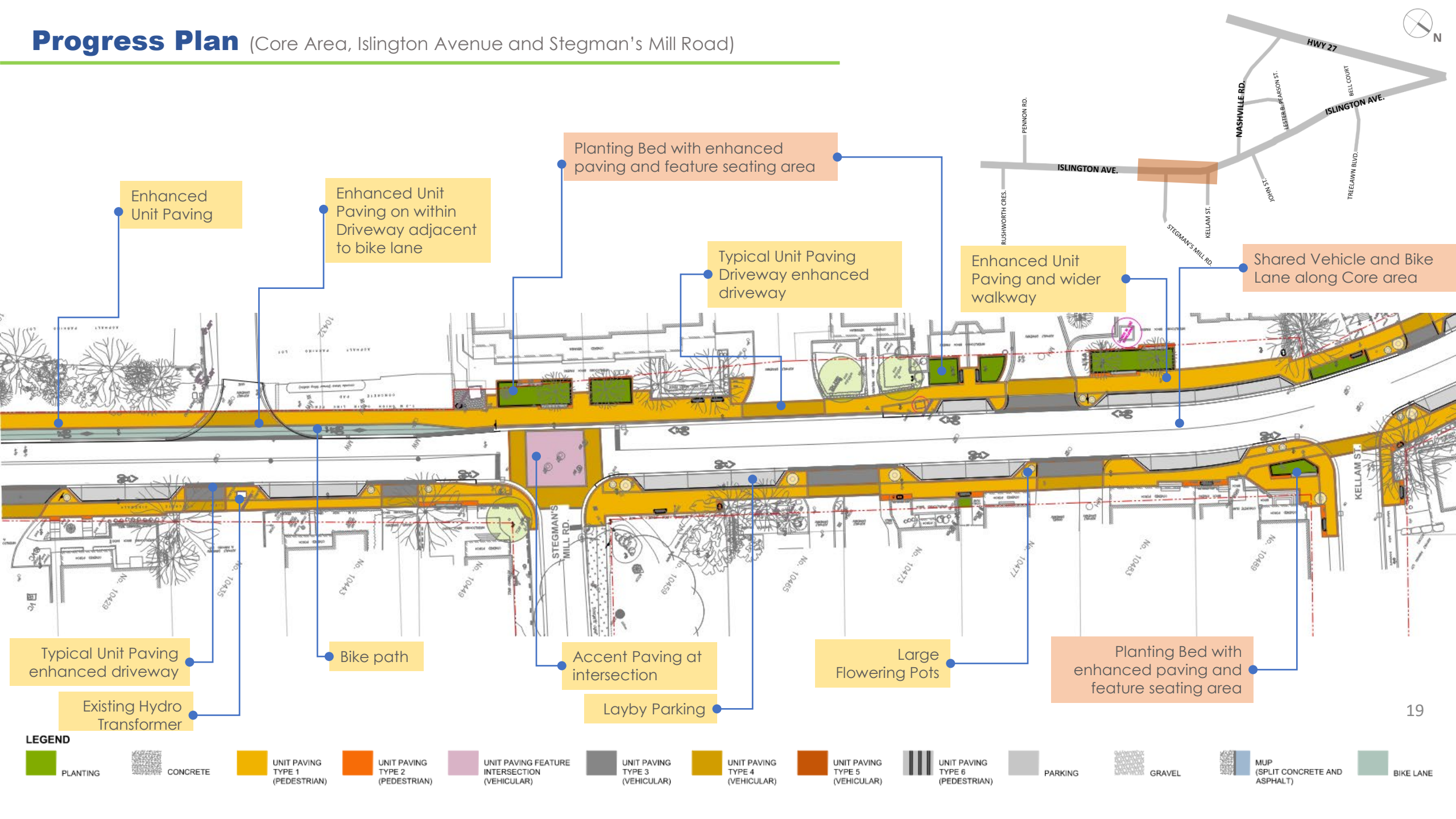

Progress Plan (Core Area, Islington Avenue and Nashville Road)

LEGEND

 PLANTING	 CONCRETE	 UNIT PAVING TYPE 1 (PEDESTRIAN)	 UNIT PAVING TYPE 2 (PEDESTRIAN)	 UNIT PAVING FEATURE INTERSECTION (VEHICULAR)	 UNIT PAVING TYPE 3 (VEHICULAR)	 UNIT PAVING TYPE 4 (VEHICULAR)
 UNIT PAVING TYPE 5 (VEHICULAR)	 UNIT PAVING TYPE 6 (PEDESTRIAN)	 PARKING	 GRAVEL	 MUP (SPLIT CONCRETE AND ASPHALT)	 BIKE LANE	

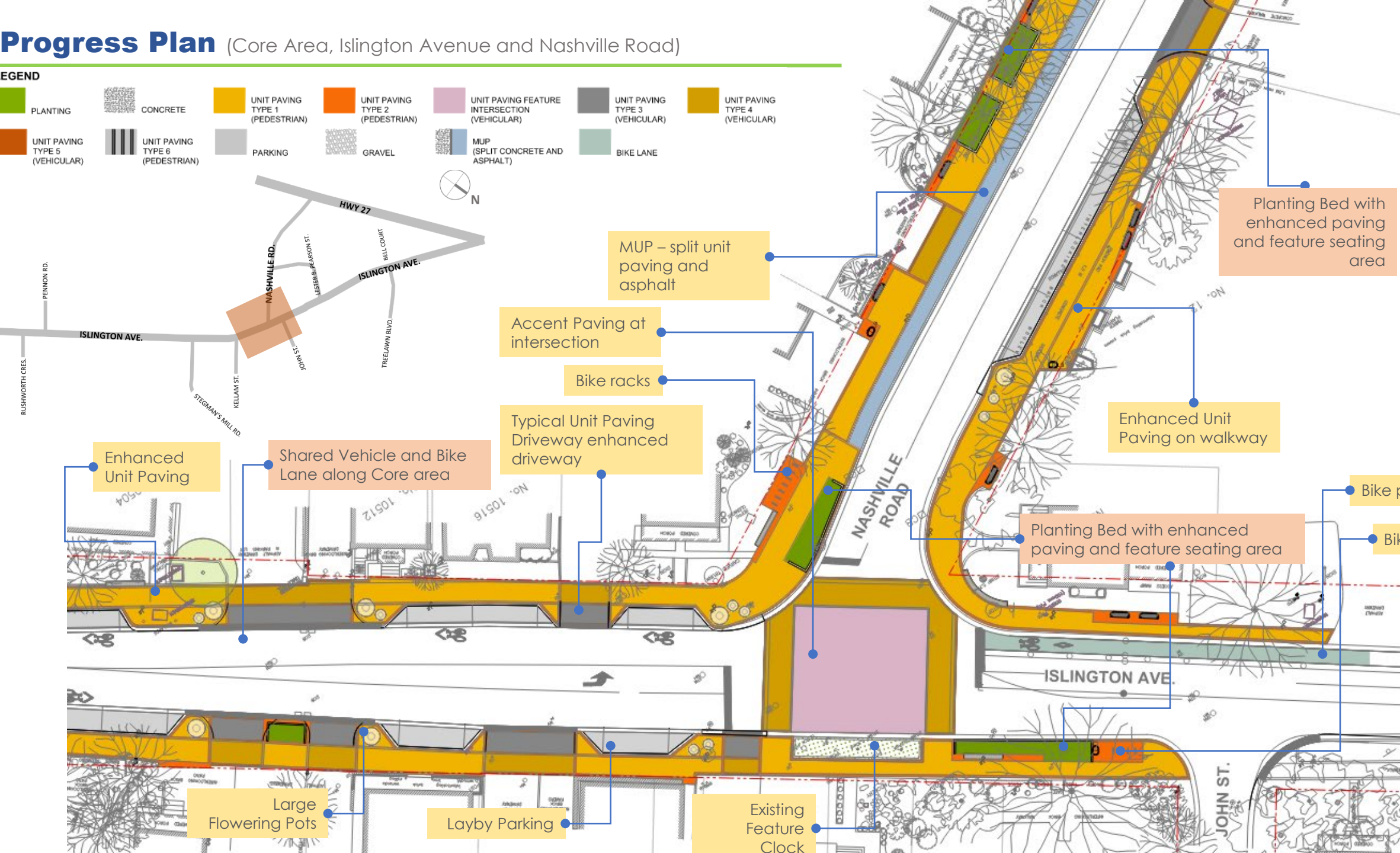

Progress Plan – Core Area Intersections

Approach 1

- Unified material palette
- Single solution for all 3 locations

McMichael Gallery

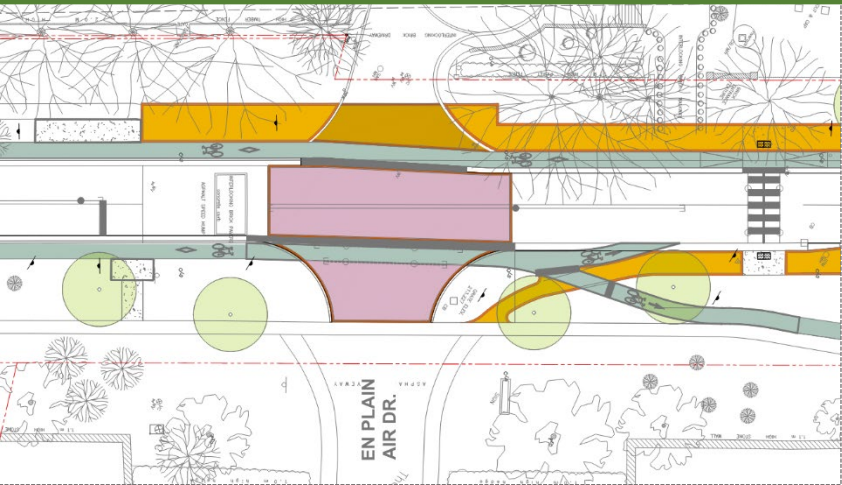

Stegman's Mill Road

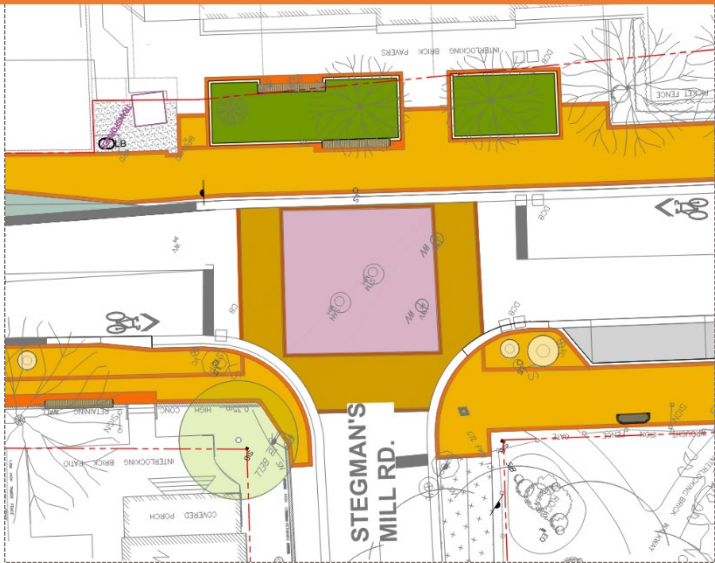

Nashville Road

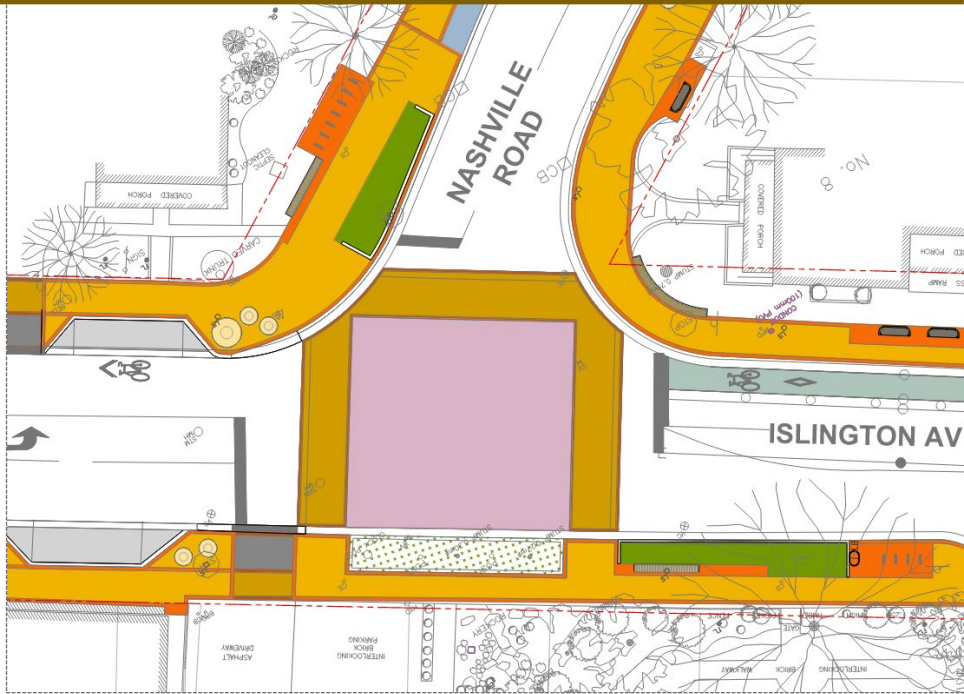

Progress Plan – Core Area Intersections

Potential Approach 2

- Unified material palette with pattern reflecting specific site character

McMichael Gallery

Stegman's Mill Road

Nashville Road

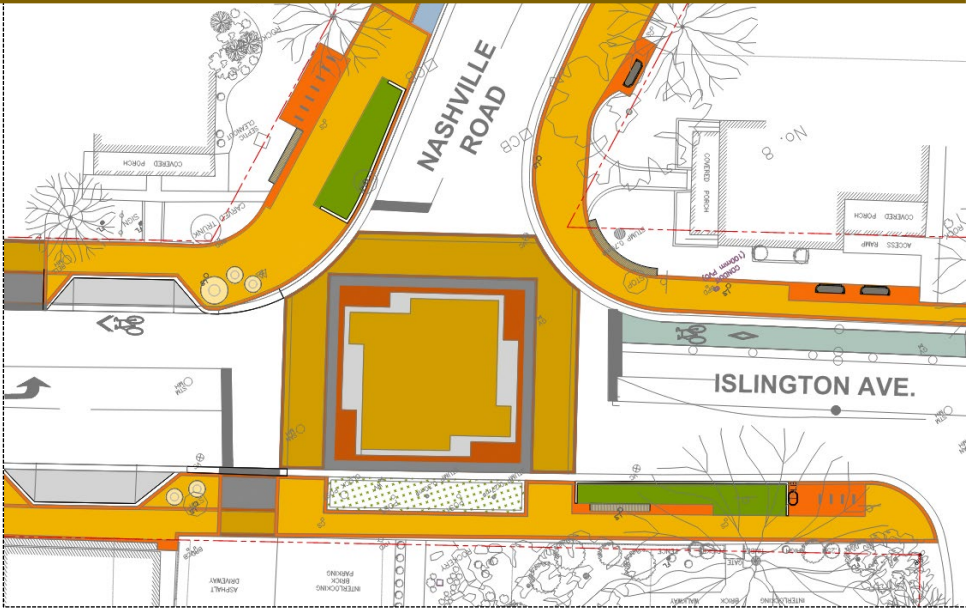
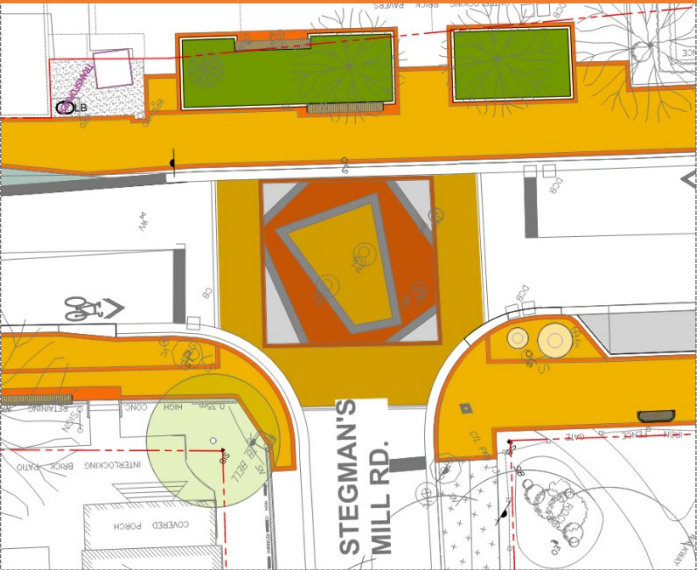
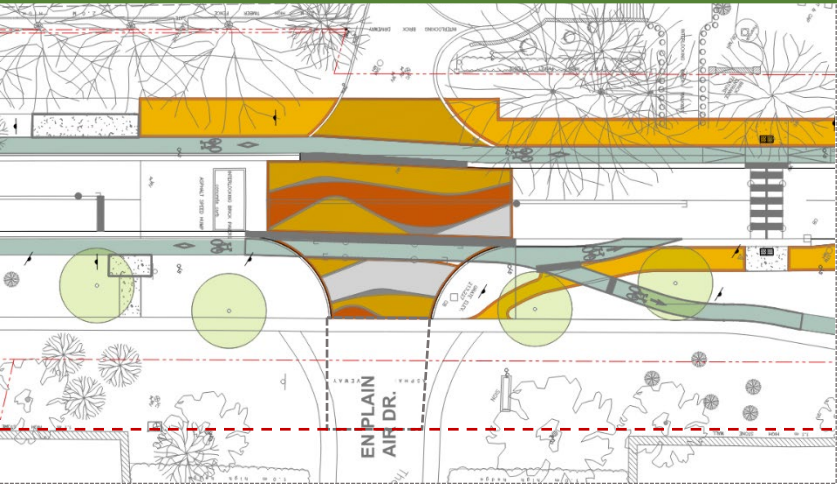

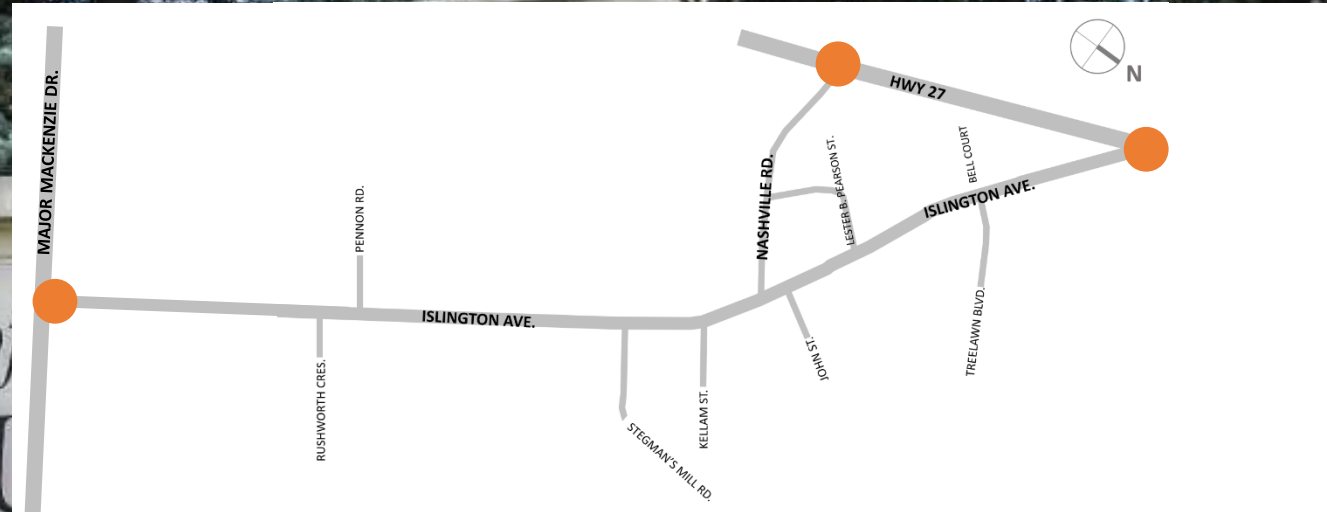

The Objectives

- Preserve unique Village character
- Follow Master Plan Theme selection
- Continue with paving design strategy in Phase 1

Gateways



Art and Nature

✓ Nashville Rd. and Highway 27



Water Power

✓ Islington Ave. and Highway 27



Agricultural

✓ Phase 1: Islington Ave. and Major Mackenzie Dr.

Gateways (Natural Landscape - Art) – at Islington Avenue and Highway 27

Proposed Plan Design



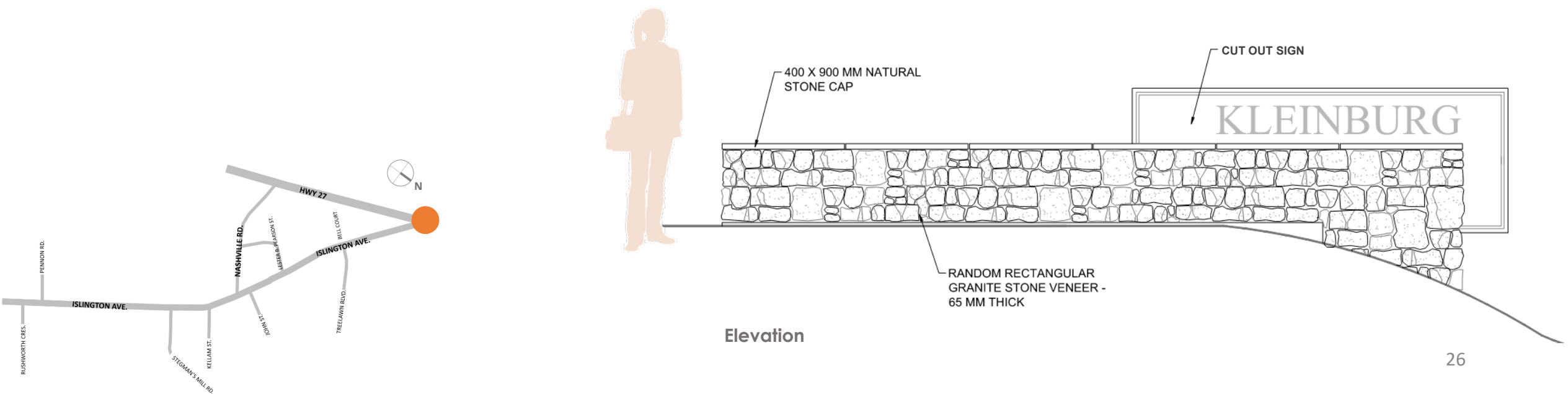

Gateways (Water Power) – at Nashville Road and Highway 27

Proposed Plan Design

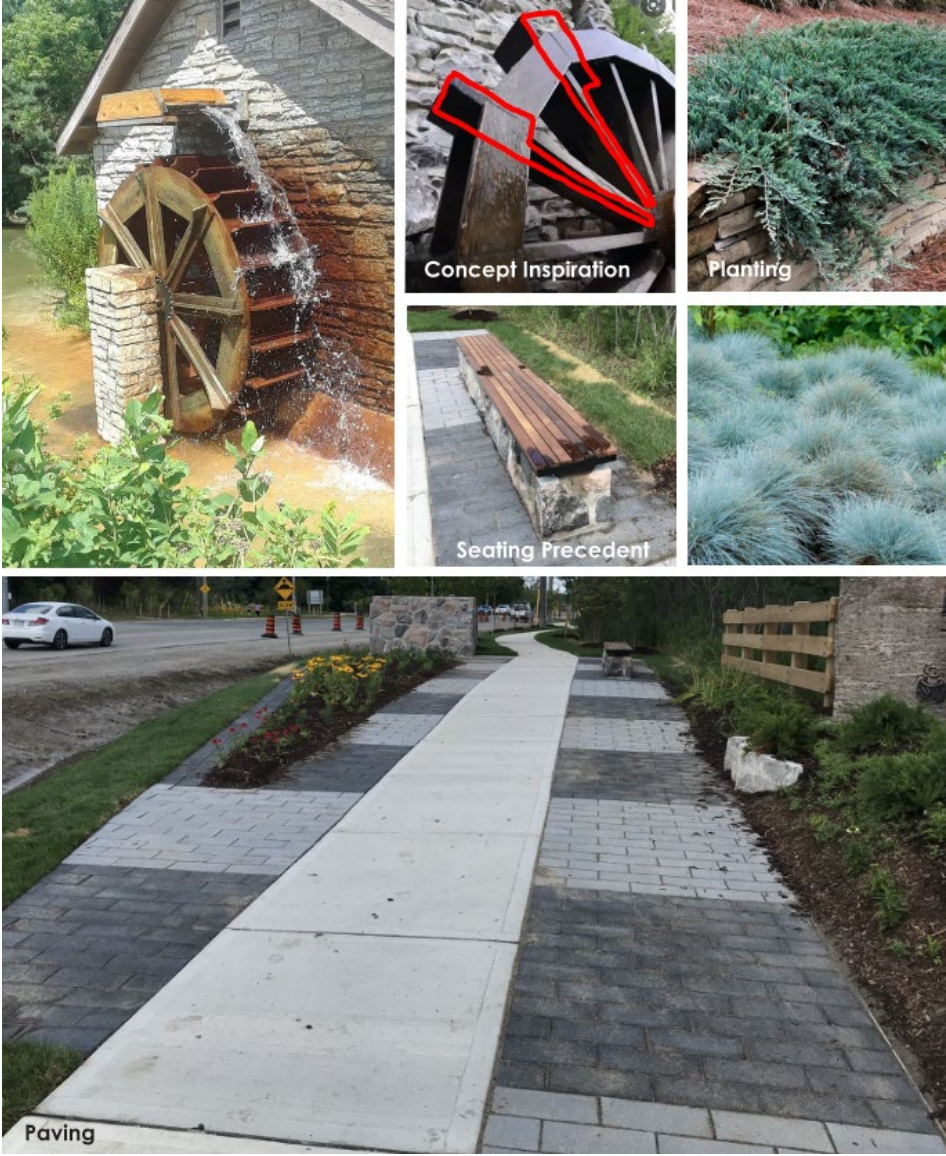



North Gateway

Planting

Paved Sidewalk Pattern

South Gateway

Planting

Paved Sidewalk Pattern

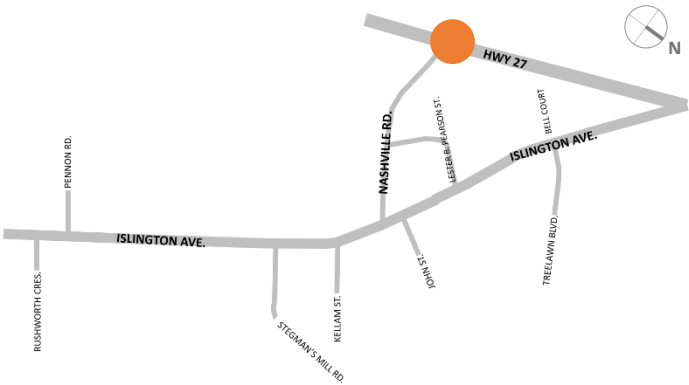

Gateways

(Water Power) – at Nashville Road and Highway 27

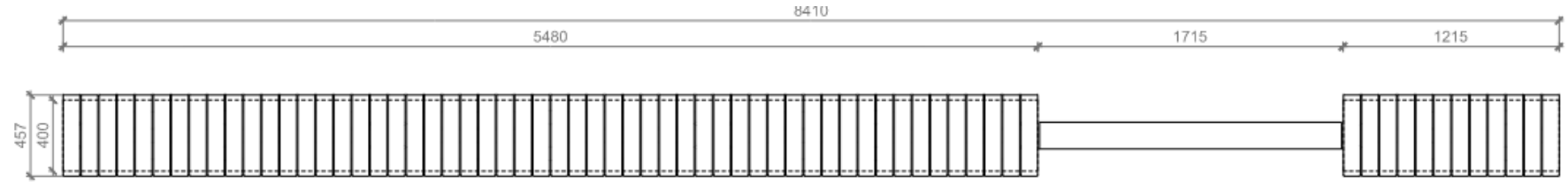

Plan

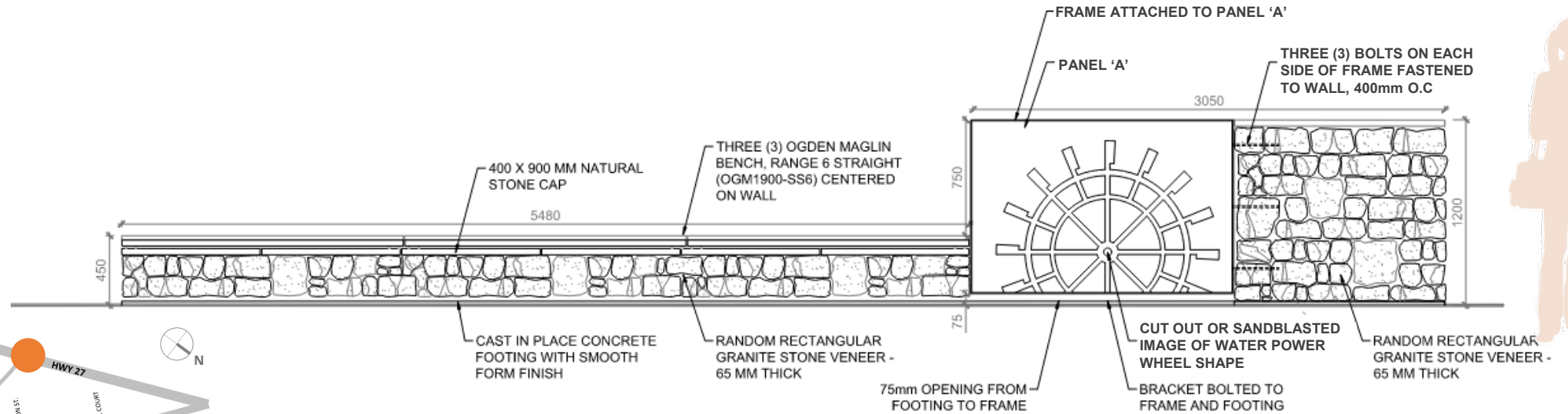

Elevation

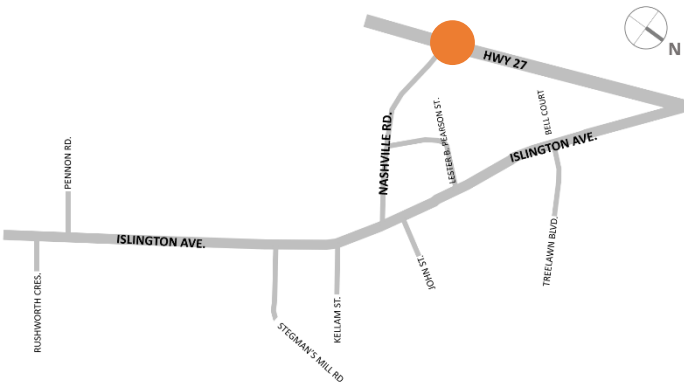

Questions and Open Discussion

