

Communication : C 1  
Older Adult Task Force  
April 25, 2022  
Agenda Item # 1

# Community Hubs and Unionville Seniors Hub and Community Centre Project

PRESENTATION TO VAUGHAN OLDER ADULT TASK FORCE

April 25, 2022



# Presentation Overview

1. Community Hubs Overview, Framework and Research
2. Unionville Seniors Hub and Community Centre Project
3. Lessons Learned
4. Next Steps
5. Questions and Discussion

# Community Hubs Overview, Framework and Research

# Community Hubs Overview

A community hub is a model of service delivery that prioritizes collaboration, program integration and co-location of multiple organizations to create increased access to a variety of services under one roof.

Source: Government of Ontario



## York Region Collaboration at Community Hubs

- The Link Community Hub, Georgina
- Aaniin Community Centre, Markham
- Richmond Hill Youth Hub
- Unionville Seniors Hub and Community Centre
- Health and Active Living Plaza, East Gwillimbury



York Region reception at The Link Community Hub, Georgina

# Community and Health Services (CHS) Community Hubs Framework

The framework supports a consistent approach to assess community hub opportunities and plan community hub development



**Principles**

**Goals**

**Development  
Approach**

# CHS Community Hubs Framework – Guiding Principles



COMMUNITY  
FOCUSED



PARTNERSHIPS AND  
SHARED  
RESPONSIBILITY



CONNECTED SYSTEMS

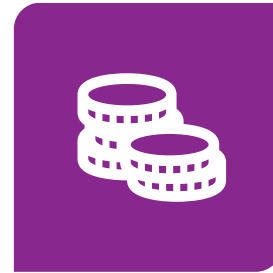

FINANCIALLY  
SUSTAINABLE



VALUE AND EVIDENCE  
BASED

# CHS Community Hubs Framework — Goals

- Co-ordinated planning
- Leverage community infrastructure and public service facilities
- Community focused service delivery
- Innovative service delivery
- Optimize available funding and innovative financing models
- Promote inclusive, healthy, and resilient communities





# CHS Community Hubs Framework — Development Approach



# Program and Service Delivery Model Continuum

	Individual	Cooperation	Coordination	Collaboration	Integration
Service Provision	Independent	Independent with some cooperation	Independent with coordination	Collaborative service provision	Integrated and client-focused
Funding, Communication & Vision	Separate funding and minimal communication	Information sharing and working together on a case-by-case basis	Some joint planning including synchronization of schedules, activities, goals and events	Shared cultures, values, visions, values, actions and willingness to relinquish some autonomy in interest of collective goals	Shared vision, goals, outcomes, funding and consistent policies and procedures



# Community Hub Governance Models

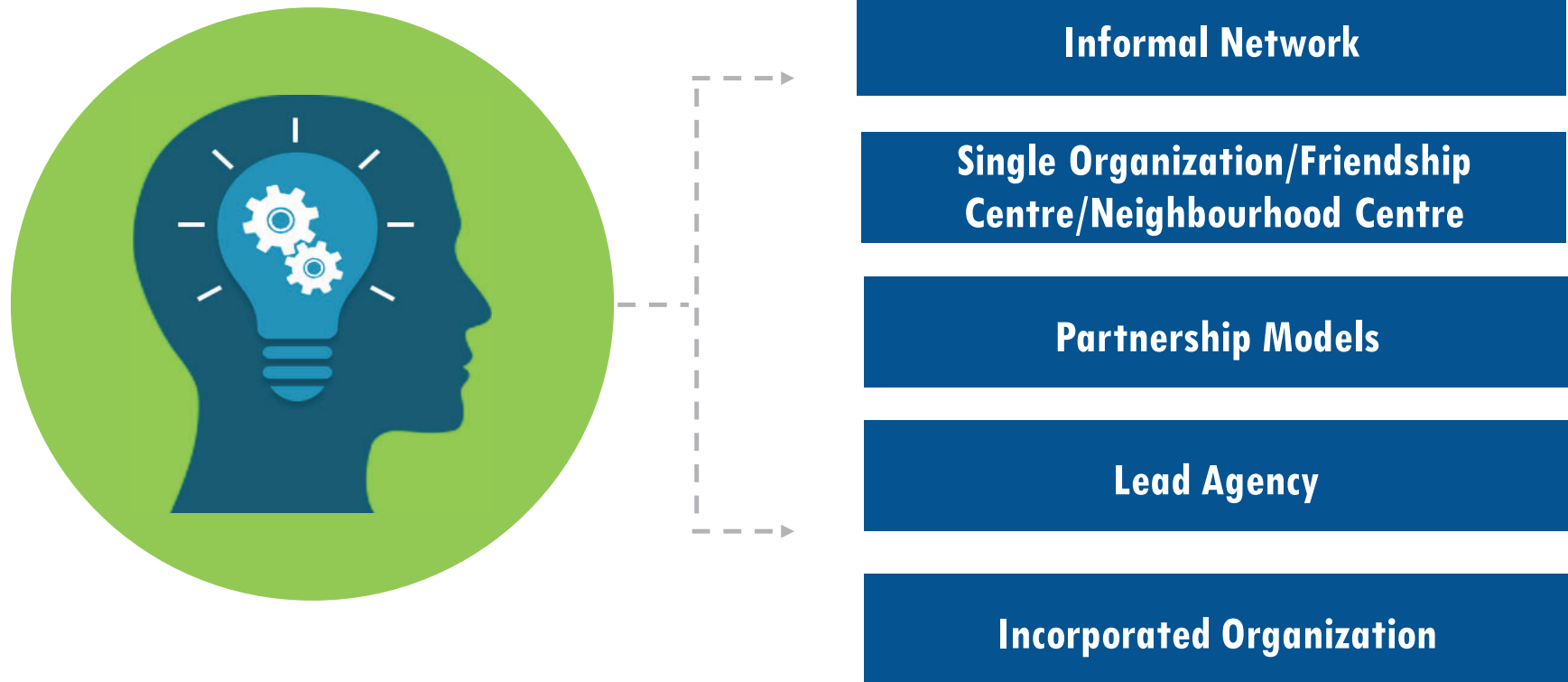

# Unionville Seniors Hub and Community Centre Project

## Why add a seniors hub in Markham?

- York Region's seniors population is growing faster than any other age group
- 31% of York Region's seniors population resides in the City of Markham
- Construction of new Housing York Inc. seniors affordable housing building provided an opportunity for a hub



# Affordable Housing Building in Unionville

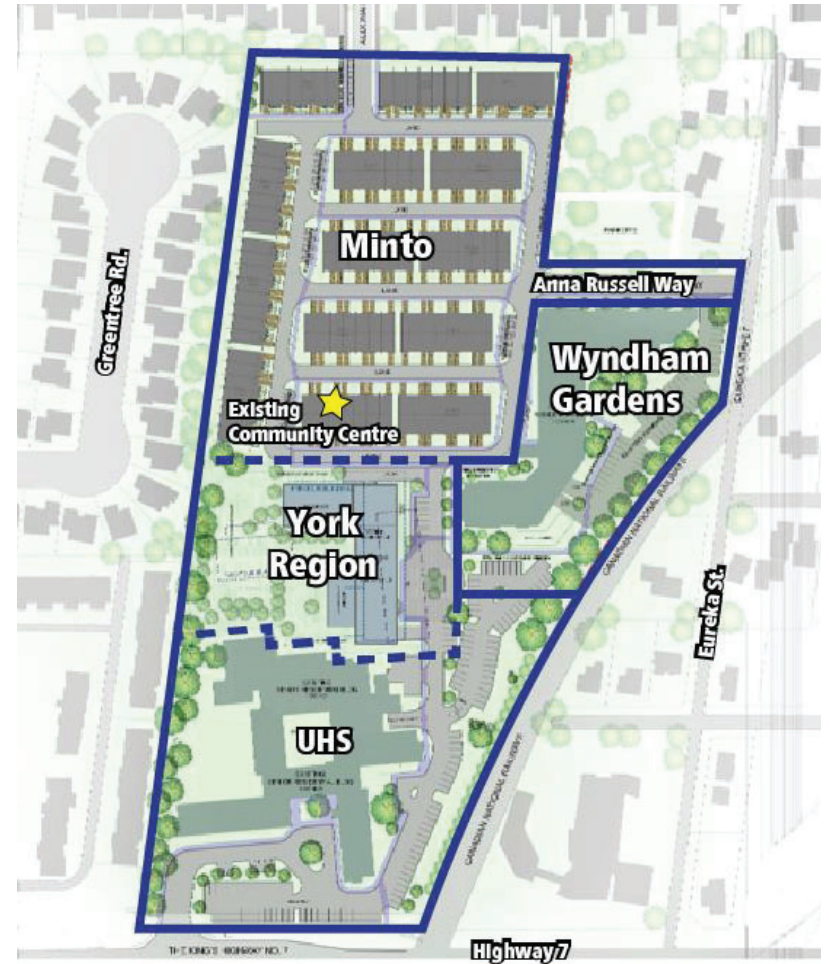



# Hub and Community Centre at Unionville Commons

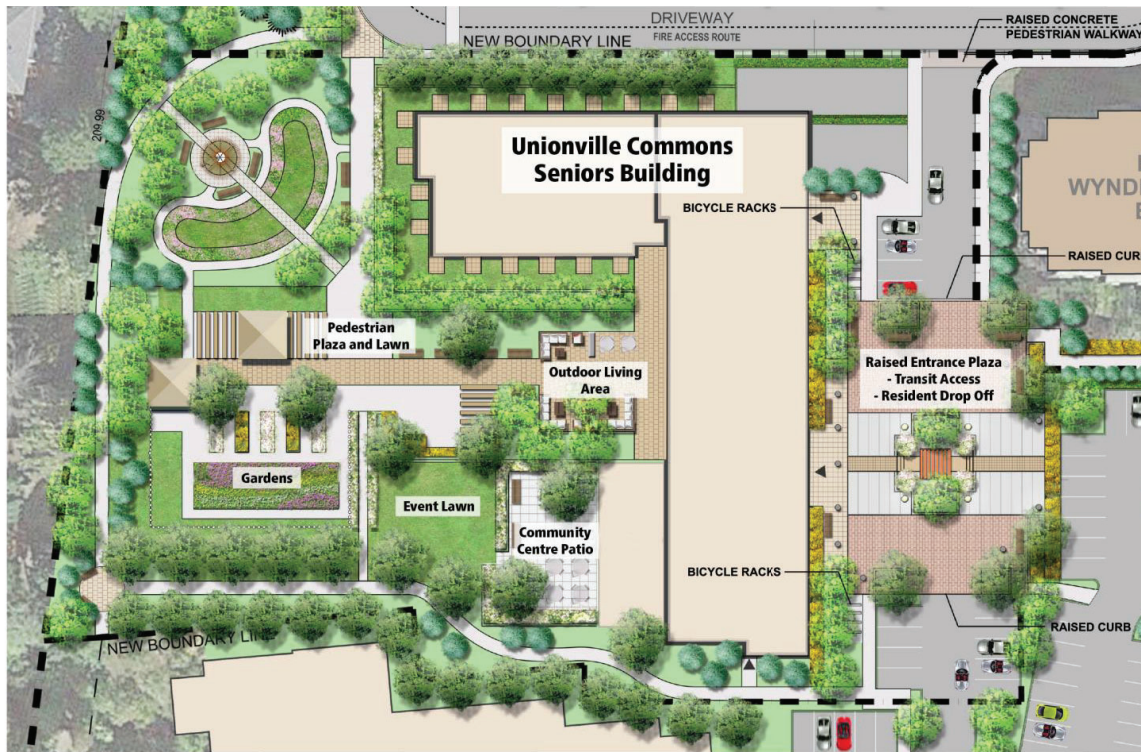

Preliminary Design of Exterior Space

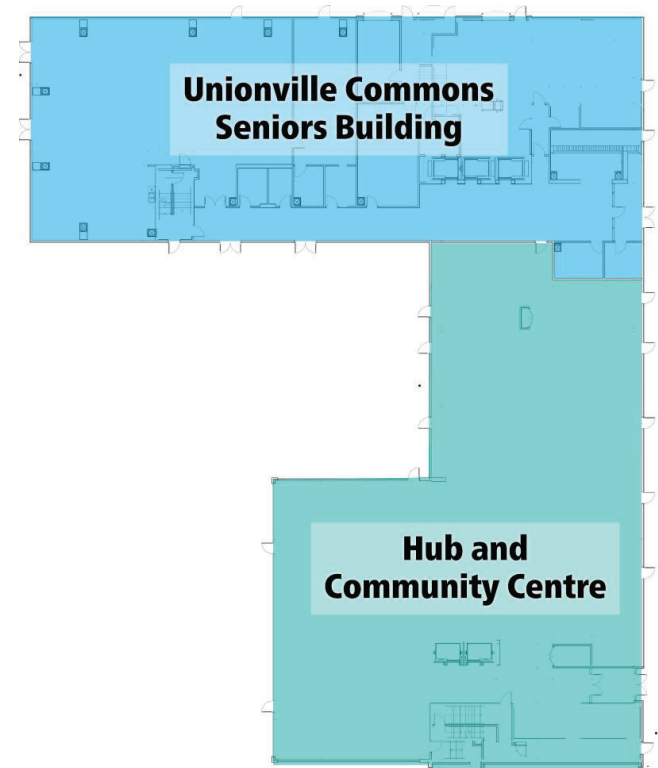

Unionville Commons Ground Floor Plan

# Unionville Seniors Hub and Community Centre Foundational Work





# Unionville Seniors Hub: Needs Assessment Approach



# Public Consultation Approach

- Online and Print Surveys
- Resident Focus Groups
- Community Partner Panels
- Pop-Up Consultation Sessions



# Business Plan

- Stakeholder Roles and Responsibilities
- Hub Operating Models
- How to Operationalize and Sustain the Hub
  - Financial Model Assumptions
  - Financial Projections
  - Interior Fit-Up and Leasehold Improvements
- Lead Agency Selection
- Risk Management
- Recommended Next Steps



# Financial Considerations

- Capital Costs
- Operating Costs
- Revenue Generation
  - Affordable memberships
  - Sub-lease space
  - Room rentals
  - Grants, funding & donations



# Preliminary Lessons Learned

- Alignment with Strategic Directions
- Early Funding & Capital Planning Discussions
- Dedicated Project Resources
- Commitment of Senior Management Sponsor(s) and Working Group
- Engage with Customers and Partners
- Conduct Research and Site Visits
- Internal support required from Finance, Facilities, Procurement, Legal, Capital Delivery
- Develop Risk Mitigation Plan
- Develop Operational Policy



# Next Steps

# Future Milestones



# QUESTIONS AND DISCUSSION



# THANK YOU

**Contact:**

Jennifer Strong, Manager, Integrated Service Delivery  
Planning and Partnerships, Community and Health  
Services, York Region

[Jennifer.Strong@york.ca](mailto:Jennifer.Strong@york.ca)  
1-877-464-9675 ext. 74021

