

OLDER ADULT TASK FORCE – APRIL 25, 2022

COMMUNICATIONS

Distributed April 25, 2022

	<u>Item</u>
C1. Presentation material titled: “ <i>Community Hubs and Unionville Seniors Hub and Community Centre Project</i> ”	1
C2. Presentation material titled: “ <i>Seniors Community Programs</i> ”	2

Disclaimer Respecting External Communications

Communications are posted on the City’s website pursuant to Procedure By-law Number 7-2011. The City of Vaughan is not responsible for the validity or accuracy of any facts and/or opinions contained in external Communications listed on printed agendas and/or agendas posted on the City’s website.

Please note there may be further Communications.

Communication : C 1
Older Adult Task Force
April 25, 2022
Agenda Item # 1

Community Hubs and Unionville Seniors Hub and Community Centre Project

PRESENTATION TO VAUGHAN OLDER ADULT TASK FORCE

April 25, 2022



Presentation Overview

1. Community Hubs Overview, Framework and Research
2. Unionville Seniors Hub and Community Centre Project
3. Lessons Learned
4. Next Steps
5. Questions and Discussion



Community Hubs Overview, Framework and Research

Community Hubs Overview

A community hub is a model of service delivery that prioritizes collaboration, program integration and co-location of multiple organizations to create increased access to a variety of services under one roof.

Source: Government of Ontario



York Region Collaboration at Community Hubs

- The Link Community Hub, Georgina
- Aaniin Community Centre, Markham
- Richmond Hill Youth Hub
- Unionville Seniors Hub and Community Centre
- Health and Active Living Plaza, East Gwillimbury



York Region reception at The Link Community Hub, Georgina

Community and Health Services (CHS) Community Hubs Framework

The framework supports a consistent approach to assess community hub opportunities and plan community hub development



Principles

Goals

**Development
Approach**

CHS Community Hubs Framework – Guiding Principles

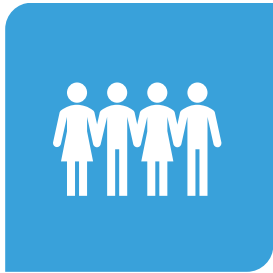

COMMUNITY
FOCUSED



PARTNERSHIPS AND
SHARED
RESPONSIBILITY



CONNECTED SYSTEMS

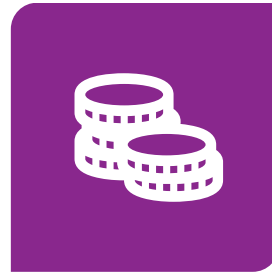

FINANCIALLY
SUSTAINABLE



VALUE AND EVIDENCE
BASED

CHS Community Hubs Framework — Goals

- Co-ordinated planning
- Leverage community infrastructure and public service facilities
- Community focused service delivery
- Innovative service delivery
- Optimize available funding and innovative financing models
- Promote inclusive, healthy, and resilient communities



CHS Community Hubs Framework — Development Approach



Program and Service Delivery Model Continuum

	Individual	Cooperation	Coordination	Collaboration	Integration
Service Provision	Independent	Independent with some cooperation	Independent with coordination	Collaborative service provision	Integrated and client-focused
Funding, Communication & Vision	Separate funding and minimal communication	Information sharing and working together on a case-by-case basis	Some joint planning including synchronization of schedules, activities, goals and events	Shared cultures, values, visions, values, actions and willingness to relinquish some autonomy in interest of collective goals	Shared vision, goals, outcomes, funding and consistent policies and procedures



Community Hub Governance Models

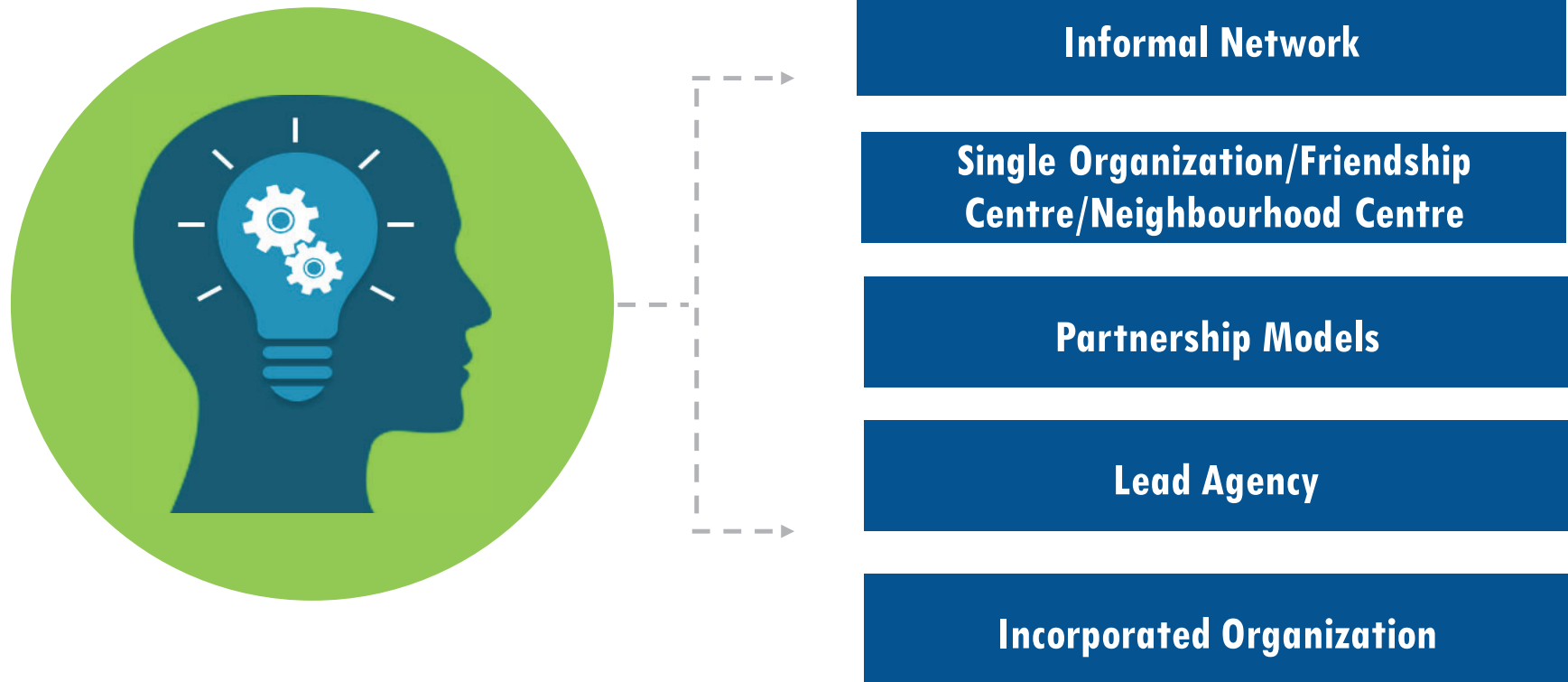

Unionville Seniors Hub and Community Centre Project

Why add a seniors hub in Markham?

- York Region's seniors population is growing faster than any other age group
- 31% of York Region's seniors population resides in the City of Markham
- Construction of new Housing York Inc. seniors affordable housing building provided an opportunity for a hub



Affordable Housing Building in Unionville



Hub and Community Centre at Unionville Commons

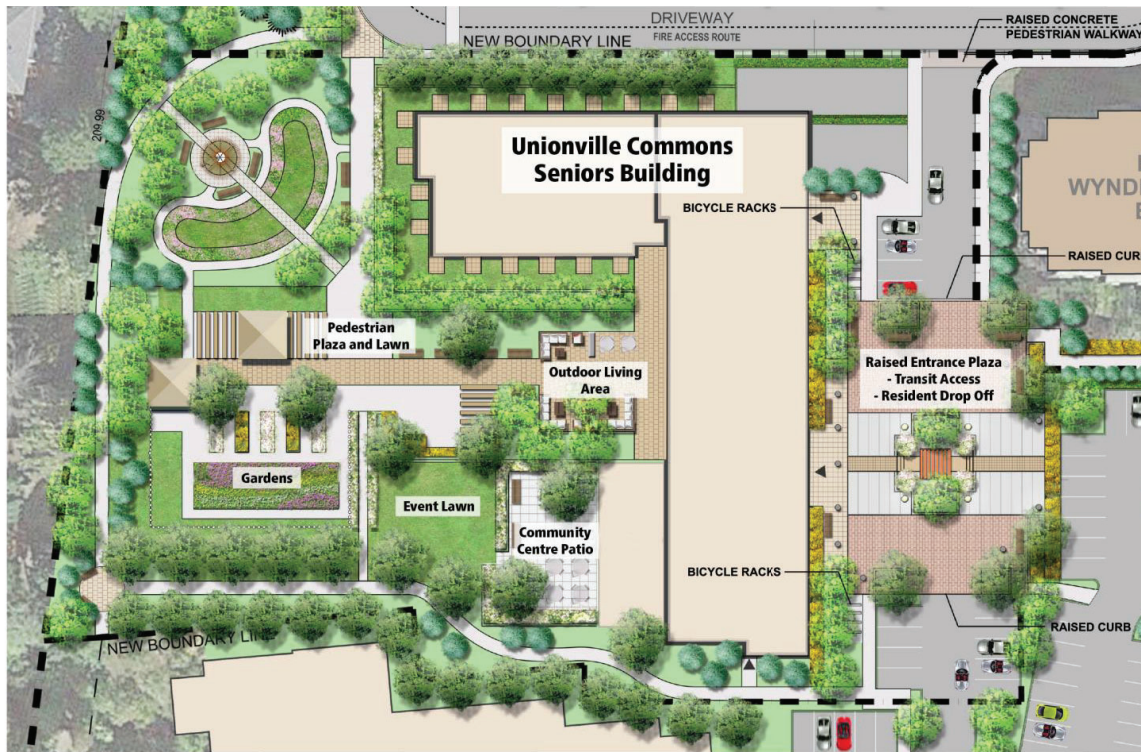

Preliminary Design of Exterior Space

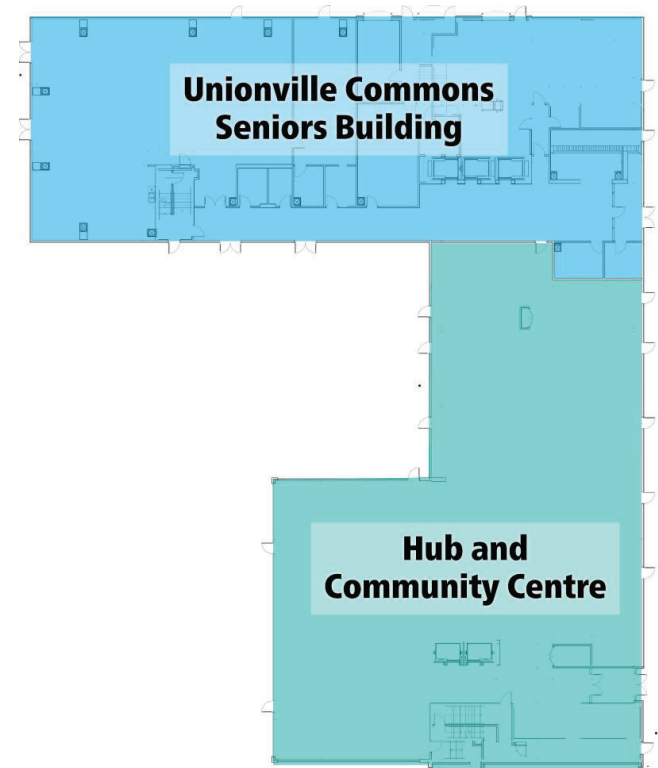

Unionville Commons Ground Floor Plan

Unionville Seniors Hub and Community Centre Foundational Work



Unionville Seniors Hub: Needs Assessment Approach



Public Consultation Approach

- Online and Print Surveys
- Resident Focus Groups
- Community Partner Panels
- Pop-Up Consultation Sessions



Business Plan

- Stakeholder Roles and Responsibilities
- Hub Operating Models
- How to Operationalize and Sustain the Hub
 - Financial Model Assumptions
 - Financial Projections
 - Interior Fit-Up and Leasehold Improvements
- Lead Agency Selection
- Risk Management
- Recommended Next Steps



Financial Considerations

- Capital Costs
- Operating Costs
- Revenue Generation
 - Affordable memberships
 - Sub-lease space
 - Room rentals
 - Grants, funding & donations



Preliminary Lessons Learned

- Alignment with Strategic Directions
- Early Funding & Capital Planning Discussions
- Dedicated Project Resources
- Commitment of Senior Management Sponsor(s) and Working Group
- Engage with Customers and Partners
- Conduct Research and Site Visits
- Internal support required from Finance, Facilities, Procurement, Legal, Capital Delivery
- Develop Risk Mitigation Plan
- Develop Operational Policy



Next Steps

Future Milestones



QUESTIONS AND DISCUSSION

THANK YOU

Contact:

Jennifer Strong, Manager, Integrated Service Delivery
Planning and Partnerships, Community and Health
Services, York Region

Jennifer.Strong@york.ca
1-877-464-9675 ext. 74021



SENIORS COMMUNITY PROGRAMS

SENIORS COMMUNITY PROGRAMS

SENIORS COMMUNITY PROGRAMS -SCP

Regional Municipality of York

- Adult Day Program (ADP)
- Psychogeriatric Resource Consultants (PRC)
- Vulnerable Seniors Network - Pilot

ADULT DAY PROGRAMS

ADULT DAY PROGRAMS

- The Regional Municipality of York offers Adult Day Programs (ADPs) in Maple and Keswick that provide supervised programming in a group setting for eligible residents of York Region to assist in achieving their maximum level of functioning, prevent premature and inappropriate institutionalization and provide respite for caregivers. Components of the program include Social, Emotional, Spiritual, Intellectual and Physical activities and meals
- The Adult Day Programs are for York Region residents who are older adults with Dementia and other cognitive impairments, acquired brain injuries, aphasia or other communication disorders, as well as people with disabilities and frailty.

ADULT DAY PROGRAMS — ELIGIBILITY AND REFERRAL

Eligibility Criteria

- Adult Day Programs are for York Region residents who are 18 years and older with Dementia, other cognitive impairments, acquired brain injuries, aphasia or other communication disorders, people with disabilities and for the frail elderly.

Referral Process

- Home and Community Care Support Services (HCCSS) staff are responsible for assessing and referring potential individuals to ADP. If a referral is send to the Adult Day Program directly, it can be forwarded to the Home and Community Care Support Services.
- Once the referral is received from HCCSS, the ADP Supervisor assesses and determines whether the referral meets our admission criteria

ACTIVITIES AT THE ADULT DAY PROGRAM

Physical, Social, Emotional, Intellectual, Spiritual



ADP- PARTNERSHIPS AND COLLABORATION

- March of Dimes
- Mackenzie Health
- Alzheimer Society of York Region
- Internal Resources- PRC, CISS (Client Intervention and Support Service)
- St. Andrew's College- Intergenerational Programming (on hold during pandemic)
- Keswick Public School- Intergenerational Programming (on hold during pandemic)
- Others

PSYCHOGERIATRIC RESOURCE CONSULTANTS

Psychogeriatric Resource Consultant (PRC)

PROGRAM INFORMATION

- PRCs build and enhance capacity of staff in long-term care homes and community support agencies serving clients with responsive behaviours related to dementia, mental illness and other psychogeriatric related diagnoses.
- PRCs provide in-person and virtual support during the pandemic (hybrid model)

Psychogeriatric Resource Consultant (PRC)

ELIGIBILITY AND REFERRAL

- PRCs support Ministry funded LTC Homes and Community Organizations in York Region
- PRCs are assigned to specific LTC Homes and community support agencies in York Region to ensure consistency and continuity
- PRC will be assigned to support new LTC Homes or Community Organizations as they open and make direct contact to initiate ongoing service.

Psychogeriatric Resource Consultant (PRC) PROGRAM SERVICES

- Staff Education
- Case Consultation
- Sharing Resources and Network Building

Psychogeriatric Resource Consultant (PRC)

VIRTUAL SIMULATION EXPERIENCE

- The Virtual Simulation Experience provides adult learning in an interactive, experiential environment with the desired outcome of increased empathy.
- Simulation is an innovative, experiential method of building empathy (CLRI, 2018). The participants are immersed into a scenario that aims to enhance understanding of life with cognitive impairment and age-related frailty.
- The virtual simulation experience was made possible through an Ontario Ministry of Seniors and Accessibility Grant.



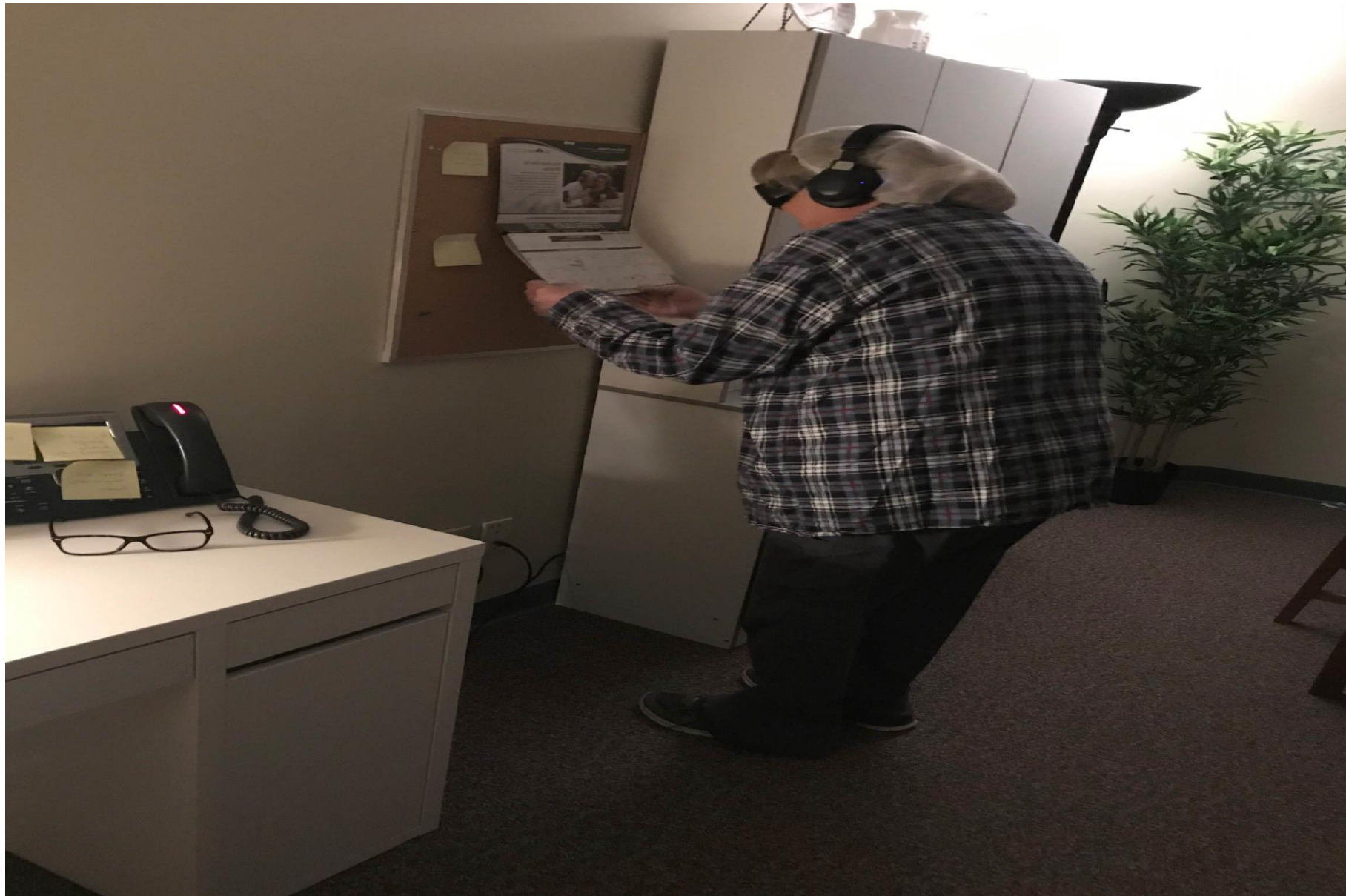



THANK YOU

